

**VPA** Variable Pitch Connector

The VPA may be sloped in the field, offering a versatile solution for attaching rafters to the top plate. It will adjust to accommodate slopes between 3:12 and 12:12, making it a complement to the versatile LSSU. This connector eliminates the need for notched rafters, beveled top plates and toe nailing.

**MATERIAL:** 18 gauge

**FINISH:** Galvanized

**INSTALLATION:** • Use all specified fasteners. See General Notes.

**CODES:** See page 12 for Code Reference Key Chart.

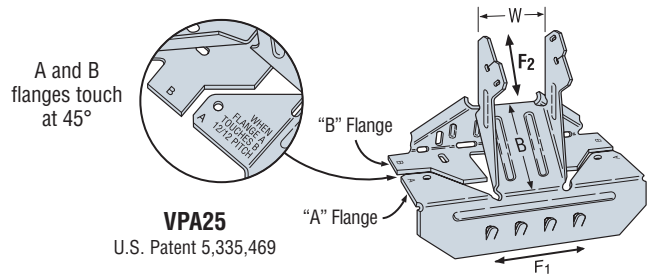

Actual Joist Width	Model No.	W	B	Fasteners		Allowable Loads								Code Ref.
				Carrying Member	Carried Member	Uplift		Download		Lateral				
						DF/SP Species	SPF Species			DF/SP Species (160)		SPF/HF Species (160)		
						(160)	(160)	DF/SP	SPF	F <sub>1</sub>	F <sub>2</sub>	F <sub>1</sub>	F <sub>2</sub>	
1½	VPA2	1⅞	2	8-10d	2-10dx1½	295	250	1050	870	375	250	325	250	18, F7
1¾	VPA25	1⅞	2	8-10d	2-10dx1½	295	250	1050	870	375	250	325	250	
2	VPA2.06	2⅞	2	9-10d	2-10dx1½	295	250	1230	1020	375	250	325	250	170
2⅞	VPA2.1	2⅞	2	9-10d	2-10dx1½	295	250	1230	1020	375	250	325	250	
2¼ - 2⅝	VPA35	2⅞	2	9-10d	2-10dx1½	295	250	1230	1020	375	250	325	250	18, F7
2½ - 2⅞	VPA3	2⅞	2	9-10d	2-10dx1½	295	250	1230	1020	375	250	325	250	
3½	VPA4	3⅞	2	11-10d	2-10dx1½	295	250	1230	1020	375	250	325	250	

- Uplift loads include a 60% increase for wind or earthquake loading with no further increase allowed; reduce where other loads govern.
- Loads may not be increased for short-term loading.
- NAILS:** 10d = 0.148" dia. x 3" long, 10dx1½ = 0.148" dia. x 1½" long. See page 16-17 for other nail sizes and information.

**VPA INSTALLATION SEQUENCE**

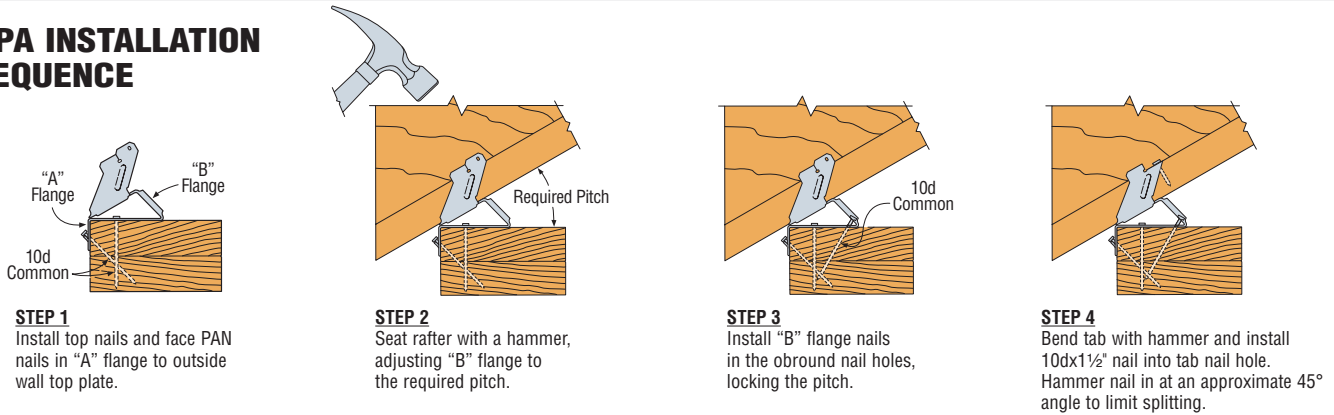

C-2009 © 2008 SIMPSON STRONG-TIE COMPANY INC. PRINTED 12/08

Engineered Wood & Structural Composite Lumber Connectors

**HCP** Hip Corner Plates

For complementary ridge connection, see page 108

The HCP connects a rafter or joist to double top plates at a 45° angle.

**MATERIAL:** 18 gauge

**FINISH:** Galvanized

**INSTALLATION:** • Use all specified fasteners. See General Notes.

- Attach HCP to double top plates; birdsmouth not required for table loads.
- Install rafter and complete nailing. Rafter may be sloped to 45°.

**CODES:** See page 12 for Code Reference Key Chart.

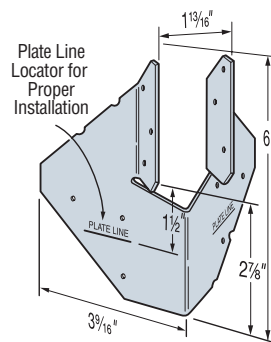

**HCP1.81**  
U.S. Patent 5,380,115

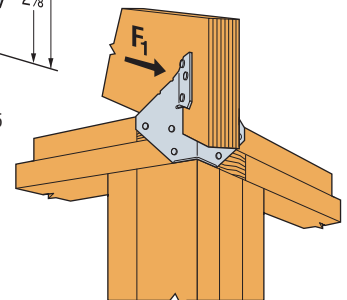

Typical HCP Installation

Member Size	Model No.	Fasteners		DF/SP Allowable Loads		SPF/HF Allowable Loads		Code Ref.
		To Rafters	To Plates	(160)		(160)		
				Uplift	F <sub>1</sub>	Uplift	F <sub>1</sub>	
1¾	HCP1.81	6-10dx1½	6-10dx1½	645	300	555	260	18, F7

- Loads include a 60% increase for wind or earthquake loading with no further increase allowed; reduce where other loads govern.
- The HCP can be installed on the inside and the outside of the wall with a flat bottom chord truss and achieve twice the load capacity.
- NAILS:** 10dx1½ = 0.148" dia. x 1½" long. See page 16-17 for other nail sizes and information.