





evoQ™ 5000 SERIES SPEAKERS

PRODUCT	PART #	DESCRIPTION	DIMENSIONS
In-Ceiling Speaker 	HT5650 6.5"	Optimized for the demands of home theater sound, the 5000 Series In-Ceiling Speaker features poly woofers for high power handling and premium sound quality. It mounts in the ceiling for a clean, seamless installation.	9" dia. 3.29" D
	HT5800 8"		10.9" dia. 3.65" D

PRODUCT	PART #	DESCRIPTION	DIMENSIONS
In-Wall Speaker 	364662-01 6.5"	Featuring moisture-resistant UFLC tweeters to produce smooth frequency response and excellent sound quality, the 5000 series In-Wall Speaker is a premium addition to any home theater system. It also includes foam gaskets to minimize vibration and provide an air-tight seal.	12.3" H x 9" W 3.16" D
	HT5801 8"		14.25" H x 10" W 3.65" D

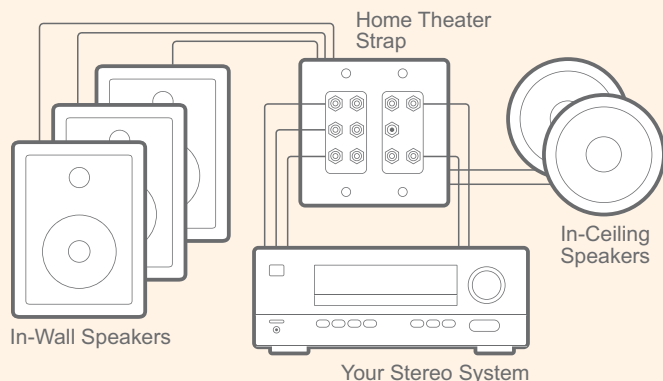
PRODUCT	PART #	DESCRIPTION	DIMENSIONS
Subwoofer 	HT5104 10"	Designed specifically for home theater and multi-room audio applications, this sub-woofer includes a 10" polycone in a sealed enclosure with a 150 RMS power amplifier. It also has choices of line and high-level inputs and high-level outputs.	16" H x 14.5" W x 15.25" D

WIRING DIAGRAM

INSTALLATION AT-A-GLANCE
evoQ SPEAKERS

1. Cut speaker mounting holes to the left, right, and above the entertainment center.
2. Cut two mounting holes in the ceiling along the center line.
3. Install the speakers in the mounting holes.
4. Install the home theater strap behind the entertainment center.
5. Run speaker wire from the strap to each speaker and connect to the speakers.
6. Connect the speakers and the stereo system to the home theater strap.