

UNLOCK A WORLD OF DESIGN POSSIBILITIES

FrameRite Building Systems represent a new era in commercial and residential construction. These are products whose very design reduces labor and emphasizes flexibility, thereby freeing architects, engineers, contractors and builders from the constraints normally associated with traditional building materials.

The key to FrameRite Building Systems lies in its core components: JoistRite, StudRite and TrussRite. Each product can be integrated with all building materials to create floors, walls, roofs and other structures. When employed as a system, these products can be used to create an entire building. FrameRite Building System's 100% steel components are lightweight and extremely durable, and offer a sound alternative to wood, thereby reducing draw on the environment.

When combined with DesignRite, MarinoWARE's engineering and design service, FrameRite Building Systems form a complete building solution that allows for virtually unlimited construction possibilities.

DesignRite™

- DesignRite services are available to prepare engineering for FrameRite Building Systems structures as well as for buildings created with conventional cold formed steel products.
- Professionally engineered shop drawings allow for a precise layout of the entire structure – an invaluable field item for contractors and builders – and can help facilitate the design approval process.
- Construction professionals can receive a complete list of FrameRite Building Systems materials for a given job – something the competition does not offer – eliminating repeat trips to the supply yard.

TrussRite™

- Created from the AmKey System.
- Exceptional strength to weight ratio.
- Superior dimensional stability.
- Requires less bracing than other truss products.
- Complete trusses can be delivered to a jobsite, or individual truss components can be manufactured according to job needs.
- UL classified assemblies.

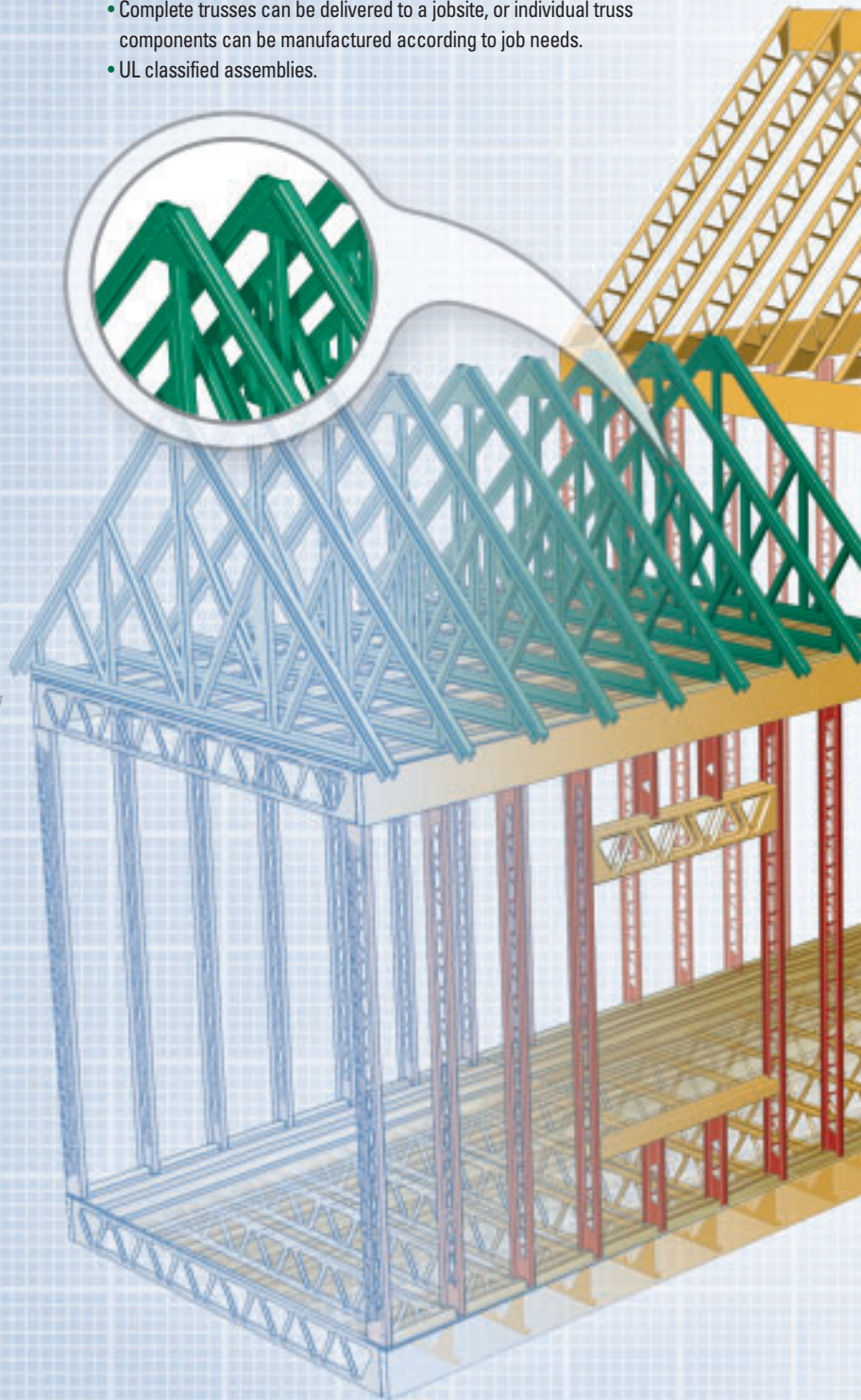

- 
- JoistRite products are extremely versatile and can be combined with conventional accessories to form a traditional roof.

StudRite™

- Unique triangular cutouts within the product design allow plumbing, heating, electrical and other conduits to pass through easily – saving time and labor.
- Lightweight and durable, the product can be used as bearing walls in low-rise construction and as non-bearing walls in high-rise construction.
- Steel members are straight and true, equating to cleaner, straighter lines within the structure.
- UL classified assemblies.

JoistRite™

- Specially designed knockouts and embossments in the structure itself allow for added strength and easy trade pass-through.
- Clear spans over 38'-0" can be achieved – reducing the structure's dependency on bearing walls and making most interior walls moveable.
- Superior dimensional stability means no warping, shrinking or cracking – thus eliminating squeaky floors.
- Sections are cut to order, minimizing the need for on-site adjustments.
- Compatible with existing metal-to-wood and metal-to-metal framing techniques.
- Superior thermal, fire, and acoustical properties.
- UL classified assemblies..