

DIPS Fittings MJ Adapter Kit (Mechanical Joint Adapter)

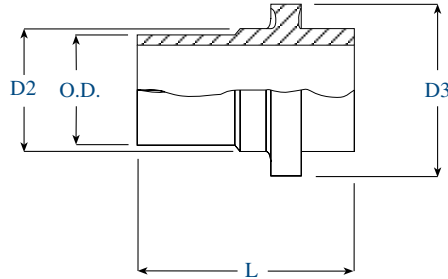

The MJ Adapter Kit consist of: HDPE MJ Adapter with metal insert, Metal Gland, Gasket, and attachment Bolts and Nuts.



DIPS Fittings MJ Adapter (Mechanical Joint Adapter)

Nominal Size(in)	Pipe OD(in)	DR	Part #	Dimensions			Weight (lbs)	Shipping Method
				L(in)	D2(in)	D3(in)		
4	4.8	9	ISMFMJ0409DIPS	8	4.8	6.625	13	FedEx
		11	ISMFMJ0411DIPS	"	"	"	12	"
6	6.9	9	ISMFMJ0609DIPS	9	6.9	8.625	23	FedEx
		11	ISMFMJ0611DIPS	"	"	"	18	"
8	9.05	9	ISMFMJ0809DIPS	11.5	9.05	10.75	36	FedEx
		11	ISMFMJ0811DIPS	"	"	"	35	"
10	11.1	9	ISMFMJ1009DIPS	11.5	11.1	13.2	48	FedEx
		11	ISMFMJ1011DIPS	"	"	"	45	"
12	13.2	9	ISMFMJ1209DIPS	11.5	13.2	15.38	62	FedEx
		11	ISMFMJ1211DIPS	"	"	"	60	"
14	15.3	9	ISMFMJ1409DIPS	12.5	15.3	17.5	87	FedEx
		11	ISMFMJ1411DIPS	"	"	"	84	"
16	17.4	9	ISMFMJ1609DIPS	12.5	17.4	20	120	FedEx
		11	ISMFMJ1611DIPS	"	"	"	115	"
18	19.50	9	ISMFMJ1809DIPS	12.5	19.5	22	132	LTL
		11	ISMFMJ1811DIPS	"	"	"	125	"
20	21.60	11	ISMFMJ2011DIPS	14	21.6	24	165	LTL
24	25.80	11	ISMFMJ2411DIPS	16	25.8	28	225	LTL

\* ALL WEIGHTS INCLUDE GLAND PACKS

DIPS HDPE Fittings

Pressure Rating of MJ Adapters are equal to pipe of same DR.

MJ from 3608 resin:	
DR	Pressure Rating
7	267 psi
9	200 psi
11	128 psi
13.5	128 psi
15.5	110 psi
17	100 psi
21	80 psi
26	64 psi
32.5	51 psi

MJ from 4710 resin:	
DR	Pressure Rating
7	336 psi
9	252 psi
11	202 psi
13.5	161 psi
15.5	139 psi
17	126 psi
21	101 psi
26	81 psi
32.5	64 psi

Note: Size/DR listings shown are commonly requested. Many DR options not listed are available. Please consult an ISCO representative for availability

1-800-345-ISCO

www.isco-pipe.com