

**McElroy PitBull® Fusion Machines**

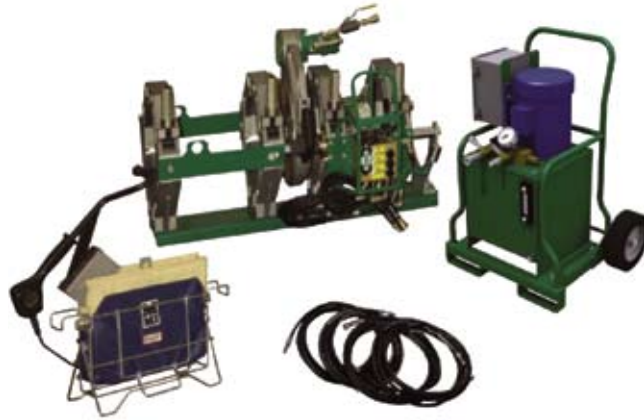

The McElroy Pitbull® Family of compact hydraulic fusion machines butt fuse a range of pipe sizes from 2" IPS - 20" OD (63mm - 500mm) above or in the trench. The robust machines have two fixed and movable clamping jaws resulting in perfect pipe alignment for faster fusions and greater quality. The Pitbull machines have Centerline Guidance and the other features found in all McElroy machines, which result in increased productivity, joint reliability, machine durability and long life with minimal maintenance.

Each of the four different sized machines is modularized for portability and ease of use in the trench. The same hydraulic power unit (HPU) is used with all of the machines affording greater flexibility. Attach an optional McElroy Datalogger™ to record critical joining parameters.

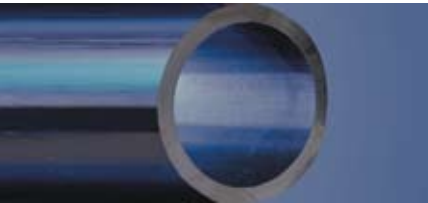

**McElroy  
Fusion  
Equipment**



**PitBull No.28 Fusion Machine**

Fusion Capability for 2" IPS - 8" DIPS pipe (63mm -225mm) Package includes: fusion carriage, facer, 240VAC heater, butt fusion heater adapter set, insulated heater stand, 8" IPS butt fusion inserts, lifting assembly, and operator's manual. HPU sold separately. Combination machines add sidewall capability.

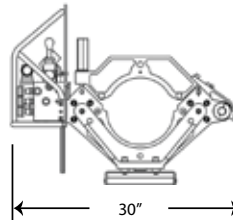
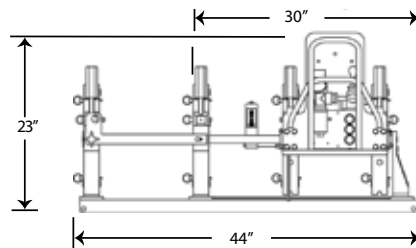

<b>WEIGHT</b>	
Heater	17 lbs. (7.7 Kg)
Carriage	165 lbs. (74.8 Kg)
Facer	38 lbs. (17.2 Kg)



1-800-345-ISCO

www.isco-pipe.com