

DIPS Fittings Fabricated 90° Ell-Five Segment

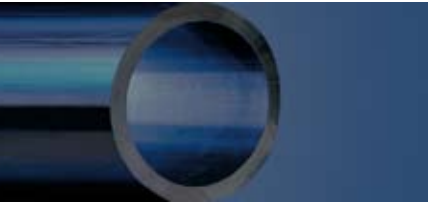

DIPS
HDPE
Fittings

Pressure Rating is based on miter angle, pipe DR (Wall thickness), and resin properties.

Ratings based on 3608 resin/11.25 angle:	
DR	Pressure Rating
7	219 psi
9	160 psi
11	128 psi
13.5	100 psi
15.5	82 psi
17	73 psi
21	57 psi
26	44 psi
32.5	34 psi

Ratings based on 4710 resin/11.25 angle:	
DR	Pressure Rating
7	274 psi
9	202 psi
11	161 psi
13.5	126 psi
15.5	103 psi
17	92 psi
21	72 psi
26	55 psi
32.5	42 psi

Note: Size/DR listings shown are commonly requested. Many DR options not listed are available. Please consult an ISCO representative for availability.

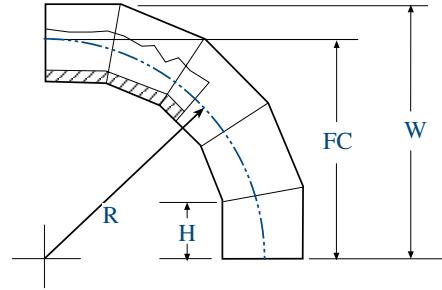

Nominal Size (in)	Pipe OD (in)	DR	Part #	Dimensions				Weight (lbs)	Shipping Method
				R (in)	H (in)	FC (in)	W (in)		
4	4.8	11	ISFF900411DIPS	14.33	7	18.95	21.35	7	FedEx
		17	ISFF900417DIPS	"	"	"	"	5	"
6	6.9	11	ISFF900611DIPS	20.61	8	25.20	28.55	20	FedEx
		17	ISFF900617DIPS	"	"	"	"	14	"
8	9.05	11	ISFF900811DIPS	22.62	8	27.02	31.55	38	FedEx
		17	ISFF900817DIPS	"	"	"	"	25	"
10	11.1	11	ISFF901011DIPS	22.62	8	27.23	32.78	56	FedEx
		17	ISFF901017DIPS	"	"	"	"	38	"
12	13.2	11	ISFF901211DIPS	26.39	10	32.46	39.06	96	FedEx
		17	ISFF901217DIPS	"	"	"	"	64	"
14	15.3	11	ISFF901411DIPS	27.44	12	35.51	43.16	141	LTL
		17	ISFF901417DIPS	"	"	"	"	95	"
16	17.4	11	ISFF901611DIPS	34.94	12	41.72	50.42	215	LTL
		17	ISFF901617DIPS	"	"	"	"	144	"
18	19.5	11	ISFF901811DIPS	38.96	12	45.15	54.9	292	LTL
		17	ISFF901817DIPS	"	"	"	"	196	"
20	21.6	11	ISFF902011DIPS	43.23	13	49.78	60.58	395	LTL
		17	ISFF902017DIPS	"	"	"	"	265	"
24	25.8	11	ISFF902411DIPS	51.53	13	56.58	69.75	643	LTL
		17	ISFF902417DIPS	"	"	"	"	432	"
30	32.0	17	ISFF903017DIPS	54.63	13	59.95	75.95	700	LTL



1-800-345-ISCO
www.isco-pipe.com