

Transition Saddles - Brass AWWA

See the corresponding drawings on pages 214 & 215



Part #	Base x Outlet Size	Fusion Setting	Pin	Clamp Style See Page 207	Drawing Number
5757612	2" IPS x 3/4" (Fem Corp) AWWA	A	4.7mmR	B	1
5757614	3" IPS x 3/4" (Fem Corp) AWWA	A	4.7mmR	C	1
5757616	4" IPS/DIPS x 3/4" (Fem Corp) AWWA	A	4.7mmR	D/L	1
5757618	6" IPS/DIPS x 3/4" (Fem Corp) AWWA	A	4.7mmR	E/M	1
5757620	8" IPS x 3/4" (Fem Corp) AWWA	A	4.7mmR	H	1
5758725	8" DIPS x 3/4" (Fem Corp) AWWA	M	4.7mm	H	1
5758713*	10" IPS x 3/4" (Fem Corp) AWWA	M	4.7mm	H	1
5758702*	12" DIPS x 3/4" (Fem Corp) AWWA	M	4.7mm	H	1
5757622	2" IPS x 1" (Fem Corp) AWWA	A	4.7mmR	B	1
5757624	3" IPS x 1" (Fem Corp) AWWA	A	4.7mmR	C	1
5757626	4" IPS/DIPS x 1" (Fem Corp) AWWA	A	4.7mmR	D/L	1
5757528	6" IPS/DIPS x 1" (Fem Corp) AWWA	A	4.7mmR	E/M	1
5757630	8" IPS x 1" (Fem Corp) AWWA	A	4.7mmR	H	1
5758706*	8" DIPS x 1" (Fem Corp) AWWA	M	4.7mm	H	1
5758723*	10" DIPS x 1" (Fem Corp) AWWA	M	4.7mm	H	1
5758703*	12" DIPS x 1" (Fem Corp) AWWA	M	4.7mm	H	1
10001329	2" IPS x 1 1/4" (Fem Corp) AWWA	A	4.7mmR	B	1
10001330	3" IPS x 1 1/4" (Fem Corp) AWWA	A	4.7mmR	C	1
5758290	4" IPS/DIPS x 1-1/4" (Fem Corp) AWWA	A	4.7mmR	D/L	1
10001331	6" IPS/DIPS x 1 1/4" (Fem Corp) AWWA	A	4.7mmR	E/M	1
5758293	2" IPS x 1-1/2" (Fem Corp) AWWA	A	4.7mmR	B	1
5758294	3" IPS x 1-1/2" (Fem Corp) AWWA	A	4.7mmR	C	1
5758295	4" IPS/DIPS x 1-1/2" (Fem Corp) AWWA	A	4.7mmR	D/L	1
5758296	6" IPS/DIPS x 1-1/2" (Fem Corp) AWWA	A	4.7mmR	E/M	1
5758297	8" IPS x 1-1/2" (Fem Corp) AWWA	A	4.7mmR	H	1
5758704*	12" IPS/DIPS x 1-1/2" (Fem Corp) AWWA	M	4.7mm	H	1
5758715	4" IPS/DIPS x 2" (Fem Corp) AWWA	A	3.0mm	D/L	2
5758727	6" IPS/DIPS x 2" (Fem Corp) AWWA	A	4.7mmR	E/M	2
5758717*	8" DIPS x 2" (Fem Corp) AWWA	M	4.7mm	H	2
5758729	8" IPS x 2" (Fem Corp) AWWA	A	4.7mmR	H	2
5758711*	10" IPS x 2" (Fem Corp) AWWA	M	4.7mm	H	2
5758705*	12" DIPS x 2" (Fem Corp) AWWA	M	4.7mm	H	2

A=Automatic Identification for Fusion Time. M=Manual Setting or Bar Code Setting.

* Special Lead Requirements.



Central
Electrofusion
Products

1-800-345-ISCO

www.isco-pipe.com

Transition Saddles - Brass ANSI
 See the corresponding drawings
 on pages 214 & 215



Part #	Base x Outlet Size	Pin	Fusion Time Setting	Clamp Style	Drawing Number
5757572	2" IPS x 3/4" (FPT) AWWA	4.7mmR	A	B	1
5757574	3" IPS x 3/4" (FPT) AWWA	4.7mmR	A	C	1
5757576	4" IPS x 3/4" (FPT) AWWA	4.7mmR	A	D/L	1
5757578	6" IPS x 3/4" (FPT) AWWA	4.7mmR	A	E/M	1
5757580	8" IPS x 3/4" (FPT) AWWA	4.7mmR	A	H	1
5758725	8" DIPS x 3/4" (FPT) AWWA	4.7mm	M	H	1
5758716*	10" IPS x 3/4" (FPT) AWWA	4.7mm	M	H	1
5757582	2" IPS x 1" (FPT) AWWA	4.7mmR	A	B	1
5757584	3" IPS x 1" (FPT) AWWA	4.7mmR	A	C	1
5757586	4" IPS/DIPS x 1" (FPT) AWWA	4.7mmR	A	D/L	1
5757588	6" IPS/DIPS x 1" (FPT) AWWA	4.7mmR	A	E/M	1
5757590	8" IPS x 1" (FPT) AWWA	4.7mmR	A	H	1
5758718	8" DIPS x 1" (FPT) AWWA	4.7mm	M	H	1
5758714*	10" IPS x 1" (FPT) AWWA	4.7mm	M	H	1
5758722*	10" DIPS x 1" (FPT) AWWA	4.7mm	M	H	1
5758721*	12" IPS x 1" (FPT) AWWA	4.7mm	M	H	1
5757592	2" IPS x 1-1/4" (FPT) AWWA	4.7mmR	A	B	1
5757594	3" IPS x 1-1/4" (FPT) AWWA	4.7mmR	A	C	1
5757596	4" IPS/DIPS x 1-1/4" (FPT) AWWA	4.7mmR	A	D/L	1
5757598	6" IPS/DIPS x 1-1/4" (FPT) AWWA	4.7mmR	A	E/M	1
5757600	8" IPS x 1-1/4" (FPT) AWWA	4.7mmR	A	H	1
5757602	2" IPS x 1-1/2" (FPT) AWWA	4.7mmR	A	B	1
5757604	3" IPS x 1-1/2" (FPT) AWWA	4.7mmR	A	C	1
5757606	4" IPS/DIPS x 1-1/2" (FPT) AWWA	4.7mmR	A	D/L	1
5757608	6" IPS/DIPS x 1-1/2" (FPT) AWWA	4.7mmR	A	E/M	1
5757610	8" IPS x 1-1/2" (FPT) AWWA	4.7mmR	A	H	1
5758719	8" DIPS x 1-1/2" (FPT) AWWA	4.7mm	M	H	1
5758712*	10" IPS x 1-1/2" (FPT) AWWA	4.7mm	M	H	1
5758708*	10" DIPS x 1-1/2" (FPT) AWWA	4.7mm	M	H	1
5758697	4" IPS x 2" (FPT) AWWA	3.0mm	A	D/L	2
5758726	6" IPS/DIPS x 2" (FPT) AWWA	4.7mmR	A	E/M	2
5758720	8" IPS x 2" (FPT) AWWA	4.7mm	M	H	2
5758725	8" IPS x 2" (FPT) AWWA	4.7mmR	A	H	2
5758698*	12" IPS x 2" (FPT) AWWA	4.7mm	M	H	2

A=Automatic Identification for Fusion Time. M=Manual Setting or Bar Code Setting.
 * Special Lead Requirements.

Central
 Electrofusion
 Products

1-800-345-ISCO

www.isco-pipe.com



Transition Saddles Stainless Steel ANSI

See the corresponding drawings on pages 214 & 215



Base x Outlet Size	Part #	Fusion Setting	Pin	Clamp Style See Page 207	Drawing Number
2" IPS x 3/4" (FPT)	5757571	A	4.7mmR	B	1
3" IPS x 3/4" (FPT)	5757573	A	4.7mmR	C	1
4" IPS/DIPS x 3/4" (FPT)	5757575	A	4.7mmR	D/L	1
6" IPS/DIPS x 3/4" (FPT)	5757577	A	4.7mmR	E/M	1
8" IPS x 3/4" (FPT)	5757579	A	4.7mmR	H	1
8" DIPS x 3/4" (FPT)	5758699*	M	4.7mm	H	1
10" IPS x 3/4" (FPT)	5758701*	M	4.7mm	H	1
2" IPS x 1" (FPT)	5757581	A	4.7mmR	B	1
3" IPS x 1" (FPT)	5757583	A	4.7mmR	C	1
4" IPS/DIPS x 1" (FPT)	5757585	A	4.7mmR	D/L	1
6" IPS/DIPS x 1" (FPT)	5757586	A	4.7mmR	E/M	1
8" IPS x 1" (FPT)	5757589	A	4.7mmR	H	1
2" IPS x 1-1/4" (FPT)	5757591	A	4.7mmR	B	1
3" IPS x 1-1/4" (FPT)	5757593	A	4.7mmR	C	1
4" IPS/DIPS x 1-1/4" (FPT)	5757595	A	4.7mmR	D/L	1
6" IPS/DIPS x 1-1/4" (FPT)	5757597	A	4.7mmR	E/M	1
8" IPS x 1-1/4" (FPT)	5757599	A	4.7mmR	H	1
2" IPS x 1-1/2" (FPT)	5757601	A	4.7mmR	B	1
3" IPS x 1-1/2" (FPT)	5757603	A	4.7mmR	C	1
4" IPS/DIPS x 1-1/2" (FPT)	5757605	A	4.7mmR	D/L	1
6" IPS/DIPS x 1-1/2" (FPT)	5757607	A	4.7mmR	E/M	1
8" IPS x 1-1/2" (FPT)	5757609	A	4.7mmR	H	1

A=Automatic Identification for Fusion Time. M=Manual Setting or Bar Code Setting.
* Special Lead Requirements.



Transition Saddle Drawing 1: 3/4" to 1-1/2" Outlet

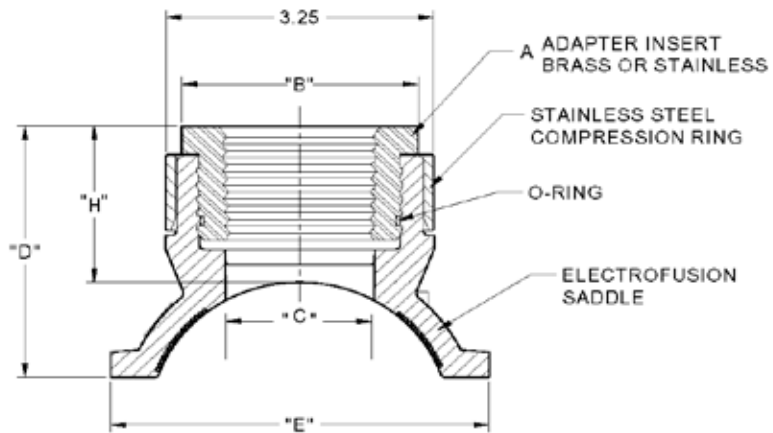

Nom. Pipe Saddle Size	Diameter C	Dimension D	Dimension E	Dimension H
2 IPS	1.50	3.18	3.59	2.06
3 IPS	1.81	3.18	4.60	2.06
4 IPS/DIPS	1.81	3.80	6.26	2.06
6 IPS	1.81	4.96	8.68	2.06
6 DIPS	1.81	4.96	8.68	2.06
8 IPS	1.81	N/A	5.92	1.94
8 DIPS	1.84	N/A	6.10	1.94
10 IPS	1.83	N/A	6.10	2.44
10 DIPS	1.84	N/A	6.10	2.21
12 IPS	1.83	N/A	6.10	2.39
12 DIPS	1.90	N/A	6.10	2.38

A Threaded Insert	B Diameter	Quality Standard
3/4" FPT	2.50	ANSI B1.20.1
1" FPT	2.50	ANSI B1.20.1
1-1/2" FPT	2.88	ANSI B1.20.1
3/4" Corp. Thd.	2.50	AWWA C800
1" Corp. Thd.	2.50	AWWA C800
1-1/4" Corp. Thd.	2.63	AWWA C800
1-1/2" Corp. Thd.	2.88	AWWA C800

Central
Electrofusion
Products

1-800-345-ISCO

www.isco-pipe.com

Transition Saddle Drawing 2: 2" Outlets

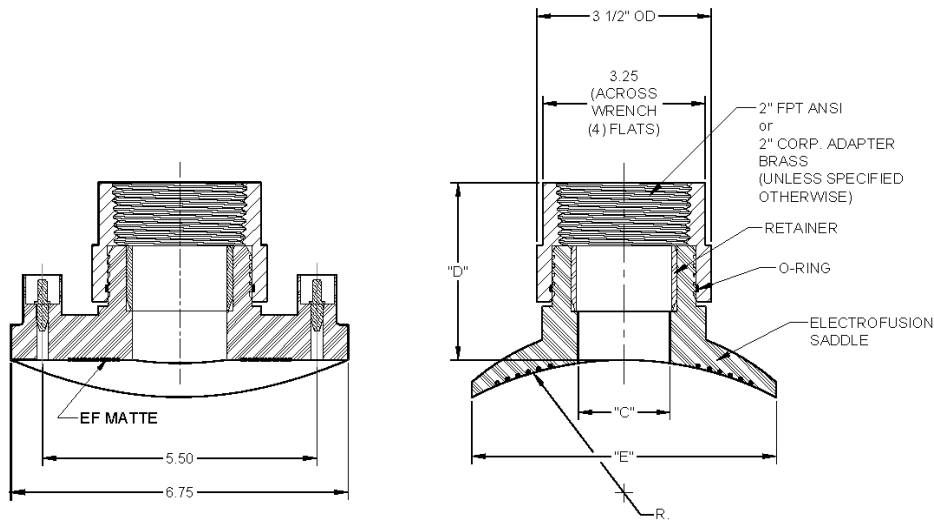

Nom. Pipe Saddle Size	Radius R	Diameter C	Dimension D	Dimension E
2 IPS	N/A	1.50	3.0	3.59
3 IPS	N/A	1.81	3.0	4.60
4 IPS/DIPS	N/A	1.81	3.0	6.26
6 IPS/DIPS	N/A	1.81	3.0	8.68
8 IPS	4.312 ±.012	1.81	2.96	5.92
8 DIPS	4.525 ±.012	1.84	3.10	6.10
10 IPS	5.375 ±.012	1.83	3.34	6.10
10 DIPS	5.550 ±.012	1.84	3.38	6.10
12 IPS	6.375 ±.012	1.83	3.52	6.10
12 DIPS	6.600 ±.012	1.90	3.54	6.10

A Threaded Insert	Quality Standard
2" FPT	ANSI B.1.201
2" Corp. Thd.	AWWA C800

Central
Electrofusion
Products

1-800-345-ISCO

www.isco-pipe.com