

FRIALEN® DAA High Pressure Tapping Tees



| Frialen Accessories for DAA High Pressure Tapping Tees | |
|--|--|
| Part Number | Description |
| 228050 | 10 mm Hex Wrench for 1-1/4" Main DAA Tees |
| 228051 | 17 mm Hex Wrench for 2" Main DAA Tees |
| 228052 | 19 mm Hex Wrench for 3" to 16" Main DAA Tees |
| 228024 | Pressure Test Cap Adapter for DAA Style 1-1/4" Tees |
| 228055 | Pressure Test Cap Adapter for DAA Style 2" to 16" Tees |

FRIALEN® Safety fittings can be fused to all PE pipes within Melt Index Groups 003-050 and Pipe SDR ranges 9.33 through 17.6. For Pipe SDR 21 and up, contact the ISCO Fusion Hotline at 1-800-345-ISCO ext. 4790 for reduced fusion times. Allow electrofusion joints to cool prior to handling, pressurizing or tapping.



FRIALEN® DAA High Pressure Tapping Tees (232 psi)

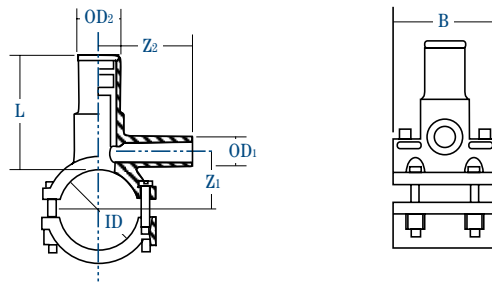

| Nominal Pipe | Main Size | Nominal Outlet | ID | OD 1 | OD 2 | Cutter | L | Z1 | Z2 | B |
|--------------|-----------|----------------|--------|-------|-------|--------|-------|--------|-------|-------|
| 1-1/4" | IPS | 1/2" CTS | 1.575 | 0.626 | 1.259 | 0.630 | 2.913 | 1.102 | 9.624 | 2.756 |
| 1-1/4" | IPS | 3/4" IPS | 1.575 | 1.051 | 1.259 | 0.630 | 2.913 | 1.102 | 9.624 | 2.756 |
| 1-1/4" | IPS | 1" CTS | 1.575 | 1.126 | 1.259 | 0.630 | 2.913 | 1.1027 | 9.624 | 2.756 |
| 1-1/4" | IPS | 1" IPS | 1.575 | 1.315 | 1.259 | 0.630 | 2.913 | 1.102 | 9.624 | 2.756 |
| 2" | IPS | 1/2" CTS | 2.378 | 0.626 | 1.575 | 0.846 | 3.937 | 1.780 | 3.701 | 4.094 |
| 2" | IPS | 3/4" IPS | 2.378 | 1.051 | 1.575 | 0.846 | 3.937 | 1.780 | 3.701 | 4.094 |
| 2" | IPS | 1" CTS | 2.378 | 1.126 | 1.575 | 0.846 | 3.937 | 1.780 | 3.701 | 4.094 |
| 2" | IPS | 1" IPS | 2.378 | 1.315 | 1.575 | 0.846 | 3.937 | 1.780 | 3.701 | 4.094 |
| 3" | IPS | 1/2" CTS | 3.504 | 0.626 | 1.969 | 1.201 | 4.724 | 2.343 | 3.740 | 4.724 |
| 3" | IPS | 3/4" IPS | 3.504 | 1.051 | 1.969 | 1.201 | 4.724 | 2.343 | 3.937 | 4.724 |
| 3" | IPS | 1" CTS | 3.504 | 1.126 | 1.969 | 1.201 | 4.724 | 2.343 | 4.134 | 4.724 |
| 3" | IPS | 1" IPS | 3.504 | 1.315 | 1.969 | 1.201 | 4.724 | 2.343 | 4.134 | 4.724 |
| 3" | IPS | 2" IPS | 3.504 | 2.378 | 1.969 | 1.201 | 4.724 | 2.343 | 5.250 | 4.724 |
| 4" | IPS | 1/2" CTS | 4.512 | 0.626 | 1.969 | 1.201 | 4.724 | 2.846 | 3.740 | 4.764 |
| 4" | IPS | 3/4" IPS | 4.512 | 1.051 | 1.969 | 1.201 | 4.724 | 2.846 | 4.409 | 4.764 |
| 4" | IPS | 1" CTS | 4.512 | 1.126 | 1.969 | 1.201 | 4.724 | 2.846 | 4.409 | 4.764 |
| 4" | IPS | 1" IPS | 4.512 | 1.315 | 1.969 | 1.201 | 4.724 | 2.846 | 4.409 | 4.764 |
| 4" | IPS | 2" CTS | 4.512 | 2.378 | 1.969 | 1.201 | 4.724 | 2.846 | 5.250 | 4.764 |
| 6" | IPS | 1/2" CTS | 6.638 | 0.626 | 1.969 | 1.201 | 6.575 | 4.500 | 3.740 | 7.677 |
| 6" | IPS | 3/4" IPS | 6.638 | 1.051 | 1.969 | 1.201 | 6.575 | 4.500 | 4.331 | 7.677 |
| 6" | IPS | 1" CTS | 6.638 | 1.126 | 1.969 | 1.201 | 6.575 | 4.500 | 4.331 | 7.677 |
| 6" | IPS | 1" IPS | 6.638 | 1.315 | 1.969 | 1.201 | 6.575 | 4.500 | 4.331 | 7.677 |
| 6" | IPS | 2" CTS | 6.638 | 2.378 | 1.969 | 1.201 | 6.575 | 4.500 | 4.331 | 7.677 |
| 8" | IPS | 1/2" CTS | 8.605 | 0.626 | 1.969 | 1.201 | 6.575 | 5.598 | 3.740 | 7.677 |
| 8" | IPS | 3/4" IPS | 8.605 | 1.051 | 1.969 | 1.201 | 6.575 | 5.598 | 4.331 | 7.677 |
| 8" | IPS | 1" CTS | 8.605 | 1.126 | 1.969 | 1.201 | 6.575 | 5.598 | 4.331 | 7.677 |
| 8" | IPS | 1" IPS | 8.605 | 1.315 | 1.969 | 1.201 | 6.575 | 5.598 | 4.331 | 7.677 |
| 8" | IPS | 2" IPS | 8.605 | 2.378 | 1.969 | 1.201 | 6.575 | 5.598 | 5.500 | 7.677 |
| 10 - 16" * | IPS | 2" IPS | Varies | ----- | 1.750 | 1.201 | 6.575 | ----- | 6.575 | 7.677 |

* Friatop® Top Loading Tool required.

Friatec
Electrofusion
Products

1-800-345-ISCO

www.isco-pipe.com

FRIALEN® DAS II Top-Loading Tapping Tees



| Frialen® DAS Top Loading Tapping Tee Accessories | |
|---|---|
| Part Number | Description |
| 228067 | Complete Set Top Loading Tool and Tapping Tools |
| 228075 | Top Loading Tool Only |
| 228072 | 25mm Top Loading Cap Adapter Only |
| 228073 | 33mm Top Loading Cap Adapter Only |
| 228074 | 50mm Top Loading Cap Adapter Only |
| 228065 | 15mm DAS II Tap Tool Only |
| 228066 | 24mm DAS II Tap Tool Only |
| 228077 | DAS Lock Pin |
| 228078 | DAS Short Strap |
| 228079 | DAS Long Strap |
| 228080 | DAS Standard Case |
| Optional | Description |
| 228057 | 25mm Aluminum Test Cap |
| 228058 | 33mm Aluminum Test Cap |
| 228059 | 50mm Aluminum Test Cap |
| 228188 | Yellow Plano Tool Box 26" w/Foam |

FRIALEN® Safety fittings can be fused to all PE pipes within Melt Index Groups 003-050 and Pipe DR ranges 9.33 through 17.6. For Pipe DR 21 and up, contact the ISCO Fusion Hotline at 1-800-345-ISCO ext. 4790 for reduced heating times. Allow joints to cool prior to handling, pressurizing or tapping.



FRIALEN® DAS II Top-Loading Tapping Tees (160 psi)

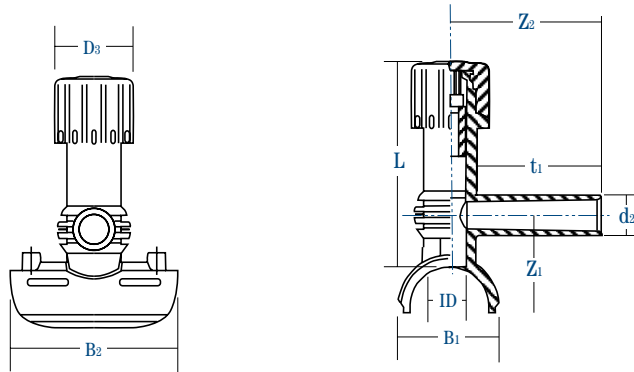

| Nominal Pipe | Main Size | Nominal Outlet | D3 | L | z1 | z2 | t1 | B1 | B2 | ID |
|--------------|-----------|----------------|-------|-------|-------|-------|-------|-------|-------|-------|
| 2" * | IPS | 1/2" CTS | 2.165 | 5.748 | 2.559 | 3.449 | 2.717 | 2.795 | 4.724 | 0.984 |
| 2" * | IPS | 3/4" IPS | 2.165 | 5.748 | 2.559 | 3.843 | 3.110 | 2.795 | 4.724 | 0.984 |
| 2" * | IPS | 1" CTS | 2.165 | 5.748 | 2.559 | 4.236 | 3.504 | 2.795 | 4.724 | 0.984 |
| 2" * | IPS | 1 1/4" IPS | 2.402 | 5.000 | 2.157 | 4.677 | 3.740 | 2.795 | 4.724 | 1.299 |
| 2" * | IPS | 2" IPS | 2.402 | 5.000 | 2.319 | 6.496 | 5.559 | 2.795 | 4.724 | 1.299 |
| 4" * | IPS | 1/2" CTS | 2.165 | 5.827 | 3.524 | 3.449 | 2.717 | 4.528 | 5.906 | 0.984 |
| 4" * | IPS | 3/4" IPS | 2.165 | 5.827 | 3.524 | 3.843 | 3.110 | 4.528 | 5.906 | 0.984 |
| 4" * | IPS | 1" CTS | 2.165 | 5.827 | 3.524 | 4.239 | 3.504 | 4.528 | 5.906 | 0.984 |
| 4" * | IPS | 1 1/4" IPS | 3.268 | 8.386 | 4.114 | 5.512 | 4.114 | 4.528 | 5.906 | 1.969 |
| 4" * | IPS | 2" IPS | 3.268 | 8.386 | 4.114 | 6.299 | 4.902 | 4.528 | 5.906 | 1.969 |
| 6" * | IPS | 1/2" CTS | 2.165 | 5.827 | 4.449 | 3.449 | 2.717 | 5.039 | 5.906 | 0.984 |
| 6" * | IPS | 3/4" IPS | 2.165 | 5.827 | 4.449 | 3.843 | 3.110 | 5.039 | 5.906 | 0.984 |
| 6" * | IPS | 1" CTS | 2.165 | 5.827 | 4.449 | 4.239 | 3.110 | 5.039 | 5.906 | 0.984 |
| 6" * | IPS | 1 1/4" IPS | 3.268 | 8.386 | 4.449 | 5.512 | 4.114 | 5.039 | 5.906 | 1.969 |
| 6" * | IPS | 2" CTS | 3.268 | 8.386 | 4.449 | 6.299 | 4.902 | 5.039 | 5.906 | 1.969 |
| 8" * | IPS | 1/2" CTS | 2.165 | 6.457 | 4.921 | 3.449 | 2.717 | 5.827 | 5.906 | 0.984 |
| 8" * | IPS | 3/4" IPS | 2.165 | 6.457 | 4.921 | 3.843 | 3.10 | 5.827 | 5.906 | 0.984 |
| 8" * | IPS | 1" CTS | 2.165 | 6.457 | 4.921 | 4.236 | 3.504 | 5.827 | 5.906 | 0.984 |
| 8" * | IPS | 1 1/4" IPS | 3.268 | 8.976 | 4.921 | 5.512 | 4.114 | 5.827 | 5.906 | 1.969 |
| 8" * | IPS | 2" IPS | 3.268 | 8.976 | 4.921 | 6.299 | 4.902 | 5.827 | 5.906 | 1.969 |

* DAS Top Loading Tool Required



Friatec
Electrofusion
Products

1-800-345-ISCO

www.isco-pipe.com