

DIPS Branch Saddle

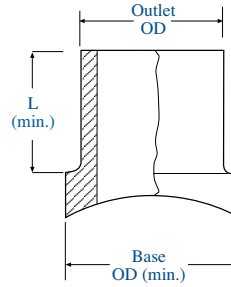

DIPS Branch Saddle

Nominal Outlet Size (in)	Outlet OD (in)	DR	Part #	Dimensions		Weight (lbs)	Shipping Method
				L (in)	Base OD (in)		
4	4.8	11	Varies*	4	6.6	4	FedEx
6	6.9	11	Varies*	5	8.6	9	FedEx
8	9.05	11	Varies*	6	11.5	17	FedEx
10	11.1	11	Varies*	8	13.8	31	FedEx
12	13.2	11	Varies*	10	16	47	FedEx

* Any size(IPS/DIPS) main available, but must be larger than outlet size. Consideration must be given that heater plate and fusion unit are available for rent.

** Hole saws for field cutting coupons are available for purchase. See fusion equipment accessory tooling section.

*** Pressure rating of saddles are equal to pipe DR of main. Other DR outlets may be available. Contact ISCO for availability.

DIPS Fittings Fabricated 45° Lateral Wye Three Segment

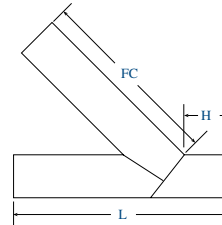

DIPS Fittings Fabricated 45° Lateral Wye - Three Segment

Nominal Pipe Size (in)	Pipe OD (in)	DR	Part #	Dimensions			Weight (lbs)	Shipping Method
				L (in)	H (in)	FC (in)		
4	4.8	11	ISFFWY0411DIPS	26.5	5.83	19.5	10	FedEx
6	6.9	11	ISFFWY0611DIPS	35.5	6.33	27.9	28	FedEx
8	9.05	11	ISFFWY0811DIPS	58	12	44	79	FedEx
10	11.1	11	ISFFWY1011DIPS	58	13	44	119	LTL
12	13.10	11	ISFFWY1211DIPS	64	16	48	184	LTL
14	15.3	11	ISFFWY1411DIPS	64	16	48	247	LTL
			ISFFWY1611DIPS	73	19	54	363	LTL
16	17.4	11	ISFFWY1617DIPS	"	"	"	244	"
			ISFFWY1811DIPS	73	19	54	456	LTL
18	19.5	17	ISFFWY1817DIPS	"	"	"	306	"
			ISFFWY2011DIPS	109	22	87	863	LTL
20	21.6	17	ISFFWY2017DIPS	"	"	"	580	"

DIPS HDPE Fittings

Pressure Rating of Fab Wye is based pipe DR (Wall thickness) and resin properties.

Wyes from 3608 resin:	
DR	Pressure Rating
7	89 psi
9	67 psi
11	53 psi
13.5	43 psi
15.5	37 psi
17	33 psi
21	27 psi
26	21 psi
32.5	17 psi

Wyes from 4710 resin:	
DR	Pressure Rating
7	112 psi
9	84 psi
11	67 psi
13.5	54 psi
15.5	46 psi
17	42 psi
21	34 psi
26	27 psi
32.5	21 psi

Note: Size/DR listings shown are commonly requested. Many DR options not listed are available. Please consult an ISCO representative for availability.

1-800-345-ISCO

www.isco-pipe.com

