

Class 125 • Threaded Cap • Brass/Bronze Disc • Threaded Ends

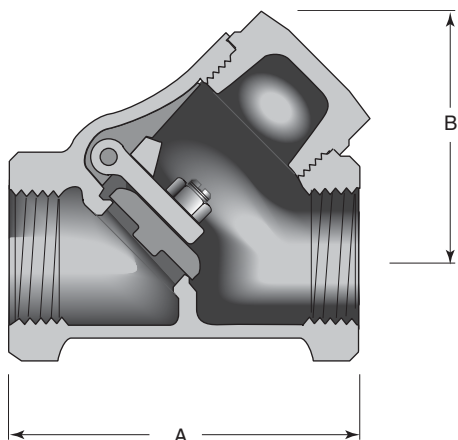

Features

- Y-Pattern Body with Integral Seat
- Seat can be reground while the valve remains in the line
- Threaded Ends
- Always install with pressure under the disc in vertical or horizontal position. An arrow cast on the body indicates the correct direction of flow.
- Screwed Cap
- MSS Specification SP-80

For more detailed features, refer to page 47.

Figure 37

Size Range:

¼" through 3"

Working Pressures Non-Shock:

125 psi Steam, Basic Rating

200 psi Cold Working Pressure

Principal Parts & Materials

Part	Sizes	Material	ASTM
Body	All	Bronze	B62 alloy C83600
Cap	All	Bronze	B61 alloy C92200
Disc	¼"-¾"	Brass	B16 H02
Disc	1" - 3"	Bronze	B61 alloy C92200
Hinge	All	Bronze	B584 alloy C87600
Hinge pin	All	Stainless Steel	18-8

Dimensions and Weights

Inches (millimeters) - pounds (kilograms)

	¼ (6)	⅜ (10)	½ (15)	¾ (20)	1 (25)	1 ¼ (32)	1 ½ (40)	2 (50)	2 ½ (65)	3 (80)
A	2.18 (55)	2.18 (55)	2.19 (56)	2.75 (70)	3.24 (82)	3.84 (98)	4.40 (112)	5.18 (132)	6.13 (156)	7.40 (188)
B	1.50 (38)	1.50 (38)	1.63 (41)	1.91 (49)	2.50 (64)	2.90 (74)	3.42 (87)	4.19 (106)	5.09 (129)	5.95 (151)
WTS.	0.60 (0.27)	0.60 (0.27)	0.70 (0.32)	1.10 (0.50)	1.80 (0.82)	2.60 (1.18)	3.90 (1.77)	6.10 (2.77)	10.30 (4.67)	15.10 (6.85)

Class 125 • Threaded Cap • PTFE Disc • Threaded Ends

Figure 41TF

Size Range:

½" through 2"

Working Pressures Non-Shock:

125 psi Steam, Basic Rating

200 psi Cold Working Pressure

Features

- Recommended for non-shock water, oil or gas.
- Threaded Ends
- Screwed Cap
- Y-Pattern Body
- PTFE Disc
- Always install with pressure under the disc in vertical or horizontal position. An arrow cast on the body indicates the correct direction of flow.
- MSS Specification SP-80

For more detailed features, refer to page 47.

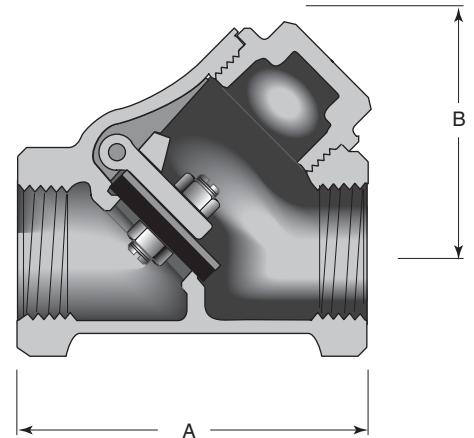

Principal Parts & Materials

Part	Sizes	Material	ASTM
Body	All	Bronze	B62 alloy C83600
Cap	All	Bronze	B61 alloy C92200
Disc	All	PTFE w/metal holder	—
Hinge	All	Bronze	B584 alloy 87600
Hinge pin	All	Stainless Steel	18-8

Dimensions and Weights

Inches (millimeters) - pounds (kilograms)

	½	¾	1	1 ¼	1 ½	2
	(15)	(20)	(25)	(32)	(40)	(50)
A	2.19 (56)	2.75 (70)	3.23 (82)	3.84 (98)	4.40 (112)	5.18 (132)
B	1.64 (42)	1.92 (49)	2.45 (62)	2.86 (73)	3.42 (87)	4.13 (105)
WTS.	0.70 (0.32)	1.10 (0.50)	1.80 (0.82)	2.60 (1.18)	3.90 (1.77)	6.20 (2.81)

Figure 137

Bronze Swing Check Valve



Class 150 • Threaded Cap • Brass/Bronze Disc • Threaded Ends

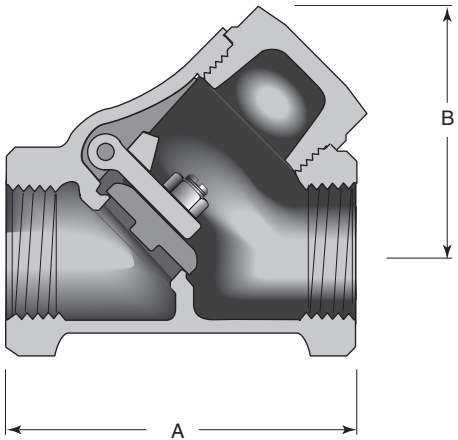

Features

- Y-Pattern Body
- Threaded Ends
- Free to rotate disc design allows the disc to close in a different position on the integral seat each time it operates.
- Re grindable Seat
- Always install with pressure under the disc in vertical or horizontal position. An arrow cast on the body indicates the correct direction of flow.
- Screwed Cap
- MSS Specification SP-80

For more detailed features, refer to page 47.

Figure 137

Size Range:

¼" through 3"

Working Pressures Non-Shock:

150 psi Steam, Basic Rating
300 psi Cold Working Pressure

Principal Parts & Materials

Part	Sizes	Material	ASTM
Body	All	Bronze	B62 alloy C83600
Cap	All	Bronze	B61 alloy C92200
Hinge	All	Bronze	B584 alloy C87600
Disc	¼" - ¾"	Brass	B16 H02
Disc	1" - 3"	Bronze	B61 alloy C92200
Hinge Pin	All	Stainless Steel	18-8

Dimensions and Weights

Inches (millimeters) - pounds (kilograms)

	¼ (6)	⅜ (10)	½ (15)	¾ (20)	1 (25)	1 ¼ (32)	1 ½ (40)	2 (50)	2 ½ (65)	3 (80)
A	2.18 (55)	2.18 (55)	2.19 (56)	2.75 (70)	3.24 (82)	3.84 (98)	4.40 (112)	5.18 (132)	6.13 (156)	7.40 (188)
B	1.50 (38)	1.50 (38)	1.63 (41)	1.91 (49)	2.50 (64)	2.90 (74)	3.42 (87)	4.19 (106)	5.09 (129)	5.95 (151)
WTS.	0.60 (0.27)	0.60 (0.27)	0.70 (0.32)	1.10 (0.50)	1.80 (0.82)	2.60 (1.18)	3.90 (1.77)	6.10 (2.77)	10.30 (4.67)	15.10 (6.85)

300 CWP • Threaded Cap • Brass/Bronze Disc • Solder Ends

Figure 1342

Size Range:

½" through 3"

Working Pressures Non-Shock:

300 psi Cold Working Pressure

Features

- Y-Pattern Body
- Solder Joint Ends
- Always install with pressure under the disc in vertical or horizontal position. An arrow cast on the body indicates the correct direction of flow.
- Screwed Cap
- MSS Specification SP-80

For more detailed features, refer to page 47.

Caution: Before installing solder-joint valves, be sure the solder or brazing alloy is compatible with the fluid media and the alloy melting point is high enough to withstand the pressure and temperature conditions. See page 5 for adjusted pressure/temperature ratings.

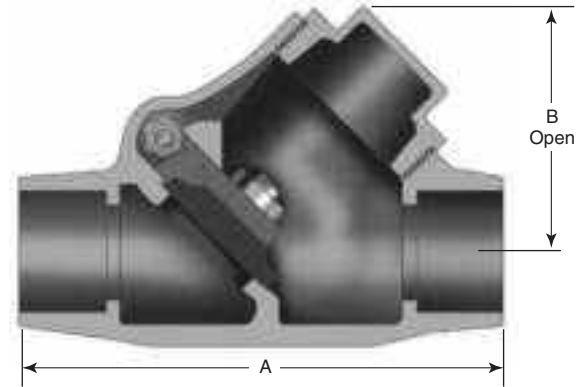

Principal Parts & Materials

Part	Sizes	Material	ASTM
Body	All	Bronze	B62 alloy C83600
Cap	All	Bronze	B61 alloy C92200
Disc	½" - ¾"	Brass	B16 H02
Disc	1" - 3"	Bronze	B61 alloy C92200
Hinge	All	Bronze	B584 alloy C87600
Hinge Pin	All	Stainless Steel	18-8

Dimensions and Weights

Inches (millimeters) - pounds (kilograms)

	½ (15)	¾ (20)	1 (25)	1 ¼ (32)	1 ½ (40)	2 (50)	2 ½ (65)	3 (80)
A	2.70 (69)	3.61 (92)	4.25 (108)	4.82 (122)	5.60 (142)	6.86 (174)	7.78 (198)	9.31 (236)
B	1.61 (41)	1.92 (49)	2.50 (64)	2.84 (72)	3.47 (88)	4.17 (106)	5.00 (127)	5.90 (150)
WTS.	0.70 (0.32)	1.10 (0.50)	1.80 (0.82)	2.50 (1.13)	4.10 (1.86)	6.40 (2.90)	10.60 (4.81)	15.90 (7.21)

Class 150 • Threaded Cap • PTFE Disc • Threaded Ends

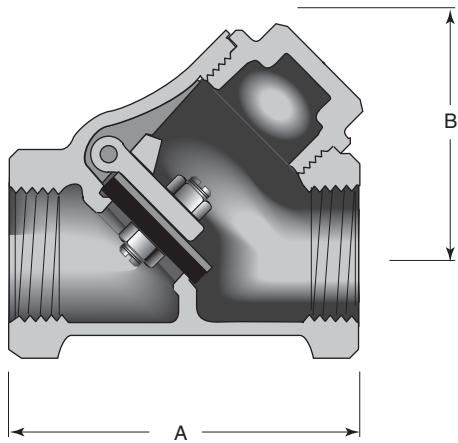

Features

- Y-Pattern Body
- Threaded Ends
- PTFE Disc
- Screwed Cap
- MSS Specification SP-80

For more detailed features, refer to page 47.

Figure 141TF

Size Range:

½" through 2"

Working Pressures Non-Shock:

150 psi Steam, Basic Rating
300 psi Cold Working Pressure

Principal Parts & Materials

Part	Material	ASTM
Body	Bronze	B62 alloy C83600
Cap	Bronze	B61 alloy C92200
Hinge	Bronze	B584 alloy C87600
Disc	PTFE w/metal holder	—
Hinge Pin	Stainless Steel	18-8

Dimensions and Weights

Inches (millimeters) - pounds (kilograms)

	½ (15)	¾ (20)	1 (25)	1 ¼ (32)	1 ½ (40)	2 (50)
A	2.19 (56)	2.75 (70)	3.23 (82)	3.84 (98)	4.40 (112)	5.18 (132)
B	1.64 (42)	1.92 (49)	2.45 (62)	2.86 (73)	3.42 (87)	4.13 (105)
WTS.	0.70 (0.32)	1.10 (0.50)	1.80 (0.82)	2.60 (1.18)	3.90 (1.77)	6.20 (2.81)

Class 200 • Threaded Cap • Brass/Bronze Disc • Threaded Ends

Figure 36

Size Range:

¼" through 3"

Working Pressures Non-Shock:

200 psi Steam, Basic Rating

400 psi Cold Working Pressure

Features

- Y-Pattern Body
- Threaded Ends
- Screwed Cap
- Rotating disc virtually eliminates "spot" seat wear.
- Always install with pressure under the disc in vertical or horizontal position. An arrow cast on the body indicates the correct direction of flow.
- MSS Specification SP-80

For more detailed features, refer to page 47.

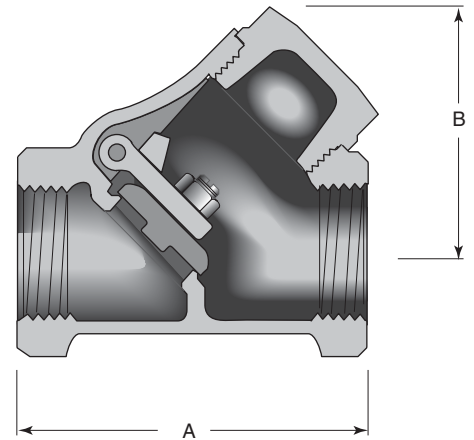

Principal Parts & Materials

Part	Sizes	Material	ASTM
Body & cap	All	Bronze	B61 alloy C92200
Hinge	All	Bronze	B584 alloy C87600
Disc	¼" - ¾"	Brass	B16 H02
Disc	1" - 3"	Bronze	B61 alloy C92200
Hinge Pin	All	Stainless Steel	18-8

Dimensions and Weights

Inches (millimeters) - pounds (kilograms)

	¼ (6)	⅜ (10)	½ (15)	¾ (20)	1 (25)	1 ¼ (32)	1 ½ (40)	2 (50)	2 ½ (65)	3 (80)
A	2.18 (55)	2.18 (55)	2.19 (56)	2.75 (70)	3.21 (82)	3.87 (98)	4.40 (112)	5.18 (132)	6.94 (176)	8.25 (210)
B	1.52 (39)	1.52 (39)	1.67 (42)	1.95 (50)	2.55 (65)	3.01 (76)	3.40 (86)	4.30 (109)	4.69 (119)	5.97 (152)
WTS.	0.60 (0.27)	0.60 (0.27)	0.80 (0.36)	1.20 (0.54)	1.90 (0.86)	2.70 (1.22)	4.30 (1.95)	7.10 (3.22)	13.90 (6.30)	21.60 (9.80)

200 CWP • Threaded Cap • Brass/Bronze Disc • Solder Ends

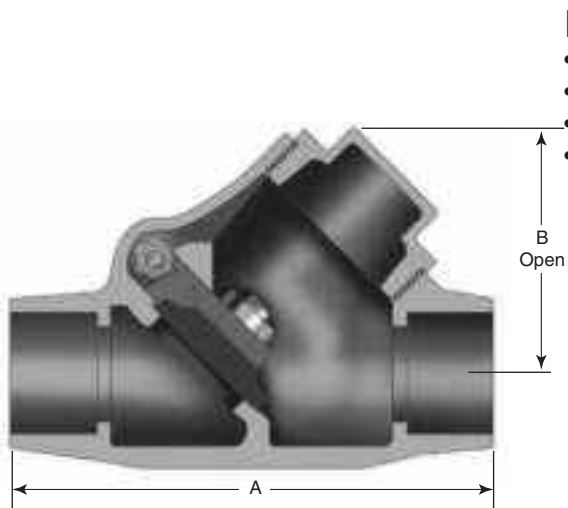

Features

- Y-Pattern Body
- Solder Joint Ends
- Screwed Cap
- MSS Specification SP-80, Type 3

For more detailed features, refer to page 47.

Figure 1340

Size Range:

½" through 3"

Working Pressures Non-Shock:

200 psi Cold Working Pressure

Principal Parts & Materials

Part	Size	Material	ASTM
Body	All	Bronze	B62 alloy C83600
Cap	All	Bronze	B61 alloy C92200
Disc	½"–¾"	Brass	B16 alloy H02
Disc	1"–3"	Bronze	B62 alloy C83600
Hinge	All	Bronze	B584 alloy C87600
Hinge Pin	All	Stainless Steel	A276 type 304

Dimensions and Weights

Inches (millimeters) - pounds (kilograms)

	½	¾	1	1 ¼	1 ½	2	2 ½	3
	(15)	(20)	(25)	(32)	(40)	(50)	(65)	(80)
A	2.69 (68)	3.63 (92)	4.25 (108)	4.81 (122)	5.56 (141)	6.87 (174)	7.78 (198)	9.19 (233)
B	1.63 (41)	2.00 (51)	2.50 (62)	3.00 (76)	3.50 (89)	4.00 (102)	4.75 (121)	5.63 (143)
WTS.	0.60 (0.27)	1.00 (0.45)	1.50 (0.68)	2.20 (1.00)	3.30 (1.50)	5.40 (2.45)	9.20 (4.17)	14.30 (6.49)

Class 300 • Threaded Cap • Brass/Bronze Disc • Threaded Ends

Figure 76E

Size Range:

¼" through 3"

Working Pressures Non-Shock:

300 psi Steam, Basic Rating

1000 psi Cold Working Pressure

¼" to 2" - (6mm - 50mm)

600 psi Cold Working Pressure

2 ½" to 3" - (65mm - 80mm)

Features

- Y-Pattern Body
- Threaded Ends
- Regrindable Seat
- Screwed Cap
- Always install with pressure under the disc in vertical or horizontal position. An arrow cast on the body indicates the correct direction of flow.
- MSS Specification SP-80

For more detailed features, refer to page 47.

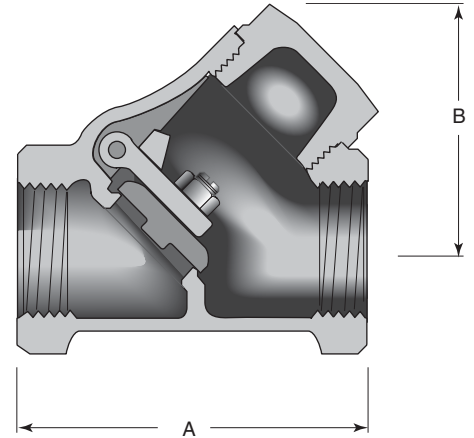

Principal Parts & Materials

Part	Sizes	Material	ASTM
Body & cap	All	Bronze	B61 alloy C92200
Hinge	All	Bronze	B584 alloy C87600
Disc	¼" - ¾"	Brass	B16 H02
Disc	1" - 3"	Bronze	B61 alloy C92200
Hinge Pin	All	Stainless Steel	18-8

Dimensions and Weights

Inches (millimeters) - pounds (kilograms)

	¼ (6)	⅜ (10)	½ (15)	¾ (20)	1 (25)	1 ¼ (32)	1 ½ (40)	2 (50)	2 ½ (65)	3 (80)
A	2.18 (55)	2.18 (55)	2.19 (56)	2.72 (69)	3.23 (82)	3.83 (97)	4.40 (112)	5.16 (131)	6.94 (176)	8.25 (210)
B	1.52 (39)	1.52 (39)	1.67 (42)	1.95 (50)	2.55 (65)	3.01 (76)	3.40 (86)	4.30 (109)	4.69 (119)	5.97 (152)
WTS.	0.60 (0.27)	0.60 (0.27)	0.80 (0.36)	1.20 (0.54)	1.90 (0.86)	2.70 (1.22)	4.30 (1.95)	7.10 (3.22)	13.90 (6.30)	21.60 (9.80)