

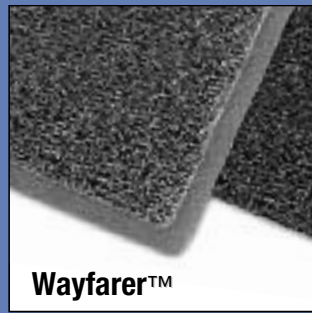

Rubber Brush™

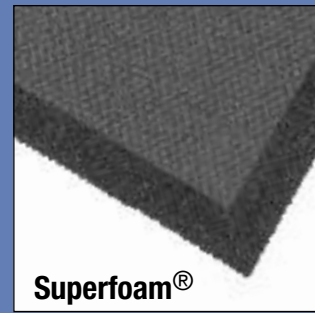

Wayfarer™



Superfoam®

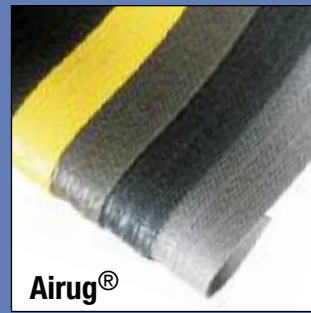

Airug®



Marble Sof-Tyle™



Cushion Trax®



Arrow Trax™



Sabre™



Uptown™/Boulevard™



Logo Mats

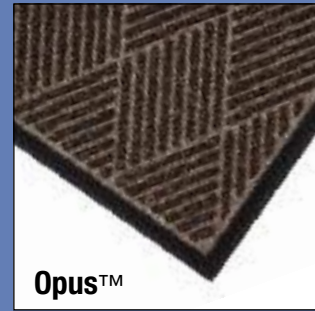

Opus™



Niru® Versa Runner®



Cushion-Ease®



Sanitop®



Modular Lok-Tyle™



V-Groove Runner

NOTRAX®
FLOOR MATTING



Superior Manufacturing Group, Inc.
5655 W. 73rd St. • Bedford Park, IL 60638
Phone: 800.621.2802 Fax: 800-322-7105
Email: info@notrax.com • Web: www.notrax.com

**HOTEL MATTING
APPLICATION GUIDE**

LOCATION	ITEM # - PRODUCT
1 OUTDOOR FRONT	231 - Prelude™ - GREENTRAX 265 - Wayfarer™ - GREENTRAX 266 - Wayfarer™ Custom - GREENTRAX 340 - Soil Guard™ - GREENTRAX 345 - Rubber Brush™ - GREENTRAX
2 BELL STAND	T17 - Superfoam® 447 - Comfort-Eze™ 470 - Marble Sof-Tyle™ 479 - Cushion Trax® 970 - Marble Sof-Tyle™ Grande™ 979 - Saddle Trax™
3 LOBBY AREA	105 - Chevron 117 - Heritage Rib® 118 - Arrow Trax™ - GREENTRAX 136 - Polynib™ - GREENTRAX 137 - Opera™ - GREENTRAX 138 - Uptown™ - GREENTRAX 139 - Boulevard™ - GREENTRAX 141 - Ovation™ - GREENTRAX 145 - Preference™ - GREENTRAX 146 - Encore™ - GREENTRAX 150 - Aqua Trap® - GREENTRAX 161 - Barrier Rib™ - GREENTRAX 166 - Guzzler™ - GREENTRAX 167 - Portrait™ - GREENTRAX 168 - Opus™ - GREENTRAX 170 - Orientrax™ 323 - Smart Step™ w/Arrow rax™ (recess well matting) Logo Mats - GREENTRAX
4 REGISTRATION AREA	T17 - Superfoam® 410 - Airug® 470 - Marble Sof-Tyle™ 479 - Cushion Trax® 825 - Cushion Stat™ 970 - Marble Sof-Tyle™ Grande™ 979 - Saddle Trax™ Carpet mat selection - See Lobby Area
5 BREAKFAST BAR	523 - Modular Lok-Tyle™ 550 - Cushion-Ease® 556 - Cushion-Ease® Solid 562 - Sanitop® - MICROSTOP® (Gray & Red only)
6 VENDING	105 - Chevron 117 - Heritage Rib® 130 - Sabre™ 136 - Polynib™ - GREENTRAX
7 FITNESS ROOM	045 - Weight Room Matting 411 - Sof-Tred™
8 POOL/SPA/ LOCKER ROOM	265 - Wayfarer™ - GREENTRAX 523 - Modular Lok-Tyle™ 531 - Safety Grid™ 755 - Niru® Versa Runner® - MICROSTOP®
9 BACK/SIDE ENTRANCE	117 - Heritage Rib® 118 - Arrow Trax™ - GREENTRAX 146 - Encore™ - GREENTRAX 161 - Barrier Rib™ - GREENTRAX 166 - Guzzler™ - GREENTRAX 167 - Portrait™ - GREENTRAX 168 - Opus™ - GREENTRAX 345 - Rubber Brush™ - GREENTRAX 370 - Master Trax™ - GREENTRAX
10 RESTAURANT/ BAR	T17 - Superfoam® 523 - Modular Lok-Tyle™ 543 - Cushion-Tred™ - MICROSTOP® (Red only) 562 - Sanitop® - MICROSTOP® (Gray & Red only) 755 - Niru® Versa Runner® - MICROSTOP®
11 KITCHEN	543 - Cushion-Tred™ - MICROSTOP® (Red only) 550 - Cushion-Ease® 556 - Cushion-Ease® Solid 562 - Sanitop® - MICROSTOP® (Gray & Red only) 755 - Niru® Versa Runner® - MICROSTOP®
12 LAUNDRY/ SERVICE AREA	117 - Heritage Rib® 118 - Arrow Trax™ - GREENTRAX 130 - Sabre™ 730 - V-Groove Runner 755 - Niru® Versa Runner® - MICROSTOP® 950 - Knee Rx Kneeling Pad 951 - Knee Rx Heavy Duty Kneeling Pad

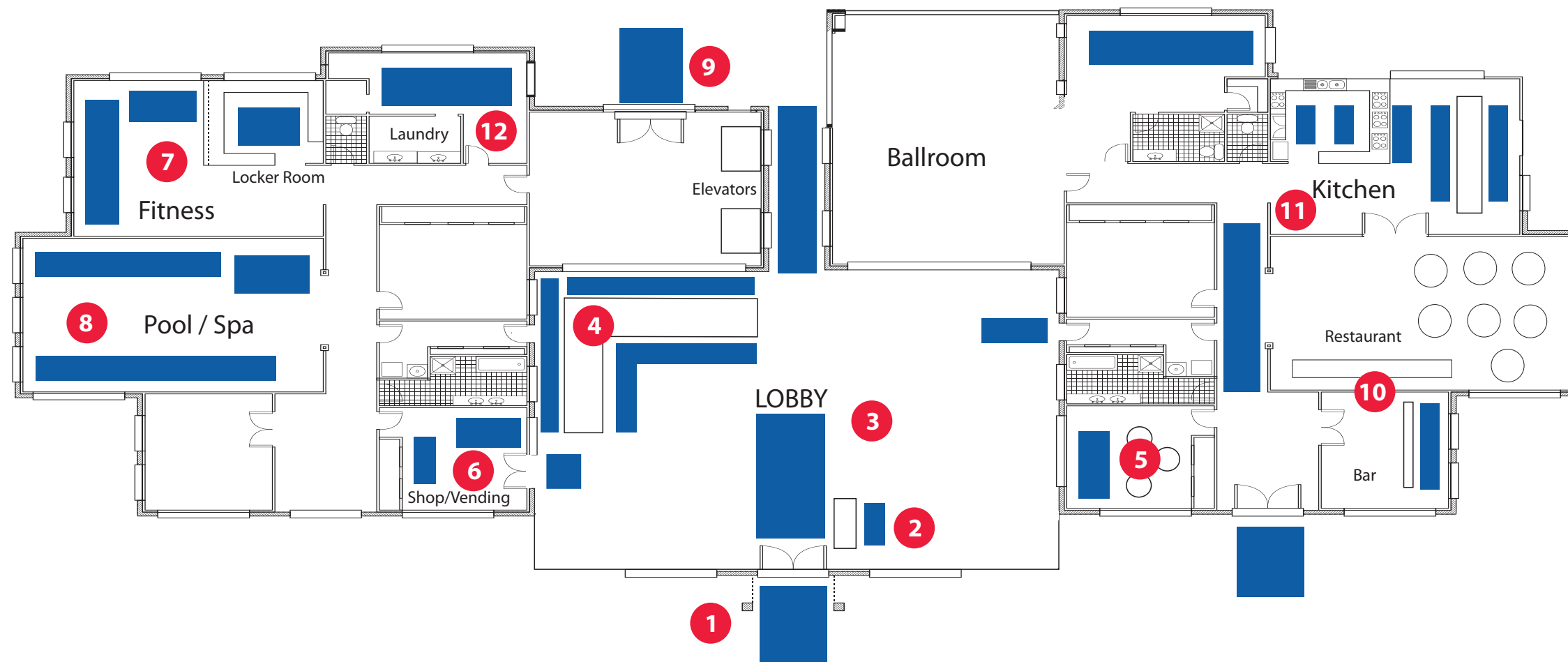

CHOOSING THE RIGHT MAT

YOUR MAT SELECTION SHOULD BE BASED ON FUNCTIONALITY (SCRAPE-N-CLEAN, ANTI-FATIGUE, SAFETY), ENVIRONMENT (WET, DRY), QUALITY, AND VALUE.

PRODUCTS FEATURING THE MICROSTOP™ LOGO ARE MADE WITH A UNIQUE ANTI-MICROBIAL RUBBER COMPOUND THAT INHIBITS THE GROWTH OF MICROORGANISMS SUCH AS BACTERIA, AND FUNGI THAT CAN CAUSE ODOR, STAINS, AND PRODUCT DETERIORATION. UNLIKE ANTI-MICROBIAL TREATMENTS, MICROSTOP™ IS INCORPORATED DIRECTLY INTO THE MAT DURING THE MANUFACTURING PROCESS SO IT CANNOT BE WASHED OFF OR WEAR AWAY OVER TIME. FLOOR MATTING PRODUCTS WITH MICROSTOP™ SHOULD BE USED IN CONJUNCTION WITH STANDARD CLEANING AND DISINFECTING PRACTICES IN ORDER TO PROVIDE A CLEANER AND HEALTHIER WORK ENVIRONMENT.

Products featuring the GreenTRAX™ logo are top-rated for use in "Green Cleaning" applications

LOCATION AND MAT RECOMMENDATION

LOCATION	GOOD BETTER BEST SUPERIOR SPECIALTY	DESCRIPTION
1 Outdoor Front	#231, #265, #266, #340, #345	Helps keep mud and dirt outside
2 Bell Stand	#T17, #447, #470-970, #479-979	Makes standing more comfortable
3 Lobby Area	#105, #117, #118, #136, #137, #138, #139, #141, #145, #146, #150, #161, #166, #167, #168, #170, #323, Logo Mats	Designed to keep traffic areas cleaner (#323 used for recessed well applications)
4 Registration Area	#T17, #410, #470-970, #479-979, 825 *(copier) (Carpet mat selection - see Lobby Area)	Employee comfort, keeps traffic areas clean *825 - Anti static matting for use with copiers
5 Breakfast Bar	#523, #562, #550, #556	Keeps area clean & safe, provides durability & comfort
6 Vending	#105, #117, #130, #136	Good water absorption capabilities
7 Fitness Room	#045, #411	Free weight areas and under equipment
8 Pool/Spa/Locker Room	#265, #523, #531, #755	Assits in prevention of slips and falls
9 Back/Side Entrance	#117, #118, #146, #161, #166, #167, #168, #345, #370	Helps keep mud and dirt outside
10 Restaurant/Bar	#T17, #523, #543, #562, #755	Lightweight comfort, oil resistant and easy to clean
11 Kitchen	#543, #550, #556, #562, #755	Hygiene & worker safety
12 Laundry/Service Area	#117, #118, #130, #730, #755, #950, #951	Easy cart access, anti-slip capabilities, Kneeling mats