

“C” SECTION

10 GROOVES

Dimensions

Datum dia.	O.D.	Part No.	List Price	Mult. Sym.	F = 10 3/8 inches					
					H	Type	B	L	E	Approx. Wt. (lbs)
8.0	8.4	10C80	460.00	QDS07	2 3/16	1B	E	2 5/8	5 9/16	46.3
8.5	8.9	10C85	480.00	QDS07	2 3/16	1B	E	2 5/8	5 9/16	52
9.0	9.4	10C90	500.00	QDS07	2 5/32	1B	J	4 1/2	3 23/32	54
9.5	9.9	10C95	510.00	QDS07	2 5/32	1B	J	4 1/2	3 23/32	67.4
10.0	10.4	10C100	520.00	QDS07	2 5/32	1B	J	4 1/2	3 23/32	77
10.5	10.9	10C105	580.00	QDS07	2 5/32	1B	J	4 1/2	3 23/32	85.7
11.0	11.4	10C110	600.00	QDS07	2 5/32	1B	J	4 1/2	3 23/32	93.5
12.0	12.4	10C120	760.00	QDS07	2 5/32	1B	J	4 1/2	3 23/32	111.8
13.0	13.4	10C130	840.00	QDS07	2 5/32	1W	J	4 1/2	3 23/32	105
14.0	14.4	10C140	900.00	QDS07	2 5/32	1W	J	4 1/2	3 23/32	114
16.0	16.4	10C160	960.00	QDS07	2 5/32	1A	J	4 1/2	3 23/32	140
18.0	18.4	10C180	1080.00	QDS07	2 5/32	1A	J	4 1/2	3 23/32	160
20.0	20.4	10C200	1120.00	QDS07	2 5/32	1A	J	4 1/2	3 23/32	165
24.0	24.4	10C240	1360.00	QDS07	9/32	1A	M°	6 3/4	3 11/32	225
30.0	30.4	10C300	1760.00	QDS07	9/32	1A	M°	6 3/4	3 11/32	275
36.0	36.4	10C360	2560.00	QDS07	9/32	1A	M°	6 3/4	3 11/32	340
44.0	44.4	10C440	2800.00	QDS07	9/32	1A	M°	6 3/4	3 11/32	460
50.0	50.4	10C500	3500.00	QDS07	9/32	1A	M°	6 3/4	3 11/32	550

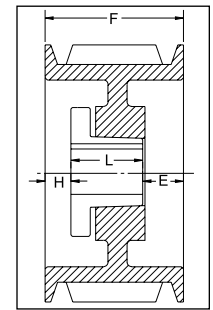

TYPE 1

12 GROOVES

Dimensions

Datum dia.	O.D.	Part No.	List Price	Mult. Sym.	F = 12 3/8 inches					
					H	Type	B	L	E	Approx. Wt. (lbs)
9.0	9.4	12C90	700.00	QDS07	2 21/32	1B	J	4 1/2	5 7/32	68
9.5	9.9	12C95	720.00	QDS07	2 21/32	1B	J	4 1/2	5 7/32	75
10.0	10.4	12C100	740.00	QDS07	2 21/32	1B	J	4 1/2	5 7/32	86
10.5	10.9	12C105	760.00	QDS07	2 21/32	1B	J	4 1/2	5 7/32	96
11.0	11.4	12C110	780.00	QDS07	2 21/32	1B	J	4 1/2	5 7/32	104
12.0	12.4	12C120	800.00	QDS07	2 21/32	1B	J	4 1/2	5 7/32	118.7
13.0	13.4	12C130	920.00	QDS07	2 21/32	1W	J	4 1/2	5 7/32	138
14.0	14.4	12C140	1180.00	QDS07	2 21/32	1W	J	4 1/2	5 7/32	153
16.0	16.4	12C160	1360.00	QDS07	2 21/32	1A	J	4 1/2	5 7/32	175
18.0	18.4	12C180	1400.00	QDS07	2 21/32	1A	J	4 1/2	5 7/32	198
20.0	20.4	12C200	1480.00	QDS07	9/32	1A	M°	6 3/4	5 11/32	237
24.0	24.4	12C240	1520.00	QDS07	9/32	1A	M°	6 3/4	5 11/32	277
30.0	30.4	12C300	1780.00	QDS07	9/32	1A	M°	6 3/4	5 11/32	357
36.0	36.4	12C360	2640.00	QDS07	9/32	1A	M°	6 3/4	5 11/32	430
44.0	44.4	12C440	3200.00	QDS07	9/32	1A	M°	6 3/4	5 11/32	520
50.0	50.4	12C500	3900.00	QDS07	9/32	1A	M°	6 3/4	5 11/32	595

P.D. for “C” Belts = O.D.

*Note: M-N-P-W bushings are standard mounting only with these parts.

Type of sheave “T”: A = arms; B = block; W = web