

### "D" SECTION

### 8 GROOVES

#### Dimensions

Datum dia.	O.D.	Part No.	List Price	Mult. Sym.	F = 11 13/16 inches					Approx. Wt. (lbs)
					H	Type	B	L	E	
12.0	12.6	<b>8D120</b>	1240.00	QDS07	2 5/32	1B	J	4 1/2	5 5/32	141
13.0	13.6	<b>8D130</b>	1260.00	QDS07	2 5/32	1B	J	4 1/2	5 5/32	163
13.5	14.1	<b>8D135</b>	1280.00	QDS07	2 5/32	1B	J	4 1/2	5 5/32	175
14.0	14.6	<b>8D140</b>	1320.00	QDS07	2 5/32	1B	J	4 1/2	5 5/32	187
14.5	15.1	<b>8D145</b>	1360.00	QDS07	2 5/32	1B	J	4 1/2	5 5/32	200
15.0	15.6	<b>8D150</b>	1380.00	QDS07	2 5/32	1W	J	4 1/2	5 5/32	183
15.5	16.1	<b>8D155</b>	1400.00	QDS07	2 5/32	1W	J	4 1/2	5 5/32	189
16.0	16.6	<b>8D160</b>	1560.00	QDS07	2 5/32	1W	J	4 1/2	5 5/32	197
17.0	17.6	<b>8D170</b>	1680.00	QDS07	2 5/32	1W	J	4 1/2	5 5/32	213
18.0	18.6	<b>8D180</b>	1820.00	QDS07	2 9/32	1W	M°	6 3/4	2 25/32	255
20.0	20.6	<b>8D200</b>	2000.00	QDS07	2 9/32	1W	M°	6 3/4	2 25/32	258
22.0	22.6	<b>8D220</b>	2160.00	QDS07	9/32	1A	M°	6 3/4	4 25/32	266
27.0	27.6	<b>8D270</b>	2660.00	QDS07	9/32	1A	M°	6 3/4	4 25/32	320
33.0	33.6	<b>8D330</b>	2840.00	QDS07	9/32	1A	M°	6 3/4	4 25/32	420
40.0	40.6	<b>8D400</b>	3720.00	QDS07	1/8	1A	N°	8 1/8	3 9/16	600
48.0	48.6	<b>8D480</b>	4320.00	QDS07	1/8	1A	N°	8 1/8	3 9/16	750
58.0	58.6	<b>8D580</b>	5280.00	QDS07	1/8	1A	N°	8 1/8	3 9/16	1000

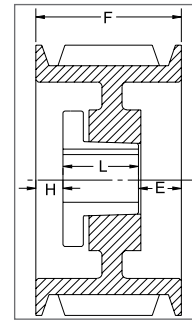

TYPE 1

### 10 GROOVES

#### Dimensions

Datum dia.	O.D.	Part No.	List Price	Mult. Sym.	F = 14 11/16 inches					Approx. Wt. (lbs)
					H	Type	B	L	E	
12.0	12.6	<b>10D120</b>	1520.00	QDS07	2 9/32	1B	M°	6 3/4	5 21/32	166
13.0	13.6	<b>10D130</b>	1580.00	QDS07	2 9/32	1B	M°	6 3/4	5 21/32	207
13.5	14.1	<b>10D135</b>	1660.00	QDS07	2 9/32	1B	M°	6 3/4	5 21/32	224
14.0	14.6	<b>10D140</b>	1740.00	QDS07	2 9/32	1B	M°	6 3/4	5 21/32	242
14.5	15.1	<b>10D145</b>	1840.00	QDS07	2 9/32	1B	M°	6 3/4	5 21/32	260
15.0	15.6	<b>10D150</b>	1860.00	QDS07	2 9/32	1B	M°	6 3/4	5 21/32	279
15.5	16.1	<b>10D155</b>	1880.00	QDS07	2 9/32	1B	M°	6 3/4	5 21/32	298
16.0	16.6	<b>10D160</b>	1900.00	QDS07	2 9/32	1B	M°	6 3/4	5 21/32	318
17.0	17.6	<b>10D170</b>	2080.00	QDS07	2 9/32	1W	M°	6 3/4	5 21/32	307
18.0	18.6	<b>10D180</b>	2120.00	QDS07	2 9/32	1W	M°	6 3/4	5 21/32	293
20.0	20.6	<b>10D200</b>	2380.00	QDS07	2 9/32	1W	M°	6 3/4	5 21/32	351
22.0	22.6	<b>10D220</b>	2480.00	QDS07	1 9/32	1A	M°	6 3/4	6 21/32	342
27.0	27.6	<b>10D270</b>	2980.00	QDS07	1 9/32	1A	M°	6 3/4	6 21/32	415
33.0	33.6	<b>10D330</b>	3280.00	QDS07	1 11/32	1A	N°	8 1/8	5 7/32	575
40.0	40.6	<b>10D400</b>	4300.00	QDS07	1 11/32	1A	N°	8 1/8	5 7/32	680
48.0	48.6	<b>10D480</b>	5080.00	QDS07	3/16	1A	P°	9 3/8	5 1/8	975
58.0	58.6	<b>10D580</b>	5880.00	QDS07	3/16	1A	P°	9 3/8	5 1/8	1250

P.D. for "D" Belts = O.D.

\*Note: M-N-P-W bushings are standard mounting only with these parts.

Type of sheave "T": A = arms; B = block; W = web