

“D” SECTION

5 GROOVES

Dimensions

Datum dia.	O.D.	Part No.	List Price	Mult. Sym.	F = 7 1/2 inches					
					H	Type	B	L	E	Approx. Wt. (lbs)
12.0	12.6	5D120	780.00	QDS07	1 27/32	1W	F	3 5/8	2 1/32	89
13.0	13.6	5D130	800.00	QDS07	1 27/32	1W	F	3 5/8	2 1/32	100
13.5	14.1	5D135	820.00	QDS07	1 27/32	1W	F	3 5/8	2 1/32	105
14.0	14.6	5D140	860.00	QDS07	1 27/32	1W	F	3 5/8	2 1/32	111
14.5	15.1	5D145	920.00	QDS07	1 27/32	1W	F	3 5/8	2 1/32	118
15.0	15.6	5D150	940.00	QDS07	1 27/32	1W	F	3 5/8	2 1/32	125
15.5	16.1	5D155	960.00	QDS07	1 27/32	1W	F	3 5/8	2 1/32	131
16.0	16.6	5D160	980.00	QDS07	1 27/32	1A	F	3 5/8	2 1/32	110
17.0	17.6	5D170	1000.00	QDS07	1 29/32	1A	J	4 1/2	1 3/32	148
18.0	18.6	5D180	1020.00	QDS07	1 29/32	1A	J	4 1/2	1 3/32	131
20.0	20.6	5D200	1220.00	QDS07	5/32	1A	J	4 1/2	2 27/32	148
22.0	22.6	5D220	1420.00	QDS07	5/32	1A	J	4 1/2	2 27/32	152
27.0	27.6	5D270	1740.00	QDS07	9/32	1A	M ^a	6 3/4	15/32	250
33.0	33.6	5D330	2180.00	QDS07	9/32	1A	M ^a	6 3/4	15/32	321
40.0	40.6	5D400	2700.00	QDS07	9/32	1A	M ^a	6 3/4	15/32	424
48.0	48.6	5D480	3080.00	QDS07	9/32	1A	M ^a	6 3/4	15/32	550
58.0	58.6	5D580	4280.00	QDS07	9/32	1A	M ^a	6 3/4	15/32	600

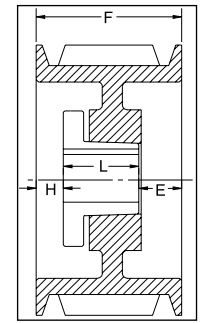

TYPE 1

6 GROOVES

Dimensions

Datum dia.	O.D.	Part No.	List Price	Mult. Sym.	F = 8 15/16 inches					
					H	Type	B	L	E	Approx. Wt. (lbs)
12.0	12.6	6D120	960.00	QDS07	1 29/32	1B	J	4 1/2	2 17/32	116
13.0	13.6	6D130	980.00	QDS07	1 29/32	1B	J	4 1/2	2 17/32	137
13.5	14.1	6D135	1000.00	QDS07	1 29/32	1B	J	4 1/2	2 17/32	147
14.0	14.6	6D140	1020.00	QDS07	1 29/32	1B	J	4 1/2	2 17/32	158
14.5	15.1	6D145	1040.00	QDS07	1 29/32	1B	J	4 1/2	2 17/32	170
15.0	15.6	6D150	1060.00	QDS07	1 29/32	1W	J	4 1/2	2 17/32	147
15.5	16.1	6D155	1080.00	QDS07	1 29/32	1W	J	4 1/2	2 17/32	153
16.0	16.6	6D160	1100.00	QDS07	1 29/32	1A	J	4 1/2	2 17/32	137
17.0	17.6	6D170	1120.00	QDS07	1 29/32	1A	J	4 1/2	2 17/32	175
18.0	18.6	6D180	1140.00	QDS07	1 29/32	1A	J	4 1/2	2 17/32	159
20.0	20.6	6D200	1480.00	QDS07	1 29/32	1A	J	4 1/2	2 17/32	185
22.0	22.6	6D220	1840.00	QDS07	9/32	1A	M ^a	6 3/4	1 29/32	225
27.0	27.6	6D270	1900.00	QDS07	9/32	1A	M ^a	6 3/4	1 29/32	300
33.0	33.6	6D330	2460.00	QDS07	9/32	1A	M ^a	6 3/4	1 29/32	350
40.0	40.6	6D400	2980.00	QDS07	9/32	1A	M ^a	6 3/4	1 29/32	460
48.0	48.6	6D480	3480.00	QDS07	9/32	1A	M ^a	6 3/4	1 29/32	600
58.0	58.6	6D580	4520.00	QDS07	3/16	1A	N ^a	8 1/8	5/8	760

P.D. for “D” Belts = O.D.

*Note: M-N-P-W bushings are standard mounting only with these parts.

Type of sheave “T”: A = arms; B = block; W = web

For more details and additional products, see complete Baldor•Maska® Product Catalog or www.maskapulleys.com

Gearmotors and Gear Products

PT Components

Motor Accessories

Grinders

Generators

Servo Motors and Controls

Mod Express

Baldor Education Workshops

Classifications and Sales Offices

EISA Compliance Table & Index