

### “C” SECTION

### 1 GROOVE

#### Dimensions

Datum dia.	O.D.	Part No.	List Price	Mult. Sym.	F = 1 3/8 inches					Approx. Wt. (lbs)
					H	Type	B	L	E	
7.0	7.4	1C70	112.00	QDS07	9/16	5B	SF	2	1/16	10
7.5	7.9	1C75	120.00	QDS07	9/16	5B	SF	2	1/16	11
8.0	8.4	1C80	124.00	QDS07	9/16	5B	SF	2	1/16	13.2
8.5	8.9	1C85	128.00	QDS07	9/16	5B	SF	2	1/16	15.6
9.0	9.4	1C90	132.00	QDS07	19/32	5W	SF	2	1/32	13
9.5	9.9	1C95	136.00	QDS07	19/32	5W	SF	2	1/32	18
10.0	10.4	1C100	140.00	QDS07	11/16	6W	SF	2	1/16	14
10.5	10.9	1C105	152.00	QDS07	11/16	6W	SF	2	1/16	20
11.0	11.4	1C110	172.00	QDS07	17/32	5W	SF	2	3/32	15
12.0	12.4	1C120	184.00	QDS07	11/16	6W	SF	2	1/16	16
13.0	13.4	1C130	240.00	QDS07	11/16	6A	SF	2	1/16	18
14.0	14.4	1C140	260.00	QDS07	11/16	6A	SF	2	1/16	20
16.0	16.4	1C160	280.00	QDS07	11/16	6A	SF	2	1/16	24
18.0	18.4	1C180	300.00	QDS07	11/16	6A	SF	2	1/16	32
20.0	20.4	1C200	320.00	QDS07	11/16	6A	SF	2	1/16	35
24.0	24.4	1C240	360.00	QDS07	11/16	6A	SF	2	1/16	46.9

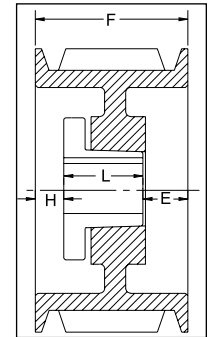

TYPE 1

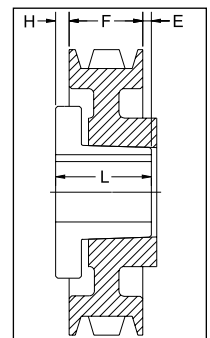

TYPE 5

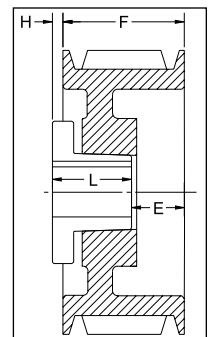

TYPE 6

### 2 GROOVES

#### Dimensions

Datum dia.	O.D.	Part No.	List Price	Mult. Sym.	F = 2 3/8 inches					Approx. Wt. (lbs)
					H	Type	B	L	E	
6.0	6.4	2C60	126.00	QDS06	1/16	1B	SF	2	5/16	11
7.0	7.4	2C70	132.00	QDS06	0	1B	SF	2	3/8	13
7.5	7.9	2C75	136.00	QDS06	0	1B	SF	2	3/8	15
8.0	8.4	2C80	144.00	QDS06	0	1B	SF	2	3/8	17
8.5	8.9	2C85	148.00	QDS06	0	1B	SF	2	3/8	19
9.0	9.4	2C90	152.00	QDS06	0	1W	SF	2	3/8	21
9.5	9.9	2C95	160.00	QDS06	0	1W	SF	2	3/8	22
10.0	10.4	2C100	176.00	QDS06	0	1W	SF	2	3/8	21.8
10.5	10.9	2C105	188.00	QDS06	0	1W	SF	2	3/8	23
11.0	11.4	2C110	200.00	QDS06	0	1W	SF	2	3/8	26
12.0	12.4	2C120	210.00	QDS06	1/4	6W	SF	2	5/8	37
13.0	13.4	2C130	250.00	QDS06	1/4	6A	SF	2	5/8	35
14.0	14.4	2C140	270.00	QDS06	1/4	6A	SF	2	5/8	40
16.0	16.4	2C160	290.00	QDS06	1/4	6A	SF	2	5/8	40
18.0	18.4	2C180	310.00	QDS06	1/4	6A	SF	2	5/8	50
20.0	20.4	2C200	340.00	QDS06	1/4	6A	SF	2	5/8	55
24.0	24.4	2C240	460.00	QDS06	1/4	6A	SF	2	5/8	73.1
27.0	27.4	2C270	550.00	QDS06	29/32	5A	F	3 5/8	11/32	94
30.0	30.4	2C300	620.00	QDS06	29/32	5A	F	3 5/8	11/32	104

P.D. for “C” Belts = O.D.

Type of sheave “T”: A = arms; B = block; W = web