

SPECLINE™ DAMPER REGULATORS

MINIMUM LEAKAGE DAMPER REGULATORS

Specline Regulators are designed for minimum leakage applications. Each regulator is comprised of a frame, an indicator handle, a serrated cast alloy core and a cast alloy nut. Serrations on the cast alloy core mesh with serrations in the frame to firmly lock the regulator in position. A spring washer situated between the core and the cast frame allows for smooth non-binding adjustment. A wedge pin is used to eliminate rattle and take up slack between regulator and damper shaft.

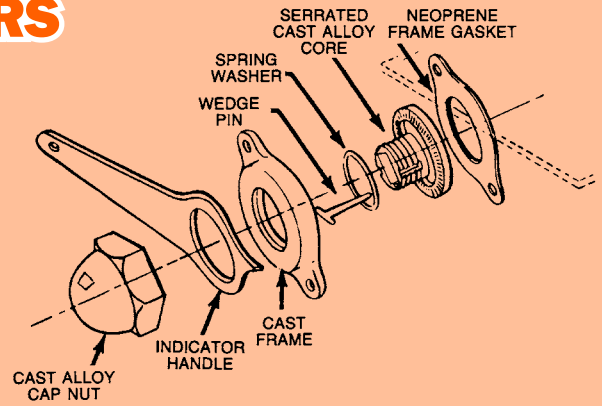

- All SR and SRH type regulators include a cast alloy frame and a neoprene frame gasket.
- The SRHS and SRS utilize a stamped frame and include a neoprene frame gasket.

INDICATOR STYLE REGULATOR SET WITH HEX NUT AND ACORN NUT

Regulator Height 5/8"



SRH-Series

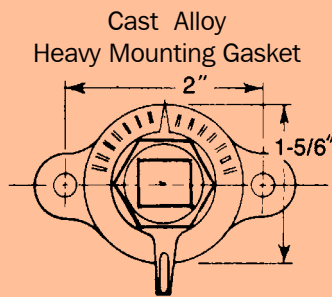

Regulator Height 1-3/8"



SR-Series

INDICATOR STYLE CAST		
ITEM#	MODEL	SHAFT SIZE & NUT
8010	SRH240	1/4" Hex Nut
8012	SRH280	3/8" Hex Nut
8014	SRH220	1/2" Hex Nut
<hr/>		
8001	SR140	1/4" Acorn Nut
8003	SR380	3/8" Acorn Nut
8005	SR120	1/2" Acorn Nut
Packed 10 Per Carton		

HANDLE REGULATOR SET WITH HEX NUT AND ACORN NUT

Regulator Height 5/8"



SRH-Series

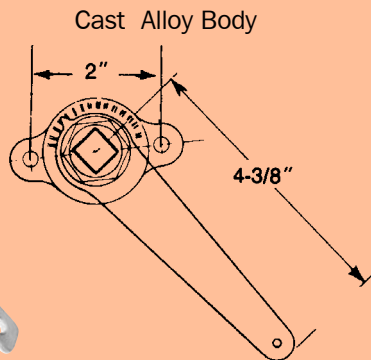

Regulator Height 1-3/8"



SR-Series

HANDLE SET CAST		
ITEM#	MODEL	SHAFT SIZE & NUT
8011	SRH248	1/4" Hex Nut
8013	SRH288	3/8" Hex Nut
8015	SRH228	1/2" Hex Nut
<hr/>		
8002	SR148	1/4" Acorn Nut
8004	SR388	3/8" Acorn Nut
8006	SR128	1/2" Acorn Nut
Packed 10 Per Carton		

HANDLE STYLE (STAMPED) REGULATOR SET WITH HEX NUT & ACORN NUT

Regulator Height 5/8"



SRHS-Series

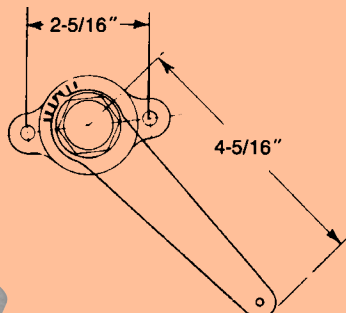

Regulator Height 1-3/8"



SRS-Series

- Stamped Frame
- Heavy Stamped Handle
- Solid Die Cast Core
- Hex Nut

HANDLE SET (STAMPED)		
ITEM#	MODEL	SHAFT SIZE & NUT
8016	SRHS148	1/4" Hex Nut
8017	SRHS388	3/8" Hex Nut
8018	SRHS128	1/2" Hex Nut
<hr/>		
8022	SRS148	1/4" Acorn Nut
8023	SRS388	3/8" Acorn Nut
8024	SRS128	1/2" Acorn Nut
Packed 10 Per Carton		

ELEVATED REGULATOR SETS FOR INSULATED DUCTS WITH HEX NUT

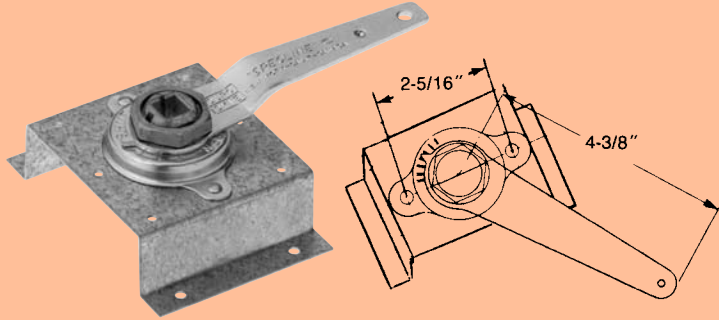

SRST SERIES			
ITEM#	MODEL	SHAFT SIZE	STAND HEIGHT
8184	SRST 1-148 w/SRHS-148	1/4" sq.	1"
8318	SRST 1-1/2-148 w/SRHS-148	1/4" sq.	1-1/2"
8196	SRST 2-148 w/SRHS-148	1/4" sq.	2"
8019	SRST 1-388 w/SRHS-388	3/8" sq.	1"
8020	SRST 1-1/2-388 w/SRHS-388	3/8" sq.	1-1/2"
8021	SRST 2-388 w/SRHS-388	3/8" sq.	2"
8208	SRST 1-128 w/SRHS-128	1/2" sq.	1"
8384	SRST 1-1/2-128 w/SRHS-128	1/2" sq.	1-1/2"
8177	SRST 2-128 w/SRHS-128	1/2" sq.	2"

Packed 10 Per Carton

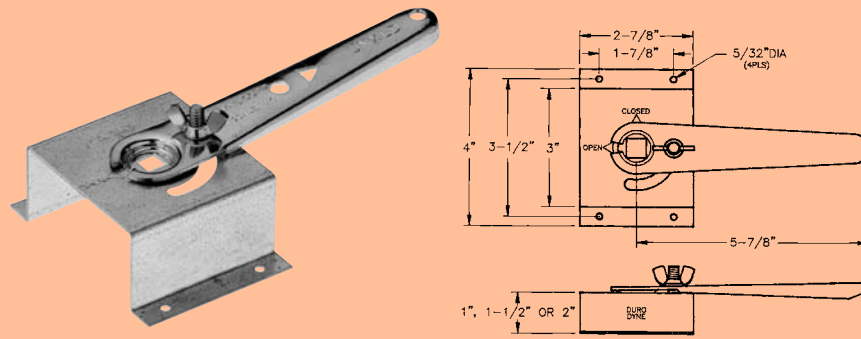

ESO SERIES			
ITEM#	MODEL	SHAFT SIZE	STAND HEIGHT
7201	ESO-14-100	1/4" sq.	1"
7203	ESO-14-150	1/4" sq.	1-1/2"
7205	ESO-14-200	1/4" sq.	2"
7207	ESO-38-100	3/8" sq.	1"
7209	ESO-38-150	3/8" sq.	1-1/2"
7211	ESO-38-200	3/8" sq.	2"
7213	ESO-12-100	1/2" sq.	1"
7215	ESO-12-150	1/2" sq.	1-1/2"
7217	ESO-12-200	1/2" sq.	2"

Also Available for Round Duct. Seal Kits Sold Separately.
Packed 10 Per Carton

90° ANGLE DRIVE DIE CAST MITRE GEAR ASSEMBLY



Will accommodate 3/8" square rod from duct

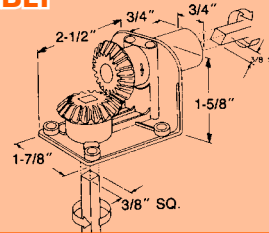

90° ANGLE DRIVE		
ITEM#	MODEL	DESCRIPTION
8135	AD38	Mitre Gear Assembly

Packed 5 Per Carton

CONCEALED STYLE REGULATOR SET WITH HEX NUT

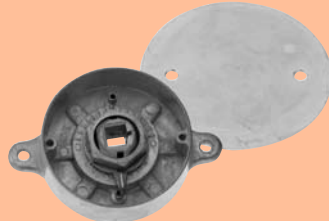

Attractive Cast Alloy Corrosion Resistant Plated Cover

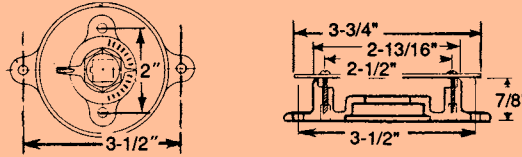

CONCEALED		
ITEM#	MODEL	SHAFT SIZE
8007	SRC140	1/4" sq.
8008	SRC380	3/8" sq.
8009	SRC120	1/2" sq.

Packed 5 Per Carton

SPECLINE PARTS AND ACCESSORIES

OPEN END BEARING CAST ALLOY

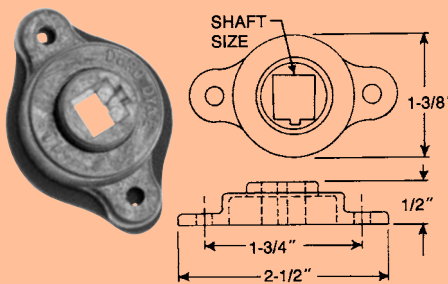

OPEN END		
ITEM#	MODEL	SHAFT SIZE
8025	SB114	1/4" sq.
8027	SB138	3/8" sq.
8029	SB112	1/2" sq.

Packed 25 Per Carton

CLOSED END BEARING CAST ALLOY

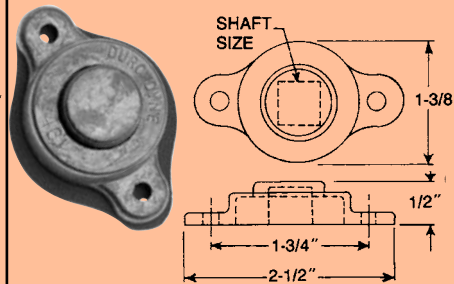

CLOSED END		
ITEM#	MODEL	SHAFT SIZE
8026	SB314	1/4" sq.
8028	SB338	3/8" sq.
8030	SB312	1/2" sq.

Packed 25 Per Carton

DAMPER AND DEFLECTOR CASTINGS

Damper And Deflector Castings Control of 3/8" round rod where used to operate dampers. Either type can be used.

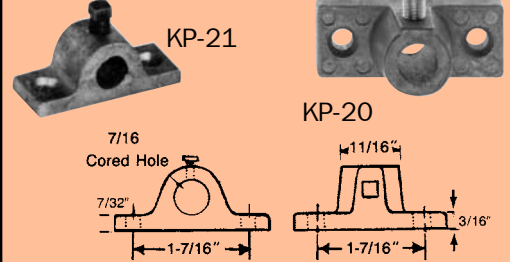

CASTINGS		
ITEM#	MODEL	Description
8037	KP20	Damper Casting
8038	KP21	Deflector Casting

Packed 100 Per Carton

SPECLINE PARTS AND ACCESSORIES (CONT.)

Splitter Damper Bracket
Steel Bracket, Brass Pivot

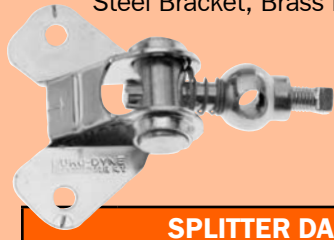

Splitter Damper Hardware

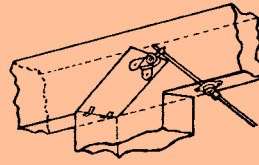
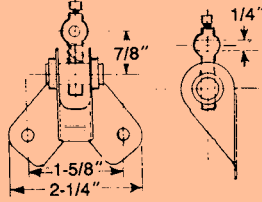

Typical Application Using Ball Joint and Damper Bracket

Ball Joint Damper Casting
Cast Alloy

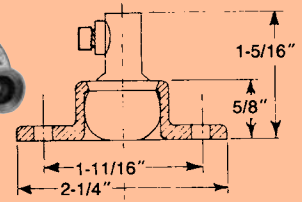

SPLITTER DAMPER		
ITEM#	MODEL	SHAFT SIZE
8034	SRP40	1/4"
8035	SRP50	5/16"
Packed 25 Per Carton		

BALL JOINT		
ITEM#	MODEL	SHAFT SIZE
8032	SRP14	1/4"
8033	SRP516	5/16"
Packed 25 Per Carton		

QUADLINE DAMPER QUADRANTS

SETS AND PARTS

3/8" QUADRANT SETS (FOR DAMPERS UP TO 20")



Stands Off Duct
1-1/8"

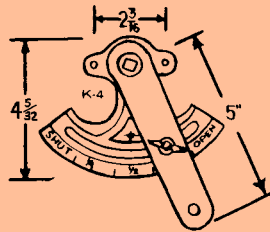

These heavy gauge Plated Steel quadrants are designed with excellent handle action as well as quick wing nut adjustment and locking of the damper. The frame is marked to show the exact position of the damper. For use on square or round ducts.

3/8" QUADRANT SETS		
ITEM#	MODEL	SET CONSISTS OF:
8050	KS38	K-4 quadrant; KP-9R round end bearing; KP-9S square end bearing
8051	KS385	K-4 quadrant; KP-7 spring loc bearing; KP-9S long square end bearing
8049	KS385L	K-4 quadrant; KP-7L long spring loc bearing; KP-9L long square end bearing
Packed 1 Set Per Carton		
8059	K4	3/8" quadrant only
Packed 100 per Carton		

1/2" QUADRANT SETS (FOR DAMPERS UP TO 30")

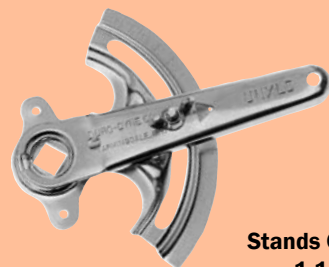

Stands Off Duct
1-1/8"

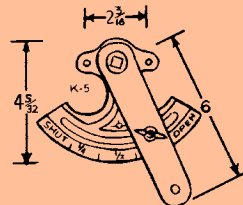

These heavy gauge Plated Steel quadrants are designed with excellent handle action as well as quick wing nut adjustment and locking of the damper. The frame is marked to show the exact position of the damper. For use on square or round ducts.

1/2" QUADRANT SETS		
ITEM#	MODEL	SET CONSISTS OF:
8052	KS12	K-5 quadrant; KP-10R round end bearing; KP-10S square end bearing
Packed 1 Set Per Carton		
8060	K5	1/2" quadrant only
Packed 100 per Carton		

1/2" SHAFT LOC QUADRANT SETS (FOR DAMPERS UP TO 30")



Stands Off Duct
1-3/16"

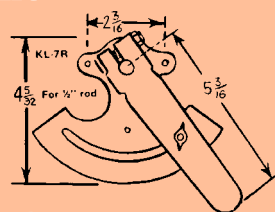

"Shaft Loc" Quadrants are stamped of heavy gauge steel and clearly indicate the position of the damper. The quadrant handle (available for either 1/2" square or round shafts) is unique in that it locks the shaft of the damper to it by means of a powerful friction holding device strong enough to cut into the damper shaft eliminating damper rattle. The shaft is easily locked with 1/2" open end wrench. Available for square or round ducts.

1/2" SHAFT LOC QUADRANT SETS		
ITEM#	MODEL	SHAFT DESCRIPTION
8063	KL7	1/2" square Shaft loc quadrant
8064	KL7R	1/2" round Shaft loc quadrant
Packed 100 Per Carton		