

Forged Steel Fittings

Class 6000 Threaded

Malleable Iron

Cast Iron

Small Steel Fittings

Pipe Nipples & Pipe Couplings

Forged Steel Fittings & Unions

Anvilets

Catawissa

J.B. Smith Products

Carton Information

FIGURE 2135
Crosses

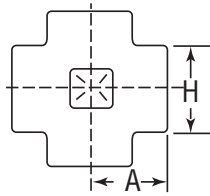

Size		A		H		Unit Weight	
NPS	DN	in	mm	in	mm	lbs	kg
1/8	6	0.97	25	1.00	25	0.56	0.25
1/4	8	1.12	28	1.31	33	1.19	0.54
3/8	10	1.31	33	1.50	38	1.50	0.68
1/2	15	1.50	38	1.81	46	2.60	1.18
3/4	20	1.75	44	2.19	56	4.30	1.95
1	25	2.00	51	2.44	62	5.70	2.59
1 1/4	32	2.38	60	2.97	75	9.60	4.35
1 1/2	40	2.50	64	3.31	84	11.40	5.17
2	50	3.25	83	4.00	102	21.40	9.71
2 1/2	65	3.75	95	4.75	121	28.30	12.83
3	80	4.19	106	5.75	146	59.00	26.76
4	100	4.50	114	6.00	152	43.50	19.73

FIGURE 2133
90° Street Elbows

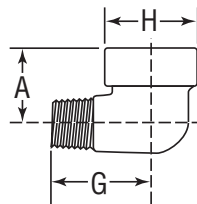

Size		A		G		H		Unit Weight	
NPS	DN	in	mm	in	mm	in	mm	lbs	kg
1/8	6	0.88	22	1.25	32	1.00	25	-	-
1/4	8	1.00	25	1.50	38	1.25	32	0.38	0.17
3/8	10	1.12	28	1.62	41	1.50	38	0.44	0.20
1/2	15	1.38	35	1.88	48	1.75	44	1.10	0.50
3/4	20	1.75	44	2.25	57	2.00	51	1.62	0.73
1	25	2.00	51	2.62	66	2.44	62	2.80	1.27
1 1/4	32	2.12	54	2.81	71	2.75	70	3.80	1.72
1 1/2	40	2.50	64	3.31	84	3.31	84	7.20	3.27

FIGURE 2136
Laterals

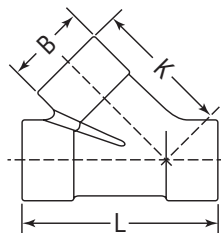

Size		B		K		L		Unit Weight	
NPS	DN	in	mm	in	mm	in	mm	lbs	kg
1/2	15	1.84	46.74	3.00	76.20	4.13	104.90	3.25	1.46
3/4	20	2.22	56.39	3.50	88.90	4.81	122.17	5.44	2.45
1	25	2.50	63.5	3.94	100.08	5.38	136.65	7.19	3.23
1 1/4	32	3.03	76.96	4.75	120.65	6.44	163.58	12.31	5.54
1 1/2	40	3.34	84.84	5.00	127.00	6.63	168.40	-	-