

MODEL

# H312 HDP FLANGE ADAPTER

The **Shurjoint** Model H312 HDP flange adapter provides for the direct transition from HDP pipe and or fittings to ANSI Class 125 or 150 flanged components.

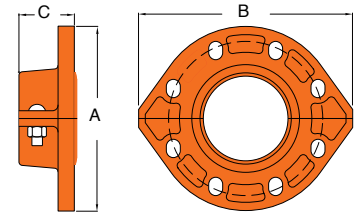

## H312 - IPS Size / ANSI Class 125/150

Nominal Size mm / in	Pipe O. D. mm / in	Dimensions			Flange Bolt		Weight Kgs / Lbs
		A mm / in	B mm / in	C mm / in	No.	Size in	
80	88.9	197	225	79	4	3/8	4.8
3	3.500	7.75	8.86	3.10			10.6
100	114.3	229	260	79	8	3/8	6.8
4	4.500	9.00	10.25	3.10			15.0
150	168.3	279	311	95	8	3/4	9.8
6	6.625	11.00	12.25	3.75			21.5
200	219.1	343	375	87	8	3/4	13.1
8	8.625	13.50	14.75	3.42			28.8
250	273.0	406	533	108	12	7/8	19.5
10	10.750	16.00	21.0	4.25			42.9
300	323.9	483	610	108	12	7/8	23.4
12	12.750	19.02	24.0	4.25			51.5

\* **Shurjoint** recommends the use of a silicone based lubricant for use with the HDP series.

\* Flange bolts and nuts are to be supplied by installer.

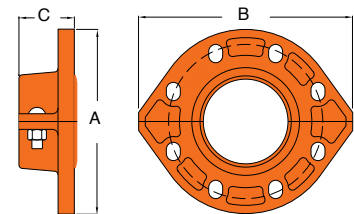
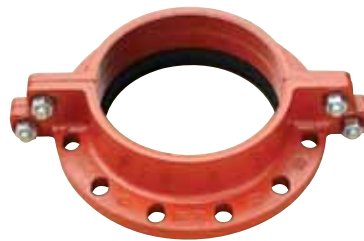

## H312 - ISO Size / PN 10/16

Pipe O. D.		Dimensions			Flange Bolt		Approx. Weight Kgs
HDPE mm	STEEL mm	A mm	B mm	C mm	No.	Size mm	
75	76.1	185	213	79	4	M16	4.3
90	88.9	200	228	79	8	M16	4.8
110	114.3	220	251	79	8	M16	6.8
160	168.3	285	317	95	8	M20	9.8
200	219.1	340	372	87	12 (PN 16)	M20	13.1
250	273.0	405	532	108	12	M24	19.5
315	323.9	460	587	108	12	M24	28.5

\* **Shurjoint** recommends the use of a silicone based lubricant for use with the HDP series.

\* Flange bolts and nuts are to be supplied by installer.