

MODEL

SS-28 STAINLESS STEEL HINGED LEVER COUPLING

The Model SS-28 Hinged Grooved Coupling is designed for quick connect and disconnect services. The housing segments are hinged with a lever handle for easy assembly. Use of the split pin can prevent the accidental opening of the coupling. The Model SS-28 can be used in a wide variety of applications with standard roll- or cut-

grooved pipe. Housings 40mm - 100mm (1½" - 4") feature a smooth outer surface, housings 125mm - 300mm (5" - 12") feature a cross-ribbed design for added strength. Standard gasket: Grade "E" EPDM or Grade "T" Nitrile. Available standard in CF8 (304) or CF8M (316).



Pressure-Temperature Rating

Nom. Rating	Working Pressure (STD. Roll-Grooved)	Max. Service Temperature
Class 150	300 psi @100°F 20 Bar @38°C	EPDM: 230°F / 110°C Nitrile: 180°F / 82°C

*The working pressure shown is based on roll-grooved Sch. 40S pipe. Apply 110% for cut-grooved Sch. 40S pipe. Apply 80% for roll-grooved Sch. 10S pipe and 50% for roll-grooved Sch. 5S pipe.
*Proof test pressure: 1.5 times the working pressure, non-shock cold water.
*Burst pressure is engineered minimum 3 times the working pressure.

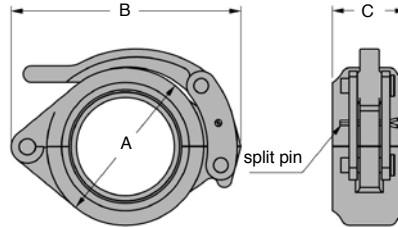

Nominal Size mm / in	Pipe O. D. mm / in	Max. Working Pressure Bar / PSI	Axial Displacement mm / in	Dimensions			Deflection Degree (°)	Weight Kgs / Lbs
				A mm / in	B mm / in	C mm / in		
40	48.3	20	0 - 1.6	75	118	47	3° - 48'	1.0
1½	1.900	300	0 - 0.06	2.95	4.65	1.85		2.2
50	60.3	20	0 - 1.6	86	121	48	3° - 31'	1.1
2	2.375	300	0 - 0.06	3.39	4.76	1.89		2.4
65	73.0	20	0 - 1.6	92	150	48	2° - 30'	1.4
2½	2.875	300	0 - 0.06	3.62	5.91	1.89		3.1
76.1mm	76.1	20	0 - 1.6	92	150	48	2° - 24'	1.4
	3.000	300	0 - 0.06	3.62	5.91	1.89		3.1
80	88.9	20	0 - 1.6	119	163	48	2° - 24'	1.8
3	3.500	300	0 - 0.06	4.69	6.42	1.89		4.0
100	114.3	20	0 - 3.2	165	205	52	3° - 12'	2.7
4	4.500	300	0 - 0.13	6.50	8.07	2.05		5.9
125	139.7	20	0 - 3.2	189	253	52	2° - 37'	4.9
5	5.500	300	0 - 0.13	7.44	9.96	2.05		10.8
125	141.3	20	0 - 3.2	189	253	52	2° - 36'	4.9
5	5.563	300	0 - 0.13	7.44	9.96	2.05		10.8
165.1mm	165.1	20	0 - 3.2	213	278	52	2° - 14'	5.8
	6.500	300	0 - 0.13	8.39	10.94	2.05		12.8
150	168.3	20	0 - 3.2	216	281	52	2° - 10'	5.8
6	6.625	300	0 - 0.13	8.50	11.06	2.05		12.8

*Deflection or angular movement is the maximum value that a coupling allows under no internal pressure.



Expansion Pipe

Lever handles are factory assembled tight for safety. The use of an expansion pipe will aid the easy opening and closing. Expansion pipes are available upon request.

