

## Insulated Unions: 150# “O” Ring Style

Flat faced type, 150 Class 300 CWP working pressure. Complies with ASTM A197: ANSI B1.20.1.

- Stops Galvanic and Electrolytic Corrosion of Mains and Services.
- Permanent Economical Protection
- Protects against stray or induced currents

150# “O” RING STYLE UNIONS

Size	BMI Part Number	Special Features	Weight	GMI Part Number	Weight	Box Qty.
¾"	1005116		.61	1005117	.63	50
¾"	1005130	Orange Nut	.61	call	n/a	50
1"	1005118		.86	1005119	.88	50
1"	10003110	Orange Nut	.86	call	n/a	50
1¼"	1005120		1.53	1005121	1.53	20
1¼"	1005140	Orange Nut	1.53	call	n/a	20
1½"	1005124		1.76	1005125	1.77	20
1½"	10003111	Orange Nut	1.76	call	n/a	20
2"	1005122		2.72	1005123	2.76	10
2"	1000016	Orange Nut	2.72	call	n/a	10

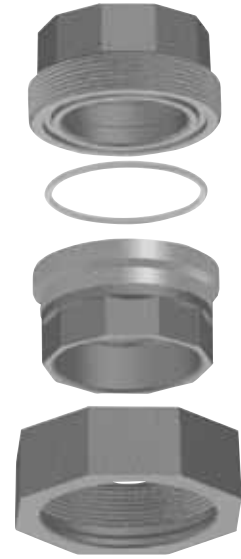

## Insulated Unions: 3000# Forged Steel “O” Ring Style

Flat faced type, 3000 lb. working pressure

Complies with ASTM A105 material specification and ANSI B1.20.1

3000# FORGED STEEL “O” RING STYLE UNIONS

Size	Part Number	Weight	Box Qty.
¼"	108141499001	.36	100
½"	108505010000	.72	50
¾"	108757510000	1.12	30
1"	108010110000	1.62	20
1¼"	108121210000	2.52	10
1½"	108151510000	3.40	5
2"	108020210000	5.36	5
2½"	108252510000	9.69	2
3"	108030310000	13.48	2

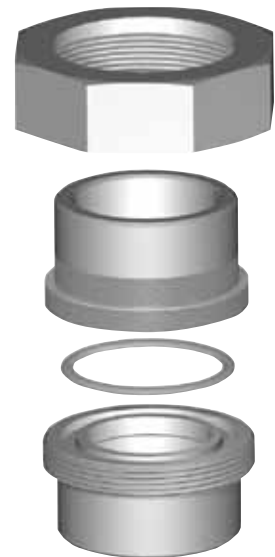

For sizes not listed, call for availability.