

Weld-End Transition Fittings: with PE3408 Gas Pipe

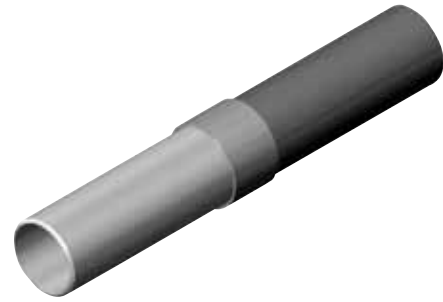

WELD END TRANSITIONS: w/PE3408 GAS PIPE

Size	Description	Part Number	Wt.	Box / Pallet
½" IPS × ½" CTS	.090 BLK 8100	6500640	1.74	30 / 360
¾" IPS × ½" CTS	.090 BLK 8300	6500320	1.52	40 / 640
¾" IPS × ¾" IPS	DR11 BLK 8300	6500321	1.53	40 / 640
1" IPS × 1" IPS	DR11 BLK 8100	6501142	2.26	32 / 512
1" IPS × 1" IPS	DR11 BLK 8300	6500322	3.46	16 / 192
1¼" IPS × 1¼" IPS	DR11 BLK 8100	6501052	3.29	15 / 240
1¼" IPS × 1¼" IPS	DR11 BLK 8300 w/18" SLV	10000745	3.32	16 / 192
1½" IPS × 1¼" IPS	DR11 BLK 8300	6500323	4.36	25 / 300
2" IPS × 2" IPS	DR11 BLK 8100	6501002	5.26	16 / 192
2" IPS × 2" IPS	DR11 BLK 8300 w/24" SLV	6500307	6.87	9 / 108
2" IPS × 2" IPS	DR11 BLK 8300	6500311	6.87	9 / 108
3" IPS × 3" IPS	DR11 BLK 8100	650030300110	13.67	5 / 60
3" IPS × 3" IPS	DR11 BLK 8300	6500522	17.57	4 / 48
4" IPS × 4" IPS	DR11 BLK 8100	6501144	18.87	4 / 48
4" IPS × 4" IPS	DR11 BLK 8300 w/30" SLV	6500308	24.38	4 / 48
4" IPS × 4" IPS	DR11 BLK 8300	6500318	18.80	4 / 48
6" IPS × 6" IPS	DR11 BLK 8100	6501145	45.83	4 / 24
6" IPS × 6" IPS	DR11 BLK 8300	6500576	67.50	1 / 9
8 IPS × 8" IPS	DR11 BLK 8100	6501082	93.80	1 / 9
8 IPS × 8" IPS	DR11 BLK 8300	6500629	127.50	1 / 9
10" IPS × 10" IPS	DR11 BLK 8100	6501083	170.00	1 / 3
10" IPS × 10" IPS	DR11 BLK 8300	6500642	170.00	1 / 3
12" IPS × 12" IPS	DR11 BLK 8300	6500500	241.60	1 / 2

Protective sleeves are available on request.

Please call for sizes and prices.

For transition fittings larger than 12" call for availability and pricing.