

## Fig. 295A

### Alloy Double Bolt Pipe Clamp

**Size Range:** 1½" through 24"

**Material:** Chrome molybdenum steel (ASTM A 387 Grade 22).

**Service:** Recommended for suspension of high temperature pipe requiring insulation.

**Maximum Temperature:** 1,050° F

**Approvals:** Complies with Federal Specification A-A-1192A (Type 3)

WW-H-171-E (Type 3), ANSI/MSS SP-69 and MSS SP-58 (Type 3).

**Features:**

- Sizes 6" and above accommodate up to 4" thick insulation.
- Figure 41SD will accommodate larger insulation thicknesses, loads and dimensions.

**Ordering:** Specify pipe size, figure number and name.

**Note:** Galvanizing is not recommended for alloy products.

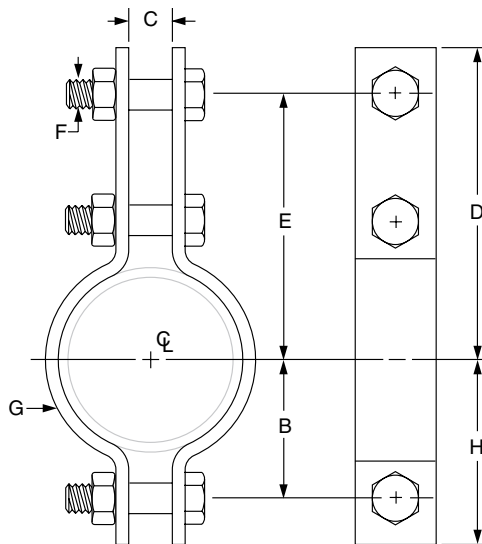

**Note:** This picture is representative of a typical Figure 295A. Distance between clamp ears beneath pipe may or may not be equal to upper gap.

**FIG. 295A: LOADS (LBS) • WEIGHT (LBS) • DIMENSIONS (IN)**

Pipe Size	Max Load ■ For Service Temp				Weight	B	C	D	Rod Take Out E	F	G Width	H
	650° F	750° F	1,000° F	1,050° F								
1½	1,545	1,410	1,000	745	2.3	1 <sup>13</sup> / <sub>16</sub>	1 <sup>1</sup> / <sub>16</sub>	4 <sup>7</sup> / <sub>8</sub>	4 <sup>1</sup> / <sub>8</sub>	5 <sup>5</sup> / <sub>8</sub>	1 <sup>1</sup> / <sub>4</sub>	2 <sup>3</sup> / <sub>8</sub>
2					2.6	2 <sup>1</sup> / <sub>8</sub>		5 <sup>5</sup> / <sub>8</sub>	5 <sup>1</sup> / <sub>8</sub>			2 <sup>11</sup> / <sub>16</sub>
2½					2.7	2 <sup>5</sup> / <sub>16</sub>		6 <sup>1</sup> / <sub>8</sub>	5 <sup>3</sup> / <sub>8</sub>			2 <sup>15</sup> / <sub>16</sub>
3					3.0	2 <sup>3</sup> / <sub>4</sub>		6 <sup>11</sup> / <sub>16</sub>	5 <sup>15</sup> / <sub>16</sub>			3 <sup>1</sup> / <sub>2</sub>
4					6.7	3 <sup>3</sup> / <sub>8</sub>		7 <sup>5</sup> / <sub>8</sub>	6 <sup>1</sup> / <sub>2</sub>			4 <sup>1</sup> / <sub>2</sub>
5	2,500	2,290	1,625	1,200	7.0	3 <sup>15</sup> / <sub>16</sub>	1 <sup>7</sup> / <sub>16</sub>	8 <sup>1</sup> / <sub>8</sub>	7	3 <sup>3</sup> / <sub>4</sub>	2	5
6					11.5	4 <sup>3</sup> / <sub>4</sub>		9 <sup>15</sup> / <sub>16</sub>	8 <sup>9</sup> / <sub>16</sub>			6 <sup>1</sup> / <sub>8</sub>
8					13.2	5 <sup>3</sup> / <sub>4</sub>		10 <sup>15</sup> / <sub>16</sub>	9 <sup>9</sup> / <sub>16</sub>			7 <sup>7</sup> / <sub>8</sub>
10	3,240	2,970	2,100	1,565	19.8	7 <sup>1</sup> / <sub>16</sub>	1 <sup>7</sup> / <sub>16</sub>	12	10 <sup>5</sup> / <sub>8</sub>	1	2 <sup>1</sup> / <sub>2</sub>	8 <sup>1</sup> / <sub>4</sub>
12					22.3	8 <sup>1</sup> / <sub>16</sub>		13	11 <sup>5</sup> / <sub>8</sub>			9 <sup>5</sup> / <sub>16</sub>
14	4,300	3,915	2,795	2,060	37.7	9 <sup>1</sup> / <sub>16</sub>	2	14 <sup>5</sup> / <sub>16</sub>	12 <sup>1</sup> / <sub>16</sub>	1 <sup>1</sup> / <sub>4</sub>	3	10 <sup>1</sup> / <sub>16</sub>
16					41.4	10 <sup>1</sup> / <sub>16</sub>		15 <sup>5</sup> / <sub>16</sub>	13 <sup>1</sup> / <sub>16</sub>			11 <sup>1</sup> / <sub>16</sub>
18					44.9	11 <sup>1</sup> / <sub>16</sub>		16 <sup>5</sup> / <sub>16</sub>	14 <sup>1</sup> / <sub>16</sub>			12 <sup>1</sup> / <sub>16</sub>
20					57.3	12 <sup>3</sup> / <sub>8</sub>		17 <sup>1</sup> / <sub>2</sub>	15 <sup>7</sup> / <sub>8</sub>			14
24	65.9	14 <sup>3</sup> / <sub>8</sub>	19 <sup>1</sup> / <sub>2</sub>	17 <sup>7</sup> / <sub>8</sub>	1 <sup>3</sup> / <sub>8</sub>	16						

■ Based on the allowable stresses shown in the ASME Code for Pressure Piping.

- Pictorial Table of Contents
- General Notes
- Copper Tubing Hangers
- CPVC Pipe Hangers
- Pipe Rings
- Clevis Hangers
- Steel Pipe Clamps
- Socket Clamps
- Beam Clamps
- Structural Attachments
- Brackets
- Ceiling Plates & Flanges
- Concrete Inserts & Attachments
- Hanger Rods
- Rod Attachments
- Bolts, Nuts, Pins & U-Bolts