

MODEL

# SJ-915 DUAL DISC CHECK VALVE

The **Shurjoint** Model SJ-915 is a grooved-end dual-plate (or double-door) check valve designed to provide positive and silent protection against backflow in piping systems. The valve features a ductile iron

body with an EPDM or Nitrile (NBR) resilient seat molded to the body and type 304 stainless steel discs loaded with type 313 stainless steel springs.

### Pressure-Temperature Rating

Nom. Rating	Working Pressure	Shell Test	Max. Service Temperature
Class 150	300 psi @100°F 20 Bar @38°C	450 psi 30 Bar	EPDM: 230°F / 110°C Nitrile: 180°F / 82°C

\*Working pressure is based on connection with roll- or cut-grooved standard wall carbon steel pipe.

\*Seat test: 110% the working pressure.

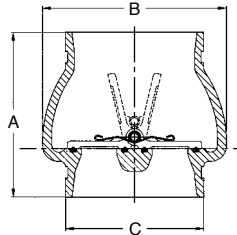

Size: 2½"~12"

Nominal Size mm / in	Pipe O. D. mm / in	Dimensions			Approx. Weight Kgs / Lbs
		A mm / in	B mm / in	C mm / in	
65	73.0	125	110	73	2.3
2½	2.875	4.92	4.33	2.87	5.0
80	88.9	135	125	89	2.5
3	3.500	5.31	4.92	3.50	5.5
100	114.3	137	152	114	3.8
4	4.500	5.39	5.98	4.50	8.4
150	168.3	152	204	168	7.6
6	6.625	6.00	8.03	6.62	11.7
200	219.1	171	256	219	12.4
8	8.625	6.73	10.08	8.62	27.3
250	273.0	198	307	273	20.7
10	10.750	7.80	12.09	10.75	45.5
300	323.9	208	362	324	28.3
12	12.750	8.19	14.25	12.75	62.2

The **Shurjoint** Model SJ-915 is also available in sizes 14" to 24" / 350mm to 600mm. Face-to-face dimensions conform to API 594 Class 150 and grooved ends to ANSI/AWWA C606.

### Pressure-Temperature Rating

Nom. Rating	Working Pressure	Shell Test	Max. Service Temperature
Class 150	250 psi @100°F 17 Bar @38°C	400 psi 26 Bar	EPDM: 230°F / 110°C Nitrile: 180°F / 82°C

\*Working pressure is based on connection with roll- or cut-grooved standard wall carbon steel pipe.

\*Seat test: 110% the working pressure.

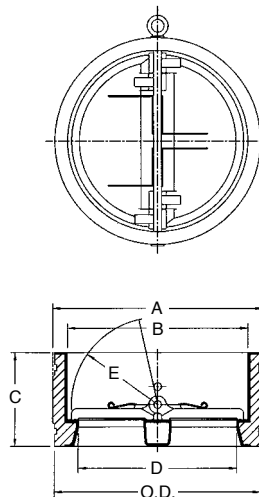

Size: 14"~24"

Nominal Size mm / in	Pipe O. D. mm / in	Dimensions					Approx. Weight Kgs / Lbs
		A mm / in	B mm / in	C mm / in	D mm / in	E mm / in	
350	355.6	368	329	184	283	154	46.0
14	14.000	14.49	12.96	7-1/4	11.14	6.06	101.2
400	406.4	410	359	191	310	173	54.0
16	16.000	16.14	14.13	7-1/2	12.20	6.81	118.8
450	457.2	461	417	203	364	203	77.0
18	18.000	18.15	16.42	8	14.33	8.00	169.4
500	508.0	509	460	219	408	226	96.0
20	20.000	20.04	18.11	8-5/8	16.06	8.80	211.2
600	609.6	610	562	222	457	249	131.0
24	24.000	24.00	22.13	8-3/4	18.00	9.80	288.2