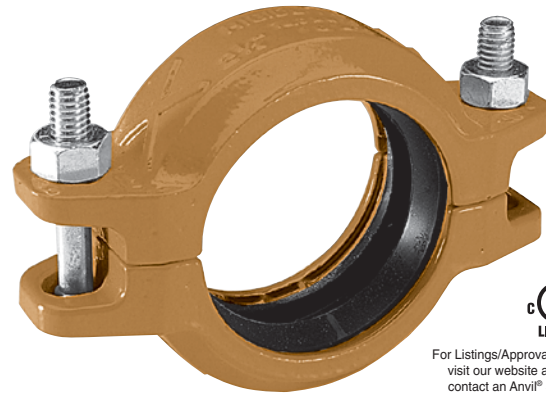

FIG. 7400
Rigidlite® Coupling

The Fig. 7400 Rigidlite Coupling provides a rigid, locked-in connection to meet the specific demands of copper tubing installation. Available with the Grade “E”, EPDM “C” style gasket as the standard gasket. The Rigidlite Coupling maintains a rigid connection, on copper piping systems.

Go to technical data section for installation instructions.



For Listings/Approval Details and Limitations, visit our website at www.anvilint.com or contact an Anvil® Sales Representative.

MATERIAL SPECIFICATIONS

ANSI BOLTS & HEAVY HEX NUTS:

Heat treated, oval neck track head bolts conforming to ASTM A 183 Grade 2 with a minimum tensile strength of 110,000 psi and heavy hex nuts of carbon steel conforming to ASTM A 563 Grade A or Grade B, or J995 Grade 2. Bolts and nuts are provided zinc electroplated as standard.

METRIC BOLTS & HEAVY HEX NUTS:

Heat treated, zinc electroplated oval-neck track head bolts made of carbon steel with mechanical properties per ISO 898-1 Class 8.8. Hex nuts and bolts are zinc electroplated followed by a yellow chromate dip.

STAINLESS STEEL BOLTS & NUTS:

Stainless steel bolts and nuts are also available. Contact an Anvil Representative for more information.

HOUSING:

Ductile Iron conforming to ASTM A 536, Grade 65-45-12.

COATINGS:

Rust inhibiting paint Color: ORANGE (standard)
Hot Dipped Zinc Galvanized (optional)
Other Colors Available (IE: RAL3000 and RAL9000)
For other Coating requirements contact an Anvil Representative.

GASKETS: Materials

Properties as designated in accordance with ASTM D 2000

Grade “E” EPDM (Green color code) NSF 61 Certified

-40°F to 190°F (Service Temperature Range)(-40°C to 88°C)
Recommended for water service, diluted acids, alkalis solutions, oil-free air and many chemical services.
NOT FOR USE IN PETROLEUM APPLICATIONS.

Grade “EP” EPDM (Green and Red color code) NSF 61 Certified

-40°F to 190°F (Service Temperature Range)(-40°C to 88°C)
Recommended for water service, diluted acids, alkalis solutions, oil-free air and many chemical services.
NOT FOR USE IN PETROLEUM APPLICATIONS.

LUBRICATION:

Gruvlok Xtreme™ lubricant only

NOTE: Lubricant is to be applied to the entire surface, both internal and external of the gasket. For additional important information concerning Gruvlok Xtreme™ Lubricant see Gruvlok Data Sheet 3 “Gruvlok Lubricants”.

Contact an Anvil Representative for additional details.

FIGURE 7400 RIGIDLITE COUPLING

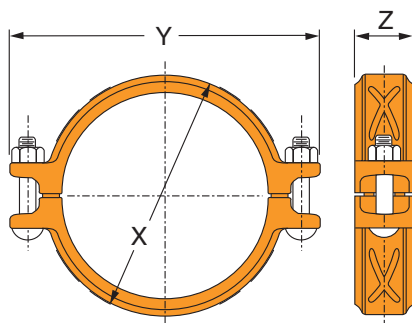

Nominal Size	O.D.	Range of Pipe End Separation	Coupling Dimensions			Coupling Bolts		Specified Torque §		Approx. Wt. Ea.
			X	Y	Z	Qty.	Size.	Min.	Max	
In./DN(mm)	In./mm	In./mm	In./mm	In./mm	In./mm		In./mm	Ft. -Lbs./N-m		Lbs./Kg
2	2.375	0 - 1/32	3/4	5 1/2	1 3/4	2	3/8 x 2 1/4	30	45	1.6
50	60.3	0 - 0.79	83	140	44		M10 x 57	40	60	0.7
2 1/2	2.875	0 - 1/32	3/8	5	1 3/4	2	3/8 x 2 1/4	30	45	1.9
65	73.0	0 - 0.79	98	127	44		M10 x 57	40	60	0.9
3	3.500	0 - 1/32	4 1/2	6 3/4	1 3/4	2	3/8 x 2 3/4	30	45	2.1
80	88.9	0 - 0.79	114	171	44		M10 x 70	40	60	1.0
4	4.500	0 - 3/32	5 5/8	7 3/4	1 7/8	2	3/8 x 2 3/4	30	45	3.1
100	114.3	0 - 2.38	143	197	48		M10 x 70	40	60	1.4
5	5.563	0 - 3/32	6 1/8	9 1/4	2	2	1/2 x 3	80	100	4.6
125	141.3	0 - 2.38	175	235	51		M12 x 76	110	150	2.1
6	6.625	0 - 3/32	7 7/8	10 5/8	2	2	1/2 x 3	80	100	5.5
150	168.3	0 - 2.38	200	264	51		M12 x 76	110	150	2.5
8	8.625	0 - 3/32	10 1/4	12 3/4	2 5/8	2	1/2 x 3	80	100	8.4
200	219.1	0 - 2.38	260	324	60		M12 x 76	110	150	3.8

NOTE:
Range of Pipe End Separation values are for roll grooved pipe.

For additional details see “Coupling Data Chart Notes” on page 17.
§ – For additional Bolt Torque information, see page 190.
See Installation & Assembly directions on page 160.