

Fig. 108

Split Pipe Ring

Size Range: 3/8" through 8"

Material: Malleable iron

Finish: Plain

Service: Recommended for suspension of non-insulated **stationary** pipe lines or conduit. May be used with rod socket Fig. 110R or turnbuckle adjuster Fig. 114.

Maximum Temperature: 450° F

Approvals: Complies with Federal Specification A-A-1192A (Type 11) WW-H-171-E (Type 11), ANSI/MSS SP-69 and MSS SP-58 (Type 11).

Features:

- Permits installation before or after pipe is in place.
- Provides economical installation.
- Permits use of universally adaptable parts.

Ordering: Specify pipe size, figure number, name.

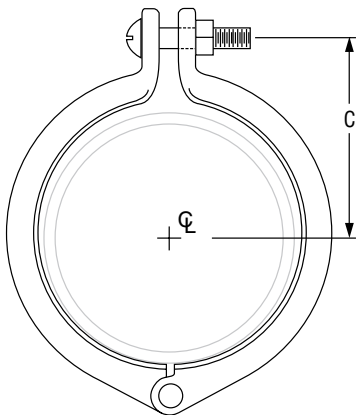

**FIGURE 108:
LOADS (LBS) • WEIGHT (LBS) • DIMENSIONS (IN)**

Pipe Size	Max Load	Weight	C	Bolt Size
3/8	200	0.06	3/4	#10 x 7/8
1/2		0.09	15/16	
3/4	300	0.11	1 1/8	
1		0.13	1 1/4	
1 1/4		0.18	1 9/16	
1 1/2		0.26	1 11/16	
2	450	0.33	2 1/16	1/4 x 1 1/4
2 1/2		0.44	2 1/4	
3		0.63	2 3/4	
3 1/2		0.81	3 1/8	
4	520	0.97	3 5/8	3/8 x 2
5		1.50	4 1/2	
6	1,300	2.60	5 7/16	1/2 x 2
8	1,800	5.20	6 3/8	