

Threaded Fittings & Welding Outlets

Shurjoint offers a complete range of ductile iron Class 300 threaded fittings in sizes from 1/2" to 2 1/2". Shurjoint ductile iron threaded fittings are 100% air tested underwater to ensure leak-free performance. The Shurjoint ductile iron fitting series is UL listed and FM approved, making them the right choice for fire protection and other general application services.



Ductile Iron Class 300 threaded fittings are designed to the same dimensions as that of Class 150 malleable iron fittings. Though due to the superior strength characteristics, ductile iron fittings carry a much higher pressure rating. Laboratory tests confirm Shurjoint ductile iron fittings have passed hydrostatic test pressures exceeding 6,000 psi / 414 Bar, which is equal to four times the 1,500 psi / 103 Bar as specified by ANSI B16.3 for 1-1/2" – 2" sizes.



Burst pressure testing of DI threaded fittings (2")

Pressure-Temperature Rating (ANSI B16.3 & B16.14)

Nom. Rating	Working Pressure (W.O.G.) @ 150°F / @65°C	Working Pressure Saturated Steam
Class 300	1/2" – 1" : 2000 psi / 140 Bar	300 psi (20 Bar)
	1 1/4" – 2" : 1500 psi / 105 Bar	
	2 1/2" : 1000 psi / 70 Bar	

*Proof test pressure: 1.5 times the working pressure, non-shock cold water.

Pressure-Temperature Rating Unions, Brass to Iron Seat (ANSI B16.39)

Nom. Rating	Working Pressure (W.O.G.) @ 150°F / @65°C	Working Pressure Saturated Steam
Class 300	600 psi / 42 Bar	300 psi (20 Bar)

*Proof test pressure: 1.5 times the working pressure, non-shock cold water.

*Max. Temperature: 450°F (ASME Boiler Code)

Pressure-Temperature Rating Companion Flanges (ANSI B16.42)

Nom. Rating	Working Pressure (W.O.G.) @ 150°F / @65°C	Working Pressure Saturated Steam
Class 150	250 psi / 17 Bar	150 psi (10 Bar)

*Proof test pressure: 1.5 times the working pressure, non-shock cold water.

Material: Ductile iron ASTM A536 Gr. 65-45-12

Dimensions: ANSI B16.3 Class 150 except bushings and plugs (B16.14), unions (B16.39) and companion flanges (B16.42)

Threads: ANSI B1.20.1 NPT or ISO-7 (BSPT)

Finish: Black or electro-zinc plated

Welding Outlets

Shurjoint welding outlets provide an easy branch outlet at any desired location along the header pipe. Available in a variety of size and configurations including threaded, cut grooved and roll grooved ends. Welding outlets are UL listed and FM approved for fire protection applications.

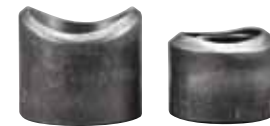

Pressure-Temperature Rating

Nom. Rating	Working Pressure (W.O.G.) @ 150°F / @65°C	Working Pressure Saturated Steam
Class 300	600 psi / 42 Bar	300 psi (20 Bar)

*Proof test pressure: 1.5 times the working pressure, non-shock cold water.

*Burst test pressure: Minimum 3 times the working pressure.

General Dimensions

These dimensions apply to all standard fittings, both straight and reducing. For center-to-face dimensions(*), see fitting tables.

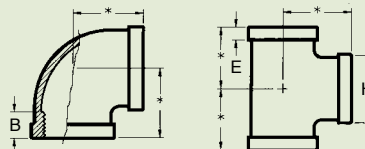

Pipe Size	H Band O.D.	E Band Width	B Thread Length (min.)
in	in	in	in
1/2	1.02	0.25	0.43
3/4	1.46	0.27	0.50
1	1.77	0.30	0.58
1 1/4	2.15	0.34	0.67
1 1/2	2.43	0.37	0.70
2	2.96	0.42	0.75
2 1/2	3.59	0.48	0.92