

COUPLING • ECCENTRIC

COPPER PRESSURE

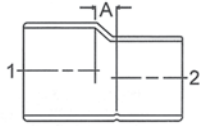

WROT	WROT		CONNECTION			CAST			
	ELKHART	CAST	C x C			CE-100*			
110		N/A	WROT	NIBCO	CAST				
			N/A		702				
	Nominal Size		Part	Box	Master	Approx.	Dimensions		
I	2	3	Number	Qty.	Qty.	Net.Wt.	A	B	C
	3/4"	1/2"	A 04340*	50	250	.11	7/32		
	1"	3/4"	A 04341*	25	250	.18	1/4		
	1-1/4"	1"	A 04342*	10	100	.25	1/4		
	1-1/4"	3/4"	A 04343*	10	100	.24	9/32		

COUPLING • HIGH EAR

COPPER PRESSURE

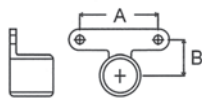

WROT	WROT		CONNECTION			CAST			
	ELKHART	CAST	C			C-100HE*			
N/A		N/A	WROT	NIBCO	CAST				
			N/A		724-5-A				
	Nominal Size		Part	Box	Master	Approx.	Dimensions		
I	2	3	Number	Qty.	Qty.	Net.Wt.	A	B	C
	1/2"		A 03067*	100	1,000	.06	1	5/8	23/32
	3/4"		A 03068*	25	500	.09	1	5/8	27/32
	1"		A 03071*	25	250	.13	1	5/8	1

CROSS

COPPER PRESSURE

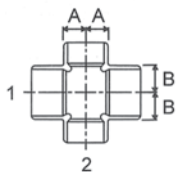

WROT	WROT		CONNECTION			CAST			
	ELKHART	CAST	C x C x C x C			T-312*			
N/A		4735	WROT	NIBCO	CAST				
			N/A		735				
	Nominal Size		Part	Box	Master	Approx.	Dimensions		
I	2	3	Number	Qty.	Qty.	Net.Wt.	A	B	C
	1/2"		A 02532*	25	250	.14	1/2	1/2	
	3/4"		A 02579*	10	100	.3	9/16	9/16	
	1"		A 02612*	5	100	.54	23/32	23/32	
	1-1/4"		A 02649*	5	50	.74	7/8	7/8	
	1-1/2"		A 02672*	1	50	1.05	1	1	
	2"		A 02707*	1	25	2.00	1-1/4	1-1/4	
	2-1/2"		A 02734*	1	15	2.91	1-1/2	1-1/2	

45° ELBOW

COPPER PRESSURE



WROT	WROT		CONNECTION			CAST			
	ELKHART	CAST	C x C			E-204*			
106		N/A	WROT	NIBCO	CAST				
			606		706				
	Nominal Size		Part	Box	Master	Approx.	Dimensions		
I	2	3	Number	Qty.	Qty.	Net.Wt.	A	B	C
	1/8"		W 03005	50	1,700	.01	3/16		
	1/4"		W 03012	50	1,700	.01	3/16		
	3/8"		W 03021	25	850	.02	13/64		
	1/2"		W 03026	50	500	.04	17/64		

