

# Variable area flow meters

## Insert PVDF (3,4)

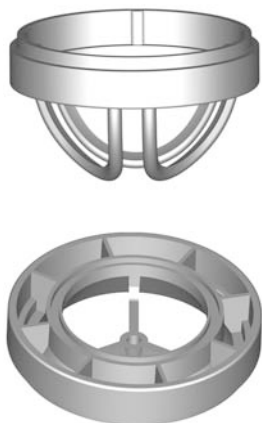

Scale range [l/h]	d [mm]	Inch	DN [mm]	top (4) Code	bottom (3) Code
50 - 500	32	1	25	198 335 970	198 335 977
100 - 1000	32	1	25	198 335 970	198 335 977
150 - 1500	40	1 ¼	32	198 335 971	198 335 978
250 - 2500	40	1 ¼	32	198 335 971	198 335 978
200 - 2000	50	1 ½	40	198 335 972	198 335 979
300 - 3000	50	1 ½	40	198 335 972	198 335 979
600 - 6000	50	1 ½	40	198 335 972	198 335 979
600 - 6000	63	2	50	198 335 973	198 335 980
1000 - 10000	63	2	50	198 335 973	198 335 980
1500 - 15000	63	2	50	198 335 974	198 335 981
2000 - 20000	75	2 ½	65	198 335 975	198 335 981
3000 - 30000	75	2 ½	65	198 335 975	198 335 981
8000 - 60000	75	2 ½	65	198 335 975	198 335 981

## Float PVDF (2)



Scale range [l/h]	d [mm]	Inch	DN [mm]	Without magnet Code	With magnet Code
50 - 500	32	1	25	198 335 455	198 335 470
100 - 1000	32	1	25	198 335 455	198 335 470
150 - 1500	40	1 ¼	32	198 335 455	198 335 470
250 - 2500	40	1 ¼	32	198 335 455	198 335 470
200 - 2000	50	1 ½	40	198 335 456	198 335 471
300 - 3000	50	1 ½	40	198 335 457	198 335 471
600 - 6000	50	1 ½	40	198 335 457	198 335 471
600 - 6000	63	2	50	198 335 457	198 335 471
1000 - 10000	63	2	50	198 335 457	198 335 471
1500 - 15000	63	2	50	198 335 458	198 335 472
2000 - 20000	75	2 ½	65	198 335 459	198 335 473
3000 - 30000	75	2 ½	65	198 335 459	198 335 473
8000 - 60000	75	2 ½	65	198 335 460	198 335 474

## Guiding rod PEEK (10)



### Model:

- Only for DN50 (1'500 - 15'000 l/h) and DN65 (all metering ranges)

Scale range [l/h]	d [mm]	Inch	DN [mm]	Guiding rod Code
1500 - 15000	63	2	50	198 350 980
2000 - 20000	75	2 ½	65	198 350 980
3000 - 30000	75	2 ½	65	198 350 980
8000 - 60000	75	2 ½	65	198 350 980

## Insert guiding rod PVDF (for 10)



### Model:

- Only for DN50 (1'500 - 15'000 l/h) and DN65 (all metering ranges)

Scale range [l/h]	d [mm]	Inch	DN [mm]	Insert guiding rod Code
1500 - 15000	63	2	50	198 335 986
2000 - 20000	75	2 ½	65	198 335 987
3000 - 30000	75	2 ½	65	198 335 987
8000 - 60000	75	2 ½	65	198 335 987