

# Flange Adaptors, Flanges and Gaskets for Socket Fusion

27 79 02

## PROGEF Standard flange adaptor Jointing face flat/serrated

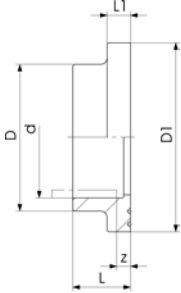

### Model:

- Material: PP-H
- Counterpart: Flange Adaptor flat/serrated or with O-ring groove
- Connection: according to EN ISO 15494-1
- Gasket: Profile flange gasket EPDM No. 48 44 07, FPM No. 49 44 07
- Flanges: PP with steel core, No. 27 70 02, PP-V, No. 27 70 04

d [mm]	DN [mm]	PN	Code	kg	D [mm]	D1 [mm]	L [mm]	L1 [mm]	z [mm]
20	15	10	<b>727 790 206</b>	0.011	27	45	19	7	5
25	20	10	<b>727 790 207</b>	0.022	33	58	21	9	5
32	25	10	<b>727 790 208</b>	0.033	41	68	23	10	5
40	32	10	<b>727 790 209</b>	0.046	50	78	25	11	5
50	40	10	<b>727 790 210</b>	0.062	61	88	28	12	5
63	50	10	<b>727 790 211</b>	0.090	76	102	32	14	5
75	65	10	<b>727 790 212</b>	0.163	90	122	36	16	5
90	80	10	<b>727 790 213</b>	0.233	108	138	42	17	7
110	100	10	<b>727 790 214</b>	0.319	131	158	48	18	7

27 79 02

## PROGEF Standard flange adaptor Jointing face serrated ANSI

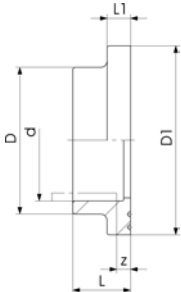

### Model:

- Material: PP-H
- Counterpart: Flange adaptor serrated
- Gasket: Profile flange gasket EPDM No. 48 44 05, FPM No. 49 44 05
- Flanges: PP with steel core, No. 27 70 02, PP-V, No. 27 70 04

d [mm]	PN	Code	kg	D [mm]	D1 [mm]	L [mm]	L1 [mm]	z [mm]
25	10	<b>727 790 257</b>	0.019	33	54	21	7	5
32	10	<b>727 790 258</b>	0.028	41	63	23	7	5
40	10	<b>727 790 259</b>	0.040	50	73	25	8	5
50	10	<b>727 790 260</b>	0.053	61	82	28	8	5
90	10	<b>727 790 263</b>	0.233	108	133	36	16	5