

# Flange Adaptors, Flanges and Gaskets for Butt Fusion

27 79 87

## PROGEF Standard flange adaptor S5/SDR11 Combined jointing face: flat and serrated

**Model:**

- Material: PP-H
- Conventional butt-welding according to DVS 2207 part 11
- IR = Infrared-(IR Plus®) compatible. Please choose fusion parameters: PP-H
- Suitable for flange connections to metric (from d110 also to ANSI/ASME B16.5)
- Up to d315, suitable for butterfly valve type 567,568 and 037
- Gasket: Profile flange gasket EPDM No. 48 44 07, FPM No. 49 44 07

\* **Type B with chamfer**

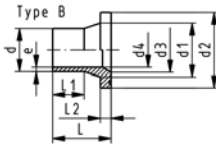
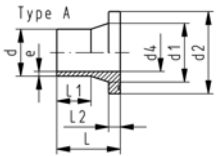

d [mm]	DN [mm]	FM	Code	kg	d1 [mm]	d2 [mm]	d3 [mm]	d4 [mm]	L [mm]	L1 [mm]	L2 [mm]	e [mm]
20	15	IR	<b>727 798 706</b>	0.015	26	45		16	50	29	7	1.9
25	20	IR	<b>727 798 707</b>	0.028	32	58		20	52	27	9	2.3
32	25	IR	<b>727 798 708</b>	0.042	40	68		26	54	28	10	2.9
40	32	IR	<b>727 798 709</b>	0.064	49	78		32	56	25	11	3.7
50	40	IR	<b>727 798 710</b>	0.088	60	88		40	62	32	12	4.6
63	50	IR	<b>727 798 711</b>	0.144	75	102		51	68	38	14	5.8
* 75	65	IR	<b>727 798 712</b>	0.243	89	122	66	61	80	43	16	6.9
* 90	80	IR	<b>727 798 713</b>	0.326	105	138	78	73	80	41	17	8.2
* 110	100	IR	<b>727 798 714</b>	0.441	125	158	100	90	80	40	18	10.0
* 125	100	IR	<b>727 798 715</b>	0.520	132	158	114	102	82	35	25	11.4
* 140	125	IR	<b>727 798 716</b>	0.800	155	188	127	114	89	39	25	12.8
* 160	150	IR	<b>727 798 717</b>	0.920	175	212	151	131	92	45	25	14.6
* 180	150	IR	<b>727 798 718</b>	0.900	180	212	154	147	80	45	30	16.4
* 200	200	IR	<b>727 798 719</b>	1.670	232	268	203	163	100	30	32	18.2
* 225	200	IR	<b>727 798 720</b>	1.700	235	268	210	184	100	35	32	20.5
* 250	250		<b>727 798 721</b>	2.790	285	320	250	204	100	25	35	22.7
* 280	250		<b>727 798 722</b>	2.610	291	320	265	229	100	35	35	25.4
* 315	300		<b>727 798 723</b>	3.410	335	370	300	257	100	25	35	28.6
* 355	350		<b>727 798 724</b>	5.600	373	430	340	290	180	40	40	32.2
* 400	400		<b>727 798 725</b>	8.300	427	482	385	327	187	46	46	36.3
* 450	400		<b>727 798 726</b>	13.000	514	585	400	368	141	64	60	40.9
* 500	450		<b>727 798 727</b>	13.000	530	587	440	409	138	62	61	45.4

## PROGEF Standard adaptor for butterfly valves SDR11 Jointing face flat, metric



**Model:**

- Material: PP-R
- Conventional butt-welding according to DVS 2207 part 11
- Suitable for most common butterfly valves
- Chamfered and ready for use

Max pressure rating: 10 bar at 20°C water

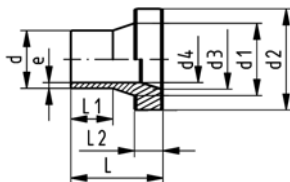

d [mm]	DN [mm]	Code	kg	d1 [mm]	d2 [mm]	d3 [mm]	d4 [mm]	L [mm]	L1 [mm]	L2 [mm]	e [mm]
355	350	<b>727 798 624</b>	3.540	373	430	346	312	180	90	65	32.2
400	400	<b>727 798 625</b>	4.562	427	482	404	352	196	95	69	36.3
450	450	<b>727 798 626</b>	6.100	459	533	460	396	195	60	90	40.9
500	500	<b>727 798 627</b>	6.804	530	585	500	440	144	60	47	45.4