

BlazeMaster® Fire Protection Fittings – STANDARD

ADAPTERS

5001-G

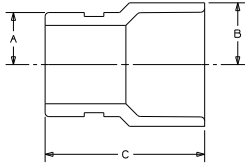

Grooved Coupling Adapters (G x S)

UNIV. FIG. NO.	NOM. SIZE	APPROX. NET WT./LBS.	DIM. A INCHES	DIM. B INCHES	DIM. C INCHES	JOINT
5001-G	1-1/4"	0.17	0.83	1.04	2.98	GXS
5001-G	1-1/2"	0.20	0.95	1.17	3.15	GXS
5001-G	2"	0.30	1.18	1.43	3.37	GXS
5001-G	2-1/2"	0.52	1.43	1.74	3.66	GXS
5001-G	3"	0.72	3.50	—	—	GXS

BUSHINGS

5018

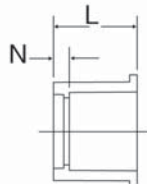

Bushings

UNIV. FIG. NO.	NOM. SIZE	APPROX. NET WT./LBS.	DIM. L INCHES	DIM. N INCHES	JOINT
5018	1"x3/4"	0.04	1.28	0.29	SPGXS
5018	1-1/4"x1"	0.08	1.41	0.29	SPGXS
5018	1-1/4"x3/4"	0.10	1.41	0.41	SPGXS
5018	1-1/2"x1-1/4"	0.07	1.54	0.27	SPGXS
5018	1-1/2"x1"	0.12	1.54	0.39	SPGXS
5018	1-1/2"x3/4"	0.16	1.54	0.53	SPGXS
5018	2"x1-1/2"	0.16	1.66	0.27	SPGXS
5018	2"x1-1/4"	0.20	1.66	0.40	SPGXS
5018	2"x1"	0.22	1.66	0.52	SPGXS
5018	2"x3/4"	0.22	1.66	0.64	SPGXS
5018	2-1/2"x2"	0.24	1.94	0.44	SPGXS
5018	2-1/2"x1-1/2"	0.36	1.94	0.57	SPGXS
5018	2-1/2"x1-1/4"	0.37	1.94	0.68	SPGXS
5018	2-1/2"x1"	0.36	1.94	0.81	SPGXS
5018	3"x2-1/2"	0.47	2.42	0.60	SPGXS
5018	3"x2"	0.66	2.42	0.93	SPGXS
5018	3"x1-1/2"	0.73	2.42	1.03	SPGXS