

ELBOWS *continued*

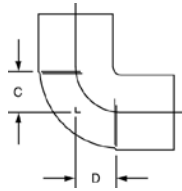

707
90° Elbow – Close Rough
C x C – Cast

| NOM. SIZE | APPROX. NET WT./LBS. | DIM. C INCHES | DIM. D INCHES |
|-------------|----------------------|---------------|---------------|
| 1 1/4 x 1/2 | 0.28 | 15/32 | 27/32 |
| 1 1/4 x 3/4 | 0.34 | 9/16 | 13/16 |
| 1 1/4 x 1 | 0.42 | 15/8 | 115/32 |
| 1 1/2 x 1 | 0.55 | 11/16 | 1 |
| 1 1/2 x 3/4 | 0.45 | 19/32 | 31/32 |
| 1 1/2 x 1/2 | 0.40 | 5/8 | 29/32 |
| 2 x 1 1/4 | 0.86 | 7/8 | 1 1/4 |
| 2 x 1 | 0.78 | 3/4 | 1 1/4 |
| 2 x 3/4 | 0.69 | 5/8 | 1 1/4 |
| 2 1/2 x 2 | 2.16 | 1 3/16 | 19/32 |
| 3 x 2 1/2 | 2.26 | 1 11/16 | 1 1/2 |
| 3 x 2 | 2.68 | 1 3/8 | 1 9/16 |
| 4 x 3 | 5.18 | 1 29/32 | 2 15/32 |

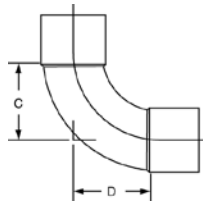

607-1
90° Elbow – Intermediate Radius
C x C – Wrot

| NOM. SIZE | APPROX. NET WT./LBS. | DIM. C INCHES | DIM. D INCHES |
|-----------|----------------------|---------------|---------------|
| 1/2 | 0.05 | 19/32 | 19/32 |
| 5/8 | 0.09 | 7/8 | 7/8 |
| 3/4 | 0.14 | 13/16 | 3/16 |
| 1 | 0.24 | 1 1/16 | 1 1/16 |

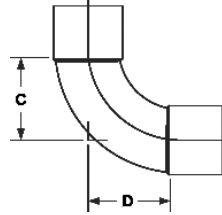

607-LT
90° Elbow – Long Radius
C x C – Wrot

| NOM. SIZE | APPROX. NET WT./LBS. | DIM. C INCHES | DIM. D INCHES |
|-----------|----------------------|---------------|---------------|
| 3/16 O.D. | 0.01 | 13/32 | 13/32 |
| 1/8 | 0.01 | 13/32 | 13/32 |
| 5/16 O.D. | 0.02 | 9/16 | 9/16 |
| 1/4 | 0.02 | 17/32 | 17/32 |
| 1/4 x 1/8 | 0.01 | 19/32 | 1/2 |
| 3/8 | 0.04 | 23/32 | 23/32 |
| 1/2 | 0.08 | 7/8 | 7/8 |
| 1/2 x 3/8 | 0.06 | 13/16 | 13/16 |
| 1/2 x 1/4 | 0.03 | 25/32 | 21/32 |
| 5/8 | 0.11 | 13/32 | 13/32 |
| 5/8 x 1/2 | 0.09 | 1 1/16 | 1 1/16 |
| 3/4 | 0.16 | 1 1/8 | 1 1/8 |
| 3/4 x 5/8 | 0.13 | 1 1/4 | 1 3/32 |
| 3/4 x 1/2 | 0.10 | 1 1/8 | 1 1/16 |
| 7/8 | 0.28 | 1 19/32 | 1 19/32 |
| 1 | 0.28 | 1 7/16 | 1 7/16 |
| 1 x 3/4 | 0.20 | 1 1/4 | 1 1/8 |
| 1 x 5/8 | 0.15 | 1 13/32 | 1 3/32 |
| 1 1/4 | 0.42 | 1 7/8 | 1 7/8 |
| 1 1/4 x 1 | 0.33 | 1 25/32 | 1 1/2 |
| 1 1/2 | 0.66 | 2 1/4 | 2 1/4 |
| 2 | 1.23 | 2 15/16 | 2 15/16 |
| 2 1/2 | 2.15 | 3 11/16 | 3 11/16 |
| 2 1/2 x 2 | 1.53 | — | — |
| 3 | 2.93 | 4 1/32 | 4 1/32 |
| 3 1/2 | 5.63 | — | — |
| 4 | 5.96 | 5 1/4 | 5 1/4 |

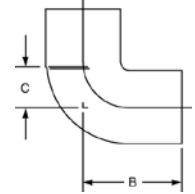

607-2
90° Fitting Elbow – Close Rough
Ftg x C – Wrot

| NOM. SIZE | APPROX. NET WT./LBS. | DIM. B INCHES | DIM. C INCHES |
|-----------|----------------------|---------------|---------------|
| 1/8 | 0.01 | — | — |
| 1/4 | 0.02 | 3/4 | 3/8 |
| 3/8 | 0.03 | 15/16 | 1/2 |
| 1/2 | 0.04 | 31/32 | 3/8 |
| 3/4 | 0.11 | 1 11/32 | 17/32 |
| 1 | 0.20 | 1 3/4 | 27/32 |
| 1 1/4 | 0.28 | 2 1/8 | 1 1/32 |
| 1 1/2 | 0.43 | 2 13/32 | 1 7/32 |
| 2 | 0.82 | 2 27/32 | 1 1/2 |
| 2 1/2 | 1.39 | 3 15/32 | 1 29/32 |
| 3 | 2.10 | 3 13/16 | 2 3/32 |
| 4 | 4.00 | 4 3/4 | 2 25/32 |

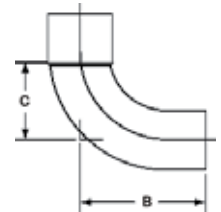

607-2-1
90° Fitting Elbow – Intermediate Radius
Ftg x C – Wrot

| NOM. SIZE | APPROX. NET WT./LBS. | DIM. B INCHES | DIM. C INCHES |
|-----------|----------------------|---------------|---------------|
| 1/2 | 0.05 | 15/32 | 19/32 |
| 5/8 | 0.09 | 19/16 | 7/8 |
| 3/4 | 0.14 | 15/8 | 13/16 |
| 1 | 0.24 | 2 1/32 | 1 1/16 |

Consult price sheet for Made to Order items and for minimum order quantities.