

15 to 1,000 psi (105 to 6,900 kPa)



Description & Features:

- Compact (one piece), lightweight and economical
- CRN registered
- 1 year warranty

Applications:

- Ideally suited for applications where space limitations exist
- Primarily utilized to protect gauges and transmitters from corrosive media
- Utilized in many OEM applications

Specifications	
Housing	AISI 316 SS
Diaphragm	AISI 316L SS, welded
Minimum Operating Pressure	15 psi
Maximum Operating Pressure	1,000 psi (6,900 kPa)
Gauge Connection	1/4", 1/2" NPT female
Process Connection	1/4", 1/2" NPT female
Process Temperature	-49°F to 302°F (-45°C to 150°C)

Order Codes (products in bold are normally in stock)

1/4" NPT x 1/4" NPT	1/4" NPT x 1/2" NPT	1/2" NPT x 1/2" NPT
D40973	D40972	D40974

Option suffix for above order codes only:

SF-D = Silicone fill (seal only)

D40 #40 Diaphragm Seal

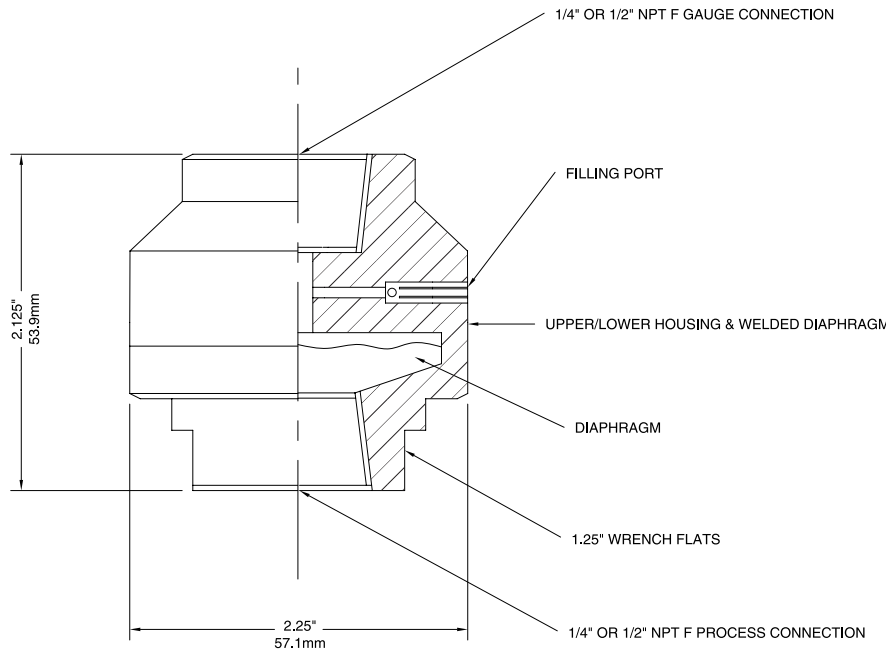

Series Number

	D	4	0	-			-				
SERIES											
GAUGE CONNECTION											
1/4" NPT female					4	N					
3/8" BSP female					3	B					
1/2" BSPT female					2	T					
PROCESS CONNECTION											
1/4" NPT female							4	N			
3/8" BSP female							3	B			
1/2" BSPT female							2	T			
OPTIONS											
1m SS Remote Capillary											1
1.6m SS Remote Capillary											6
2m SS Remote Capillary											2
3m SS Remote Capillary											3
4m SS Remote Capillary											4
5m SS Remote Capillary											5
8m SS Remote Capillary											8
Others											X
No Armour											0
SS Armour											S
Glycerine/water-filled (-10/120C)											A
Silicone-filled (-20/200C)											B
Silicone-filled (-90/100C)											C
Halocarbon (-40/175C)											D
Fluorolube-filled											E
High Temperature Oil (-20/400C)											F