

SL-12

Master Room Controller

NEW



The **SL-12** is a highly versatile controller that acts as an all-in-one extended remote control for control of A/V equipment. It streamlines operations and simplifies control by integrating audio, video, and computer-video sources into a centralized system

FEATURES

- **4 General Purpose I/O Ports** - Can be configured as analog inputs, digital inputs, or digital outputs for interfacing with a variety of devices such as sensors, switches, LEDs, and relays.
- **4 Bidirectional RS-232 Ports** - Control AV equipment such as projectors, LCD and PDP displays, power amplifiers, switchers and scalers.
- **8 Relay Contact Closure Ports** - Conveniently control other room items related to the AV system such as raising and lowering drapes, the screen or the projector.
- **IR Control** - 2 inputs (on two 3.5mm) & 4 outputs (on terminal blocks).
- **IR Learning Function** - Learns commands from any IR remote for customized control of external sources.
- **1 RS-485 Serial Port.**
- **Kramer Site-CTRL™ Compatible** - For network remote control and management using Kramer Site-CTRL software over the Ethernet port.
- **K-NET™ Control Channel** - For connecting compatible user interfaces and supplying power and control data over a single cable.
- **USB Port** - For uploading configuration file.
- **Flexible Control** - Ethernet, K-NET™, RS-485, IR sensor and external IR commands.
- **Compact MultiTOOLS®** - 3 units can be rack mounted side-by-side in a 1U rack space with the optional RK-13 universal rack adapter.

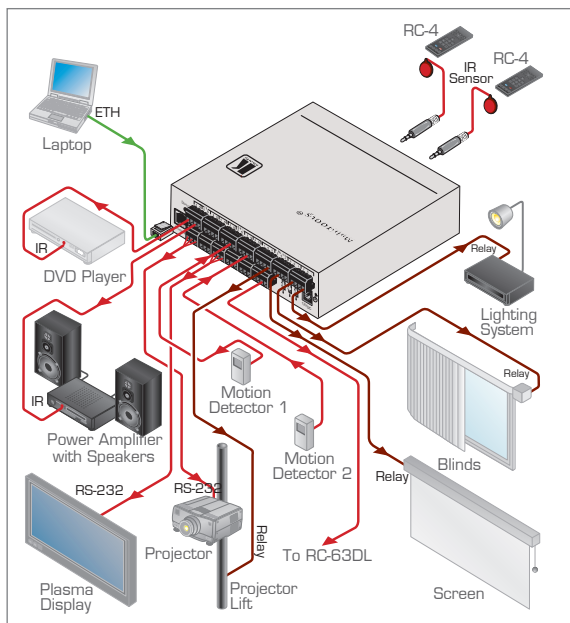

TECHNICAL SPECIFICATIONS

INPUTS:	4 RS-232, RS-485, 4 GPI/O and K-NET™ on terminal block connectors; Ethernet on an RJ-45 connector; 1 infrared sensor, 2 infrared on 3.5mm mini jacks; 1 USB for programming.
OUTPUTS:	4 infrared, 8 relays (36V AC or DC, 2A, 60VAC maximum on non-inductive load) and 4 GPI/O on terminal block connectors.
INDICATORS:	LED indicator for each function.
POWER SOURCE:	12V DC over K-NET™ connection.
DIMENSIONS:	14.3cm x 12.2cm x 4.4cm (5.6" x 4.8" x 1.7") W, D, H.
WEIGHT:	0.6kg (1.4lbs).
ACCESSORIES:	Power supply, Kramer's Windows®-based configuration software, screwdriver.
OPTIONS:	RK-13 19" rack mount, RC-4 remote controller, IR emitter cables.

