

# VA-2H

## HDMI EDID Reader-Emulator

NEW



The **VA-2H** is a diagnostic and debugging tool for installers working with HDMI devices. The unit can switch three different EDIDs to the HDMI input and the USB connection together with a software editor allow the installer to manipulate various parameters of the EDID.

### FEATURES

- Max. Data Rate - Up to 2.25Gbps.
- Input Resolution - Up to 1080p.
- Standards Compliance - HDCP 1.1, and DVI 1.0.
- HDMI Support - HDMI (V.1.4 with Deep Color, x.v.Color™, Lip Sync, HDMI Uncompressed Audio Channels, Dolby TrueHD, DTS-HD).
- I-EDIDPro™ Kramer Intelligent EDID Processing™ - Intelligent EDID handling & processing algorithm ensures Plug and Play operation for HDMI systems.
- Indicators - Input, output and HDCP LEDs.
- Non-Volatile Memory - Saves final settings.
- Compact DigiTOOLS® - 3 units can be rack mounted side-by-side in a 1U rack space with the optional RK-3T rack adapter.

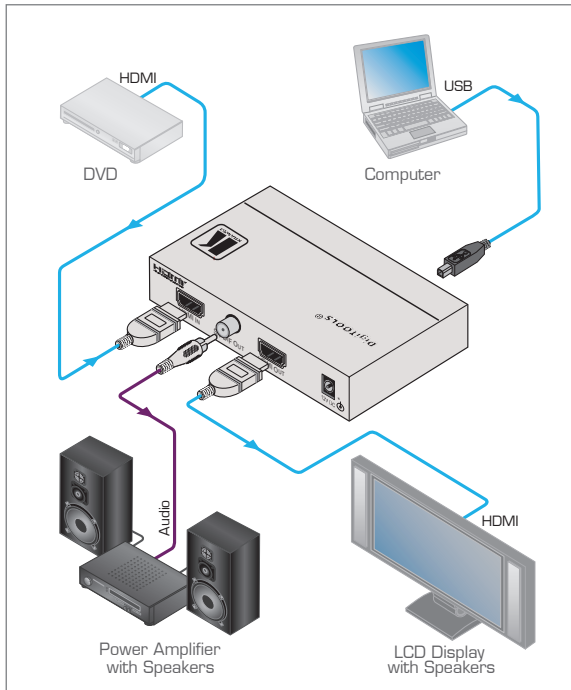

### TECHNICAL SPECIFICATIONS

INPUT:	1 HDMI connector.
OUTPUTS:	1 HDMI connector; 1 S/PDIF digital audio on an RCA connector.
PORT:	1 USB connector.
BANDWIDTH:	Supports up to 2.25Gbps bandwidth per graphic channel.
COMPLIANCE WITH HDMI STANDARD:	Supports HDMI and HDCP.
RESOLUTION:	Up to UXGA; 1080p, 36bit.
POWER SOURCE:	12V DC, 410mA.
CONTROLS:	SELECT button, EDID MODE LEDs.
DIMENSIONS:	12cm x 7.2cm x 2.4cm (4.7" x 2.8" x 1.0") W, D, H.
WEIGHT:	0.3kg (0.7lbs).
ACCESSORIES:	Power supply, Windows®-based control software.
OPTIONS:	RK-3T 19" rack adapter.

SPECIALTY AV PRODUCTS

