

# FC-10ETH

## RS-232/RS-485 to Ethernet Converter



The **FC-10ETH** is a bidirectional RS-232 or RS-485 to Ethernet control signal converter. It allows two RS-232 (or one RS-232 and one RS-485) controllable devices to be controlled via an Ethernet or LAN connection.

### FEATURES

- Input - 2 RS-232 and 1 RS-485.
- Internal 128 Byte buffer.
- Control Software Included - Windows®-based configuration management software for network programming (including routing mode settings, network settings, serial settings, and destination device settings).
- Compact Kramer TOOLS™ - 3 units can be rack mounted side-by-side in a 1U rack space with the optional RK-3T rack adapter.

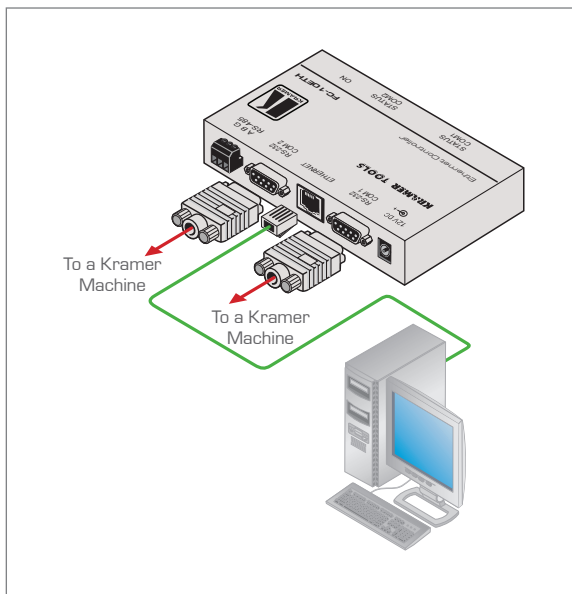

### TECHNICAL SPECIFICATIONS

**ETHERNET INTERFACE:** 10/100BaseT Ethernet.  
**SERIAL INTERFACES:** 2 RS-232 connectors, signals: RX, TX, RTS, CTS, ground on 9-pin D-sub (M) ports; 1 RS-485 on a detachable terminal block connector.  
**NETWORK PROTOCOLS:** ICMP, ARP (ping), TCP, UDP.  
**POWER SOURCE:** 12V DC, <80mA.  
**DIMENSIONS:** 12cm x 7.5cm x 2.5cm (4.7" x 2.95" x 0.98") W, D, H.  
**WEIGHT:** 0.3kg (0.25lbs) approx.  
**ACCESSORIES:** Power supply, mounting bracket.  
**OPTIONS:** RK-3T 19" rack adapter.

