

7508

Multi-Standard Composite Video & s-Video to SDI Format Converter



The **7508** is a multi-format converter for composite video or s-Video (Y/C) signals. It converts either PAL, SECAM, and NTSC composite or s-Video (Y/C) signals into two SDI video (SMPTE 259M) outputs simultaneously.

FEATURES

- Bandwidth - 5MHz (-0.2dB).
- Dual SDI Outputs.
- Multi-Standard - PAL(M/N), SECAM, NTSC (3.58/4/43).
- NTSC Decoding Options - With or without 7.5 IRE setup (pedestal).
- Non-Volatile Memory.
- Resolution - 10-bit digital processing.
- Control - RS-232 (Windows®-based software is included).
- ProcAmp Control - Brightness, contrast color (saturation) and hue (NTSC Only) via RS-232.
- Compact DigiTOOLS® - 3 units can be rack mounted side-by-side in a 1U rack space with the optional RK-3T rack adapter.

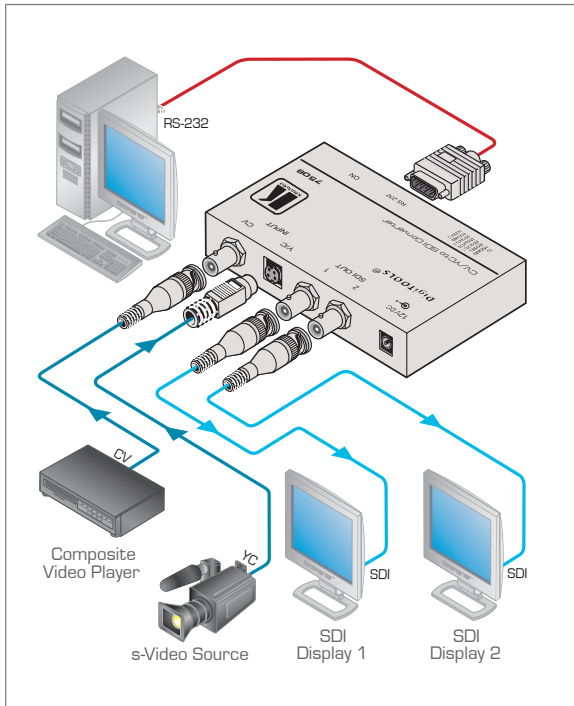

TECHNICAL SPECIFICATIONS

INPUT:	1 composite video, 1Vpp/75Ω on a BNC connector; 1 s-Video, 1Vpp, 0.3Vpp/75Ω on a 4-pin connector.
OUTPUT:	2 SDI SMPTE-259M, ITU-R BT.601 on BNC connectors.
DIGITAL RESOLUTION:	10 bits.
BANDWIDTH:	5MHz (-0.2dB).
SIGNAL TO NOISE RATIO:	57dB.
K-FACTOR:	<0.2%.
DIFFERENTIAL PHASE:	1Deg.
DIFFERENTIAL GAIN:	1%.
LUMA NON-LINEARITY:	1%.
CHROMA/LUMA DELAY:	<15ns.
CONTROL:	Brightness, contrast, hue, saturation, sharpness via RS-232.
POWER SOURCE:	12V DC, 210mA.
DIMENSIONS:	12cm x 7.5cm x 2.5cm (4.7" x 2.95" x 0.98") W, D, H.
WEIGHT:	0.3kg (0.66lbs) approx.
ACCESSORIES:	Power supply, mounting bracket.
OPTIONS:	RK-3T 19" rack adapter.

FORMAT & STANDARDS CONVERTERS

