

# VP-43xl

## RS-232/RS-485/RS-422 Format Converter



The VP-43xl is a bidirectional format converter between RS-232, RS-485, and RS-422 protocols. Input data in any format is converted to the other two formats.

### FEATURES

- Ports - RS-232, RS-485, and RS-422.
- Format Conversion - Any control message is converted to the other 2 formats at the same baud rate.
- RS-485 - Up to 32 units can be connected via RS-485.
- Baud Rates - 1200, 2400, 9600, 19200 and 38400.
- Compact Kramer TOOLS™ - 3 units can be rack mounted side-by-side in a 1U rack space with the optional RK-3T rack adapter.

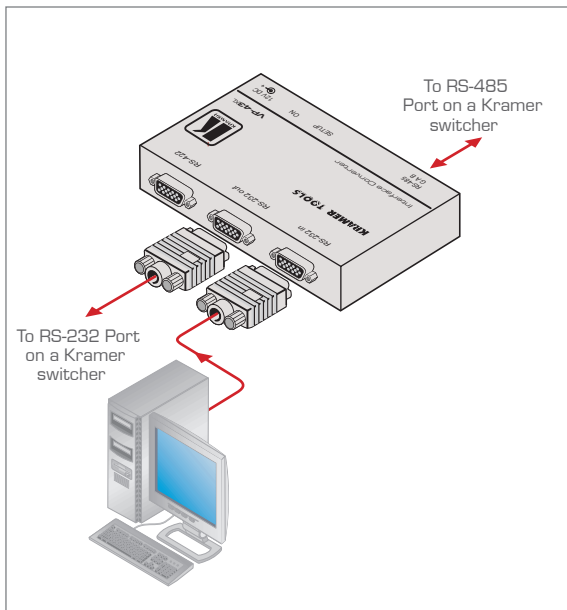

### TECHNICAL SPECIFICATIONS

INPUT/OUTPUT:	RS-232 IN on 9-pin D-sub (F), RS-232 OUT on 9-pin D-sub (M) compliant to TIA/EIA-232-F. RS-485 on 3 wires detachable terminal block compliant to TIA/EIA-485-A. RS-422 on 9-pin D-sub (F) compliant to TIA/EIA-422-B.
BAUD RATES:	1200, 2400, 9600, 19200, 38400.
FORMAT:	1 start bit, 8 data bits, 1 stop bit.
DISPLAY:	Power ON LED.
POWER SOURCE:	12V DC, 80mA.
DIMENSIONS:	12cm x 7.5cm x 2.5cm (4.7" x 2.95" x 0.98") W, D, H.
WEIGHT:	0.3kg (0.67lbs) approx.
ACCESSORIES:	Power supply, mounting bracket.
OPTIONS:	RK-3T 19" rack adapter.

