

# RC-6iR

## 6-Button Universal Room Controller with IR Learning

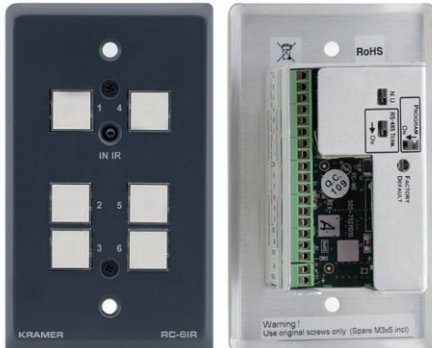

▲ US version

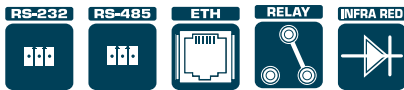

◀ European version

The **RC-6iR** is a 6-button room controller for multimedia rooms. It controls audio components, video components, and other room facilities such as lights and screens.

### FEATURES

- **6 Back Lit & Label Capable Buttons** - Up to 15 commands per macro and 4 toggling macros per button.
- **Ethernet Port** - Allows for easy setup with Kramer's Windows®-based configuration software from an internet connection anywhere in the world. Note: Although under certain conditions the Ethernet port of the RC-6iR may be used to control an AV product, it is not designed for this purpose and we do not recommend doing this.
- **2 IR Ports.**
- **IR Learning Function** - Learn commands from IR remotes.
- **2 Relay Contact Closure Ports** - Conveniently control other room items related to the AV system such as raising and lowering drapes, the screen or the projector.
- **2 Bidirectional RS-232 and 1 RS-485 Ports** - Control up to three additional devices via serial control protocols.
- **Lock Out Feature** - The RC-6iR can be locked and unlocked to prevent tampering.
- **Wall Plate Size** - 2 gang EU, 1 gang US.

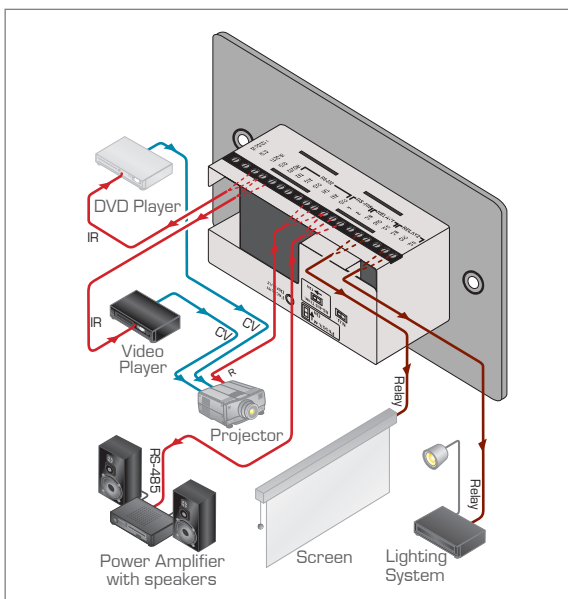

### TECHNICAL SPECIFICATIONS

|                      |   |
|----------------------|---|
| <b>PORTS:</b>        | 2 RS-232 on terminal block connectors;<br>1 RS-485 on terminal block connectors;<br>1 ETHERNET RJ-45 port.  |
| <b>OUTPUTS:</b>      | 2 relays on terminal block connectors<br>(36V AC or DC, 2A, 60V AC maximum on non-inductive load);<br>2 IR emitters on terminal block connectors.                                     |
| <b>POWER SOURCE:</b> | 12V DC, 155mA.  |
| <b>DIMENSIONS:</b>   | 11.4cm x 4.3cm x 6.9cm (4.49" x 1.70" x 2.72") W, D, H.   |
| <b>WEIGHT:</b>       | 0.3kg (0.67lbs) approx.   |
| <b>ACCESSORIES:</b>  | Kramer 3.5mm to IR Emitter Control Cable (C-A35/IRE-10), power supply, two extra M3x5 screws, Java based control software (internal), Kramer's Windows®-based configuration software. |
| <b>OPTIONS:</b>      | Kramer 3.5mm to IR Emitter Control Cable (C-A35/IRE-10), Kramer 3.5mm to Dual IR Emitter Control Cable (C-A35/2IRE-10), 15m and 20m IR emitter extension cables.                      |

