

# RC-8iR

## 8-Button Universal Room Controller with IR Learning



▲ US version



◀ European version

The **RC-8iR** is an 8-button room controller for multimedia rooms. It controls audio components, video components and other room facilities such as lights and screens.

### FEATURES

- **8 Back Lit & Label Capable Buttons** - Up to 15 commands per macro and 4 toggling macros per button.
- **Ethernet Port** - Allows for easy setup with Kramer's Windows®-based configuration software from an internet connection anywhere in the world. Note: Although under certain conditions the Ethernet port of the RC-8iR may be used to control an AV product, it is not designed for this purpose and we do not recommend doing this.
- **2 IR Ports.**
- **IR Learning Function** - Learn commands from IR remotes.
- **2 Relay Contact Closure Ports** - Conveniently control other room items related to the AV system such as raising and lowering drapes, the screen or the projector.
- **2 Bidirectional RS-232 and 1 RS-485 Ports** - Control up to three additional devices via serial control protocols.
- **Lock Out Feature** - The RC-8iR can be locked and unlocked to prevent tampering.
- **Wall Plate Size** - 1 gang US, 2 gang EU.

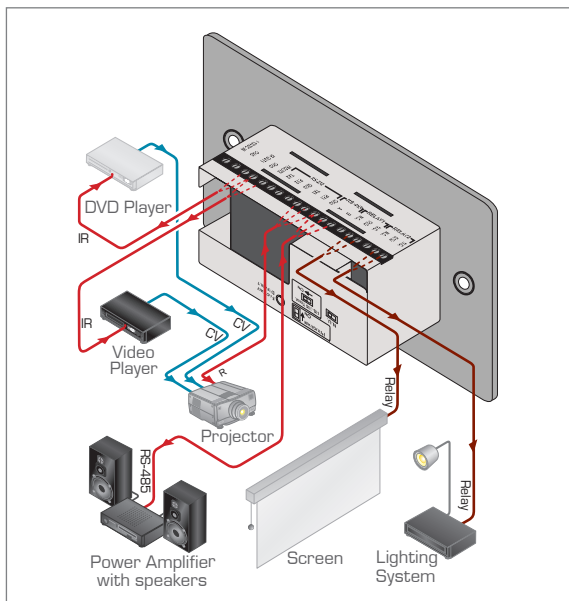

### TECHNICAL SPECIFICATIONS

<b>PORTS:</b>	2 RS-232 on terminal block connectors; 1 RS-485 on terminal block connectors; 1 ETHERNET RJ-45 port.
<b>OUTPUTS:</b>	2 relays on terminal block connectors (36V AC or DC, 2A, 60V AC maximum on non-inductive load); 2 IR emitters on terminal block connectors (for RC-6iR and RC-8iR).
<b>POWER SOURCE:</b>	12V DC, 155mA.
<b>DIMENSIONS:</b>	11.4cm x 4.3cm x 6.9cm (4.49" x 1.70" x 2.72") W, D, H.
<b>WEIGHT:</b>	0.3kg (0.67lbs) approx.
<b>ACCESSORIES:</b>	Power supply, Java based control software (internal), Kramer's Windows®-based configuration software.
<b>OPTIONS:</b>	Dual IR emitter cable, single IR emitter cable, IR extension cable.