

FC-321

2x1 3G HD-SDI to HDMI Format Converter

NEW

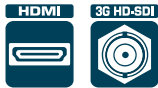

The **FC-321** is a high-performance format converter for 3G HD-SDI signals. It converts one of two 3G HD-SDI signals to an HDMI output signal with the same resolution and frame rate.

FEATURES

- Inputs - 2 3G HD-SDI on BNC connectors.
- Outputs - 1 HDMI.
- HDTV Compatible.
- Audio Group De-embedded Selection.
- Multi-Standard Operation - SDI (SMPTE 259M and SMPTE 344M), HD-SDI (SMPTE 292M) and 3G HD-SDI (SMPTE 424M).
- Active Input & Output LED Indicators.
- Switching - Front panel and IR remote (included).
- Compact DigiTOOLS® - 3 units can be rack mounted side-by-side in a 1U rack space with the optional RK-3T rack adapter.

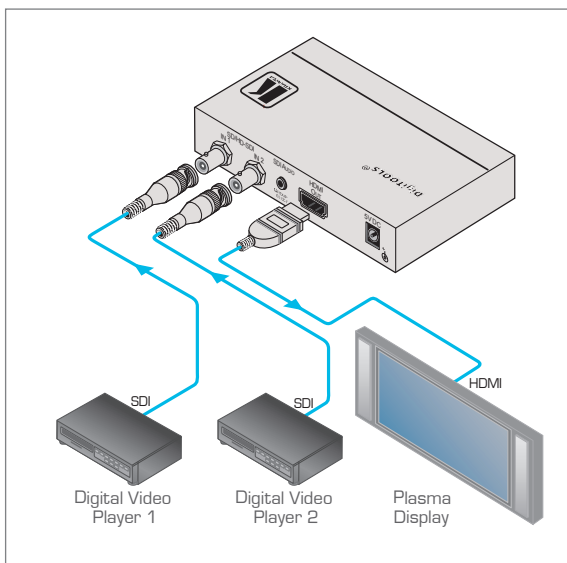

TECHNICAL SPECIFICATIONS

INPUTS:	2 SDI, HD-SDI, 3G HD-SDI on a BNC connector.
OUTPUT:	1 HDMI connector.
MAX. DATA RATE:	Up to 3Gbps.
STANDARD COMPLIANCE:	HDMI.
INDICATOR LEDES:	SD/HD, OUT, ON.
POWER SOURCE:	5V DC, 450mA.
DIMENSIONS:	12cm x 7.2cm x 2.4cm (4.7" x 2.8" x 1.0") W, D, H.
WEIGHT:	0.3kg (0.7lbs).
ACCESSORIES:	Power supply.
OPTIONS:	RK-3T 19" rack mount adapter.

FORMAT & STANDARDS CONVERTERS

