

PT-571HDCP/PT-572HDCP

DVI over Twisted Pair Transmitter & Receiver

NEW

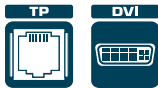

The **PT-571HDCP** and **PT-572HDCP** are a twisted pair transmitter and receiver for DVI signals. The **PT-571HDCP** converts the DVI to twisted pair signal and the **PT-572HDCP** converts the twisted pair signal back to a DVI signal.

FEATURES

- Max. Data Rate - 1.65Gbps.
- HDTV Compatible.
- HDCP Compliant.
- Input/Output - DVI-D signal (on a DVI-I connector).
- System Range - Up to 90m (295ft) at SXGA, or up to 30m (98ft) at UXGA on shielded BC-DGKat524 cable. Up to 90m (295ft) at SXGA, or up to 70m (230ft) at UXGA on shielded BC-DGKat623 cable. Up to 100m (330ft) at SXGA, or up to 80m (265ft) at UXGA on shielded BC-DGKat723 cable.
- Cable - STP (shielded twisted pair) such as CAT 5. For optimum range and performance, use Kramer's BC-DGKat524, BC-DGKat623 or BC-DGKat723 cables. Note that the transmission range depends on the signal resolution, graphics card and display used. The distance using non-Kramer CAT 5, CAT 6, and CAT 7 cables may not reach these ranges.
- EDID PassThru - Passes EDID/HDCP signals from source to display.
- Power Connect™ System - A single connection to the transmitter powers both units when the devices are within 270ft (90m) of each other.
- Ultra-Compact PicoTOOLS™ - 4 units can be rack mounted side-by-side in a 1U rack space with the optional RK-4PT rack adapter.

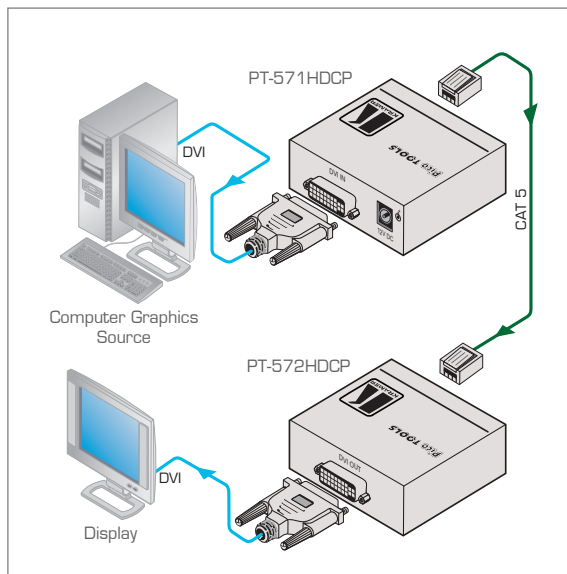

TECHNICAL SPECIFICATIONS

INPUTS:	1 DVI, 1.2Vpp on a DVI Molex 24-pin female connector (PT-571HDCP), DDC signal 5Vpp (TTL); 1 RJ-45 connector (PT-572HDCP).
OUTPUTS:	1 RJ-45 connector (PT-571HDCP); 1 DVI, 1.2Vpp on a DVI Molex 24-pin female connector, DDC signal 5Vpp (TTL) (PT-572HDCP).
BANDWIDTH:	Supports up to 1.65Gbps.
POWER SOURCE:	12V DC, 250mA (transmitter and receiver together).
DIMENSIONS:	6.2cm x 5.2cm x 2.4cm (2.4" x 2.1" x 1") W, D, H.
WEIGHT:	0.14kg (0.3lbs).
ACCESSORIES:	Power supply, mounting bracket.
OPTIONS:	RK-4PT 19" rack adapter, Kramer DVI cables and BC-DGKat524 (24 AWG) CAT 5 and BC-DGKat623 (23 AWG) CAT 6 cables.

RANGE EXTENDERS & REPEATERS

