

# FC-31 xl

## Computer Graphics Video to DVI Format Converter

NEW

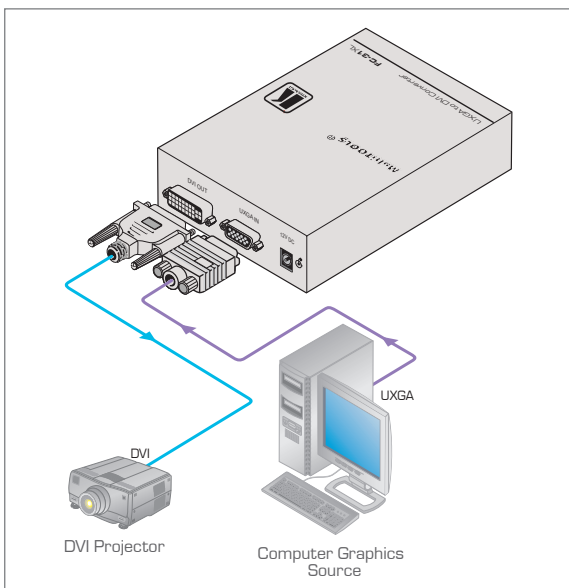

The **FC-31xl** is a high-performance format converter for computer graphics signals with resolutions up to and including WUXGA. The unit converts a computer graphics input to a DVI-D output.

### FEATURES

- Max. Data Rate (DVI) - 1.65GHz.
- Input - 15-pin HD.
- Output - DVI-D signal (on a DVI connector).
- Controls - H & V position and sharpness via DIP-switches.
- Compact MultiTOOLS® - 4 units can be rack mounted side-by-side in a 1U rack space with the optional RK-1 universal rack adapter.

### TECHNICAL SPECIFICATIONS

|                        |   |
|------------------------|---|
| INPUT:                 | 1 UXGA on a 15-pin HD connector.  |
| OUTPUT:                | 1 DVI , 1.2Vpp on a DVI Molex 24-pin female connector; DDC signal 5Vpp (TTL).   |
| SUPPORTED RESOLUTIONS: | 640x480 @60Hz/72Hz/75Hz/85Hz;<br>720x400 @70Hz/85Hz; 800x600 @56Hz/60Hz/<br>72Hz/75Hz/85Hz; 848x480 @60Hz; 1024x768<br>@60Hz/72Hz/75Hz/85Hz; 1152x864 @75Hz;<br>1280x768 @60Hz (RB)/75Hz/85Hz; 1280x800<br>@60Hz; 1280x960 @60Hz/85Hz; 1280x1024<br>@60Hz/75Hz/85Hz; 1360x768 @60Hz;<br>1400x1050 @60Hz(RB)/75Hz; 1440x900<br>@60Hz; 1440x1050 @60Hz; 1600x1200<br>@60Hz; 1680x1050 @60Hz; 1920x1080 @60Hz;<br>1920x1200 @60Hz(RB). |
| DVI BANDWIDTH:         | 1.65GHz.  |
| CONTROLS:              | DIP-switches.   |
| COUPLING:              | DC.   |
| POWER SOURCE:          | 12V, 180mA.   |
| DIMENSIONS:            | 10.7cm x 15.9cm x 4.0cm (4.21" x 6.26" x 1.59")<br>W, D, H.   |
| WEIGHT:                | 0.15kg (0.55lbs) approx.  |
| ACCESSORIES:           | Power supply. RK-1 19" rack adapter.  |
| OPTIONS:               | RK-1 19" rack adapter.  |

FORMAT & STANDARDS CONVERTERS

