

FC-113

HDMI to 3G HD-SDI Format Converter

NEW

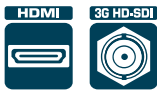

The **FC-113** is a high-performance format converter for HDMI signals. It converts an HDMI input signal to two identical SDI video with embedded audio signals.

FEATURES

- Max. Data Rate - 3Gbps.
- HDTV Compatible.
- Multi-Standard Operation - SDI (SMPTE 259M), HD-SDI (SMPTE 292M), and 3G HD SDI (SMPTE 424M).
- No Frame Rate or Resolution Conversion.
- Active Input™ LED Reporting - Green indicates standard definition (SDI), blue indicates a high-definition (HD-SDI) input signal, flashing indicates HDCP on the HDMI signal.
- HDCP Encryption - Since the HD-SDI standard does not support HDCP, the status LED flashes when an HDCP encrypted input signal is detected, indicating that the input signal cannot be converted.
- Compact DigiTOOLS® - 3 units can be rack mounted side-by-side in a 1U rack space with the optional RK-3T rack adapter.

FORMAT & STANDARDS CONVERTERS

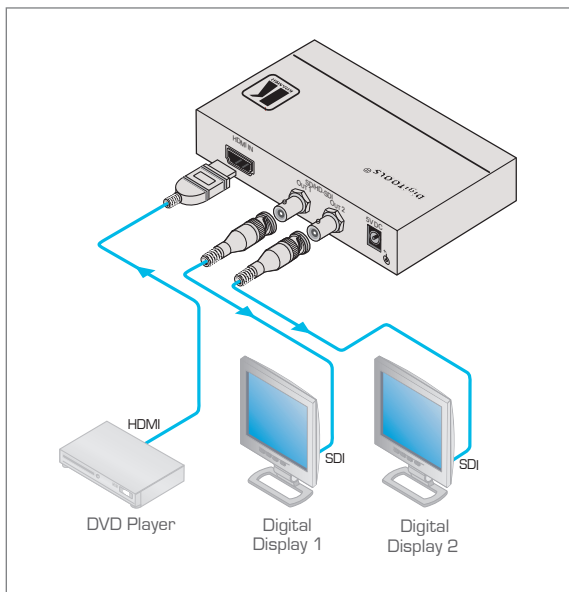

TECHNICAL SPECIFICATIONS

INPUT:	1 HDMI connector.
OUTPUTS:	2 SD/HD-SDI, 3G HD-SDI on BNC connectors.
MAX. DATA RATE:	Up to 3Gbps.
STANDARD COMPLIANCE:	HDMI.
INDICATOR LEDES:	SD/HD, OUT, ON.
POWER SOURCE:	5V DC, 440ma.
DIMENSIONS:	12cm x 7.2cm x 2.4cm (4.7" x 2.8" x 1.0") W, D, H.
WEIGHT:	0.3kg (0.7lbs).
ACCESSORIES:	Power supply.
OPTIONS:	RK-3T 19" rack adapter.

