



ATLONA 24x24 PROFESSIONAL COMPOSITE AUDIO/VIDEO MATRIX SWITCH



Weight	21.00 lbs
SKU#	AT-AV2424

Features:

- Power-Fail Protection, allows switcher to restore previous settings
- LCD display, shows all programmed commands and switcher responses
- Preset ability, allows user to save specific tasks under one of the 10 presets and call it back with shortcut
- RS232 Communication Control Input, allows to control switcher via included advanced Control software or Third Party Control System
- IR Remote Control
- Audio and Video could have a separate matrix modes (Example: Video in #1 ----> Video Out #2, while Audio in #1----> Audio Out #3)
- Connectors: AV Composite Audio/Video (BNC female for video RCA female for audio)
- Compatible Formats: Composite AV (Composite Audio/Video)
- Lock Safe, allows user to lock unit from being accidentally switched to incorrect mode
- Undo Function, allows user to undo the incorrect operation and return to the previous setting
- Standard 19" Rack Mount Size - 7U

Technical Specifications:

- Bandwidth: 150MHz @ (-3dB), fully loaded
- Cross talk sum: 50dB @5MHz; -45dB @ 10 MHz
- Switching speed: 200 ns (Max)
- Signal type: Composite
- Video Connectors: BNC style (female)
- Audio Connectors: RCA style (female)
- Echo Loss: <-30dB@5MHz
- Audio Frequency: 20 Hz to 20 kHz
- Standard 19" Rack Mount Size -7U
- Connector: RCA female (1 x BNC per input/output and 2 x RCA per input/output)
- Communication Port: RS232
- Impedance: 75 Ohm
- Temperature: 20C to +70C (-20 F to 158 F)
- Power Supply: 110V-240V (50-60Hz)
- Dimensions (mm): W 485 X H 285 X D 245
- Dimensions (inch): W 19 X H 11.22 X D 9.65
- Unit Weight: 9kg or 18LB
- Gross Package Weight: 21LB

Rear View



Inputs/Outputs:

- Inputs: 24 x AV female (1 x BNC female per input for video and 2-RCA female per input for audio)
- Outputs: 24 x AV female (1 x BNC female per output for video and 2-RCA female per output for audio)

Package Includes:

- 1 x AT-AV2424
- 1 x RS-232 Communication Cord
- 1 x Power Supply Cord (US)
- 1 x CD with RS232 Application Software
- 1 x IR Remote
- 1 x User's Manual and Quality Guarantee

Warranty:

3 year manufacture warranty (parts and labor)



Atlona
2151 O'toole Ave Unit D
San Jose, CA 95131
Tel: 408-954-8782
Fax: 408-954-8792
toll free: 1-877-536-3976

WWW.ATLONA.COM

COMPATIBLE WITH:





ATLONA 24x24 PROFESSIONAL COMPOSITE AUDIO/VIDEO MATRIX SWITCH

Connection Diagram

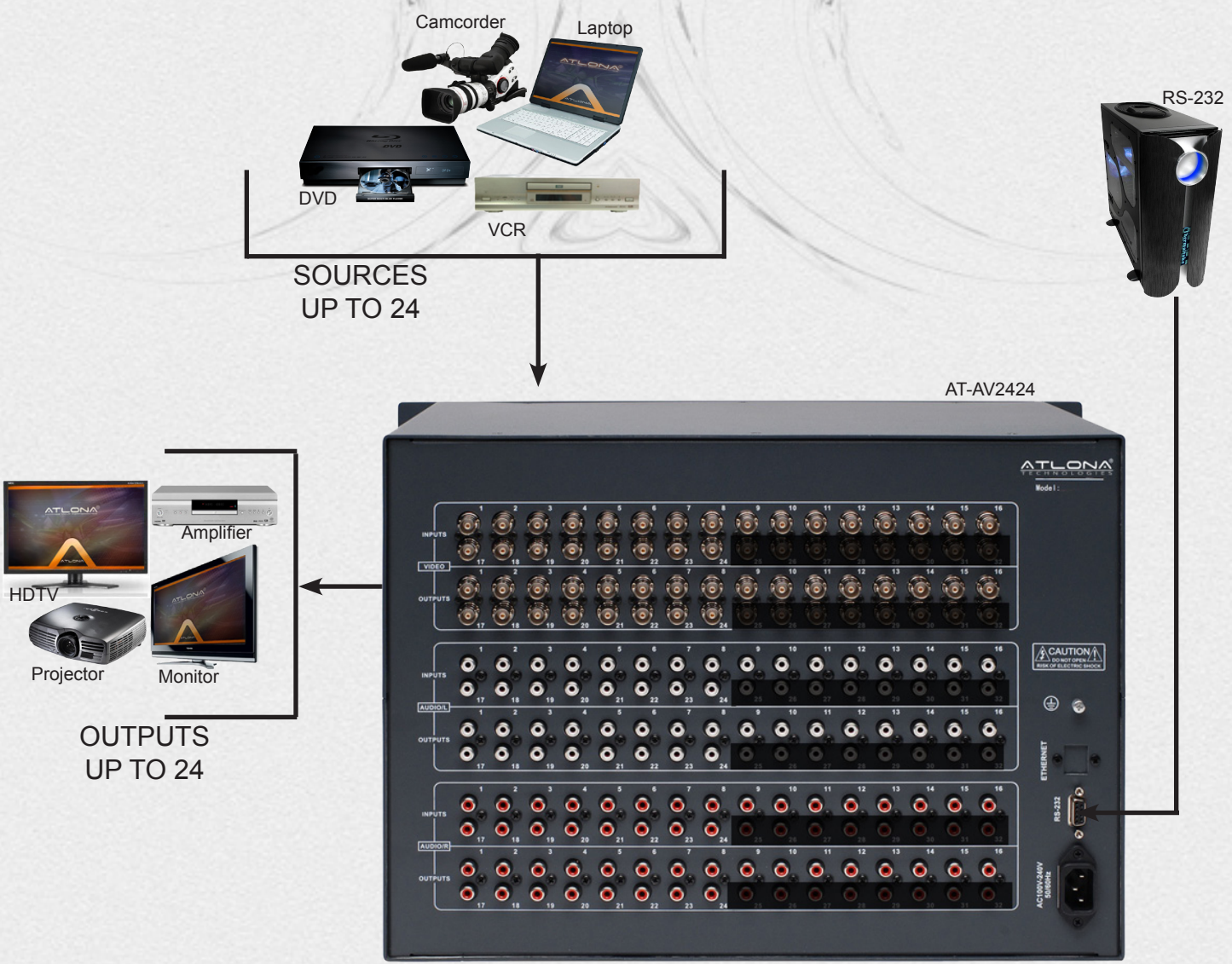

Atlona
 2151 O'toole Ave Unit D
 San Jose, CA 95131
 Tel: 408-954-8782
 Fax: 408-954-8792
 toll free: 1-877-536-3976

WWW.ATLONA.COM

COMPATIBLE WITH:

HDMI
 HIGH DEFINITION MULTIMEDIA INTERFACE
 ADOPTER

CEA
 Member

infoComm
 INTERNATIONAL

CEDIA
 Member
 CUSTOM ELECTRONIC DESIGN & INSTALLATION ASSOCIATION