

Tiger Saw Blade

The TIGER 48" Saw Blade Attachment is designed and engineered to provide a smooth cut in tree limbs. The Saw Blade can be mounted on both the Bengal and Saber Series 50" Rotary Cutters. The Saw Blade comes standard with replaceable carbide tipped teeth.

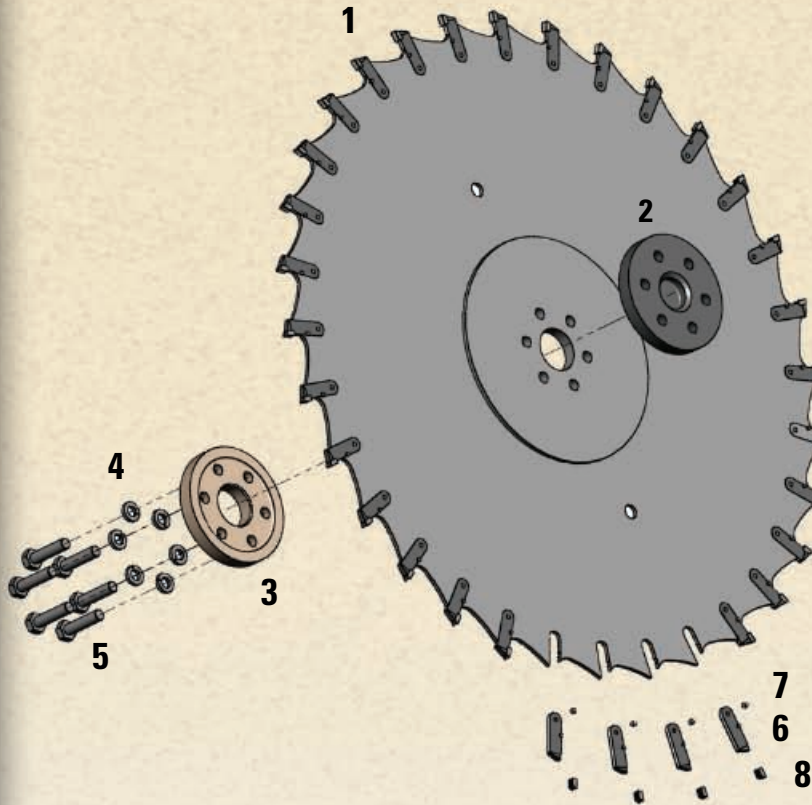

BENGAL SERIES KIT # 06200562: Kit includes items 1, 2, 3, 4, 5.

ITEM	PART NO.	DESCRIPTION	QTY
1	06520224	Saw Blade, 48" with Teeth	1
2	06420024	Adapter, Saw Blade TRB 50 Head	1
3	06420037	Collar, Saw Blade TRB 50 Head	1
4	33764	Flat Washer, 5/8" Gr. 8	6
5	06530209	Capscrew 5/8" x 3 3/4" UNF Gr. 8	6
6	06520225	Tooth with Rivet, Saw Blade	30
7	34703	Tooth Rivet, Saw Blade	30
8	34702	Tooth Tip, Saw Blade	30

SABER SERIES KIT # 06200561: Kit includes items 1, 2, 3, 4, 5.

ITEM	PART NO.	DESCRIPTION	QTY
1	06520224	Saw Blade, 48" with Teeth	1
2	06520025	Adapter, Saw Blade SBR 50 Head	1
3	06520038	Collar, Saw Blade SBR 50 Head	1
4	33880	Flat Washer, 3/4" Gr. 8	6
5	06530210	Capscrew 3/4" x 3 3/4" UNF Gr. 8	6
6	06520225	Tooth with Rivet, Saw Blade	30
7	34703	Tooth Rivet, Saw Blade	30
8	34702	Tooth Tip, Saw Blade	30



48" Saw Blade Attachment with reinforced center for added blade strength. Tiger Bengal Series 50" Rotary Mower (shown).



Cuts up to 6" tree limbs with Bengal Series and 8" tree limbs with Saber Series.



WWW.TIGER-MOWERS.COM

Tiger Corporation
3301 N. Louise Ave.
Sioux Falls, SD 57107
800-843-6849

Specifications are subject to change without notice.
Meets All Applicable ANSI / SAE Test Standards.
© 2007 Tiger Corporation. All Rights Reserved. Printed in the USA.