

**ster**tili® **KOBI**



**ST 4175- ST 4250**  
**Heavy Duty 4-post vehicle lifts**  
**Capacities 38,500 – 54,000 lbs**



**stertil KONI**

The name Stertil-Koni is synonymous with innovation, safety, reliability and environmental awareness, Stertil-Koni has become the world's largest manufacturer and supplier of hydraulic vehicle lifting systems. This has been achieved by offering top quality products with excellent after sales service that satisfies the end users during the long life span of our products.

## WORLD MARKET LEADER

Stertil-Koni is the world market leader in the supply of Heavy Duty vehicle lifts that are used in trucking, transportation, waste management, aviation and mining as well as specialty applications. We have our own sales organizations in the United States, Netherlands, Germany, United Kingdom, France and Poland and work with over 50 exclusive partners worldwide. There is always a Stertil-Koni dealer near you! Safety, reliability and productivity are the key words for the modern workshop and Stertil-Koni products are built around these criteria.

Our products comply with the most stringent safety regulations worldwide and pave the way for efficient and flexible garage management with the best possible price to performance ratio.

# Stertil-Koni ST 4175 - ST 425



### Superior technology

The hydraulic synchronization system is electronically controlled. This ensures a smooth lifting and lowering cycle, even in the event of an extremely uneven load distribution of the vehicle. With the absence of wear-susceptible parts (e.g. ropes and pulleys) maintenance is reduced to a minimum. Other innovative features include the programmable lifting height, programmable lights that automatically switch on and off and, an audible warning for crush protection.

### Rapid lifting

The ST4175 and ST4250 have a lifting time of about 72 seconds, making these powerful 4-post lifts the quickest in their class.

### Maximum safety

The Stertil-Koni ST4175 and the ST4250 meet the most stringent safety requirements in the world. The CE (Europe), ALI-ETL (USA) and CSA (Canada) hallmark is standard.

# 0: The most innovative 4-post vehicle lifts in the



## Flexible installation width

The absence of any crossbeams between the platforms allows the ideal width to be set at the time of installation, ensuring easy access for personnel and for axle stands, transmission jacks etc.



## Very low drive-on height

The wide runways have an extremely low drive-on height. This means that low ground clearance vehicles can drive on easily. The standard approach ramps have a unique and ingenious design and are not an floor obstruction during work.

## Durability

The Stertil-Koni ST4175 and ST4250 have been designed for a long, problem-free life. All lifts are developed and tested for at least 50,000 lifting operations at maximum load.

## Economical power consumption

Microprocessor controlled hydraulics and high efficiency electric motors give outstanding performance and have very low energy consumption.

## Optimum accessibility

Due to the absence of any crossbeams and the ingenious folding design of the standard drive-on ramps, access beneath and around the underside of the vehicle is maximized.

There is nothing to hinder the use of oil drainers, wheel dollies, transmission jacks etc.

## User friendly operation

These heavy-duty 4-post lifts are easy to operate. The control panel is equipped with hold to run low voltage push buttons. The control system has a numerical on-board self-diagnostic program providing information about the system status.

## Unique lifting height

Since the lifting height is 75", tall people can stand upright and work under the vehicle helping to prevent back problems/injuries.

## Lifetime guarantee

The synthetic runner wheel system is self-lubricating and therefore requires no maintenance. This runner wheel system comes with a lifetime parts warranty.

## Independent safety

Mechanical: the patented, mechanical locking system works independently of the lifting system and is always active. Gravity activated locks guarantee the highest safety.





# world

Hydraulic: every lifting cylinder is equipped with flow controlled check valves, which are active during the complete range of travel. Integrated pressure relief valves, protect each individual column against overloading.

- The absence of any crossbeams gives you a great deal of space.
- Runway lengths are available in 20, 26, 30, 33 or 38 feet to give you maximum flexibility. This enables you to service a very wide range of vehicles.
- For lifting articulated buses, trucks with semi-trailers and articulated units, connected versions are available. The two vehicle lifts set up in-line can be used either synchronously or separately.

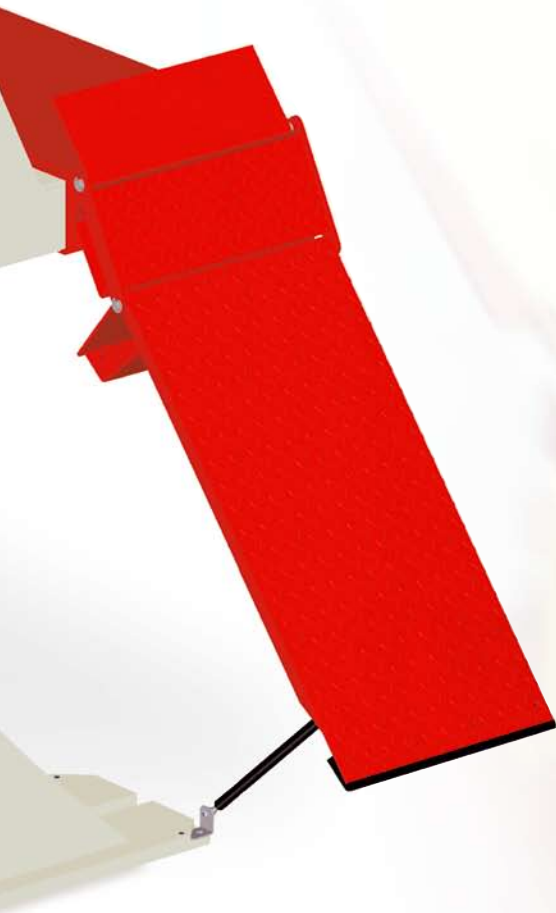



# Accessories & options:

- Axle stands from 8 up to 20 tons
- Jacking beam (for wheel-free maintenance e.g. brakes, suspension, tires)
- LED lighting set
- Short approach ramps
- Long fixed approach ramps
- Second control box
- Third platform (for lifting three wheel forklifts)
- Custom RAL colors

## Maximum safety:

- ANSI/ALI-ALCTV 2006 certified (United States of America)
- CSA certified (Canada)
- CE certified (Europe)
- Low voltage control cabinet
- Automatic overload protection
- Independent mechanical locking system
- Microprocessor-controlled tracking system
- Automatic stop when highest position is reached
- Hold-to-run, fail-safe operation
- Emergency stop button on every control box
- Splash-proof electrical system (NEMA 4)



I N N O V A T I V E

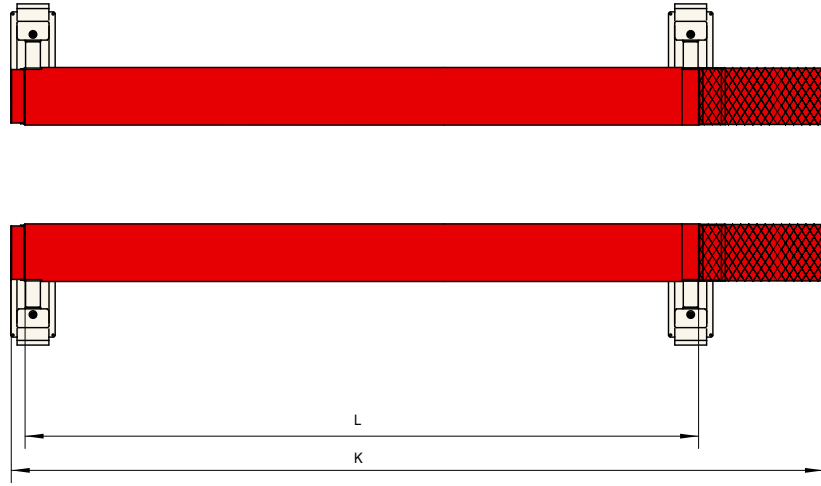
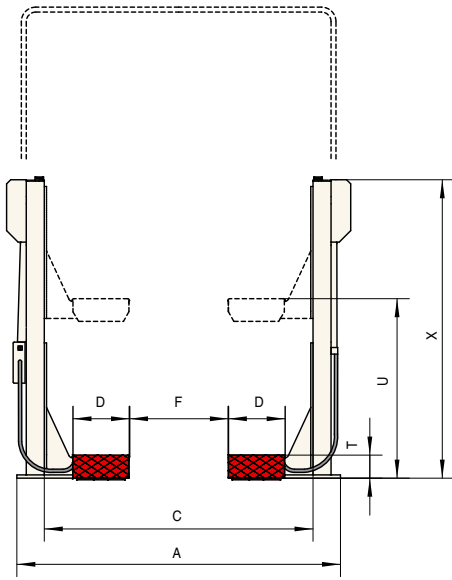

### Specifications ST4175

- Lifting capacity: 38,500 lbs
- Lifting system: hydraulic
- Lifting height: 6' - 3"
- Lifting time: 54 seconds
- Motor: 4 x 3 hp
- Weight: 9,900 lbs (29' - 6 3/8")

Track length	K	L	A	C	D	F	T	U	X
19'-8 1/4"	24'-6"	20'-4 1/8"							
26'-3"	31'-1"	26'-10 3/4"							
29'-6 3/8"	34'-4"	30'-2 1/4"	12'-8 1/4"*	10'-7 3/8"*	27'-1/2"	(23'-1/2")* (47'-1/4")*	9'-1/2"	6'-3"	11'-10 1/2"
32'-9 3/4"	37'-7 1/2"	33'-5 1/2"							
37'-8 3/4"	42'-6 1/2"	38'-4 5/8"							

\* Flexible measurements dependent on working width

### Specifications ST4250

- Lifting capacity: 54,000 lbs
- Lifting system: hydraulic
- Lifting height: 6' - 3"
- Lifting time: 77 seconds
- Motor: 4 x 3 hp
- Weight: 12,600 lbs (29' - 6 3/8")

Track length	K	L	A	C	D	F	T	U	X
19'-8 1/4"	25'-5 3/4"	20'-4 1/8"					11"		
26'-3"	32'-3/4"	26'-10 3/4"					11"		
29'-6 3/8"	35'-4"	30'-2 1/4"	12'-11 1/2"*	10'-7"*	27'-1/2"	(39'-1/2")* (47'-1/4")*	11"	6'-3"	11'-10 1/2"
32'-9 3/4"	39'-5 1/4"	33'-5 1/2"					12 3/4"		
37'-8 3/4"	44'-4 1/4"	38'-4 5/8"					12 3/4"		

\* Flexible measurements dependent on working width

### More information?

For more or specific information about the ST 4175, ST 4250 or one of the other quality products from Stertil-Koni, please contact us for further assistance.

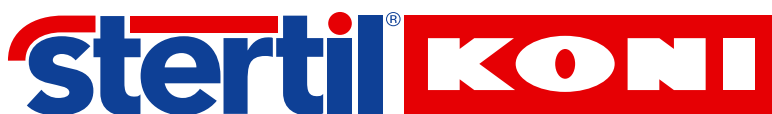

Stertil-Koni U.S.A. Inc., 200 Log Canoe Circle, Stevensville, Maryland 21666

Tel. 410-643-9001 Toll free 800-336-6637 Fax 410-643-8901 www.stertil-koni.com E-mail: lifts@stertil-koni.com



A member of the Stertil Group