

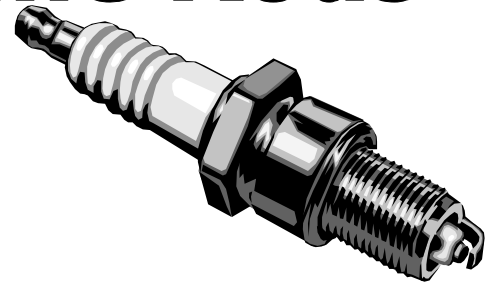

ENGINEERING CORPORATION

Industrial Igniters and Flame Rods



Crown Engineering Corporation, the original OEM manufacturer of electrodes, igniters, and flame rods for oil and gas burners, is proud to announce it's line of industrial igniters and flame rods.

Never before has Crown's quality and workmanship been so evident, as in our industrial line of igniters and flame rods. You can select from a wide variety of stocked items in this catalog or we can B.T.O. (build to order) against your submitted samples and/or drawings...your choice!

Our Auburn™ equivalent igniters match the original OEM critical specs from the seat of the gland nut to the tip of the center wire or from the end of the gland nut thread to the tip of the center wire, whichever is applicable. Our protruding insulator length or over-all length proves to be of no significance in the field application. All of our igniters are made of high quality heat resistant alloy (H.R.A.) center wires and grade L3 Steatite glazed insulators (except wherever noted). In high pressure applications center wires are cemented in place and Viton® O-rings are included inside the gland nut assemblies.

We look forward to serving all your industrial application needs.

Remember we're Crown Engineering Corporation...Your Single Source!

Visit us on The World Wide Web: www.crownengineering.com

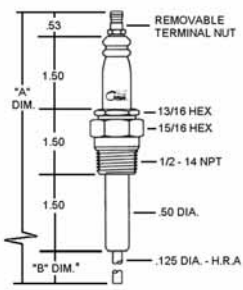

PART NUMBER	"A" DIM.	"B" DIM.
CA200	12.53 REF.	7.50
CA201	5.91 REF.	.85
CA202	23.03 REF.	18.00
CA203	29.03 REF.	24.00
CA204	41.03 REF.	36.00
CA205	53.03 REF.	48.00

*NOTE: Other tip lengths are available

Auburn Cross Ref. I-18 Series

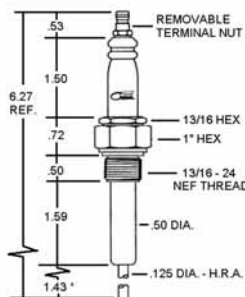

CA210

Auburn Cross Ref. I-18-14

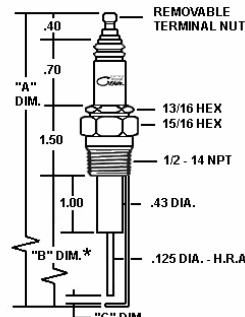

PART NUMBER	"A" DIM.	"B" DIM.	"C" DIM.
CA230	4.32	1.72	.09
CA231	6.35	3.75	.09
CA233	7.15	4.55	.12
CA235	7.72	5.12	.06

*NOTE: Other tip lengths are available

Auburn Cross Ref. CA230 = I-25 CA231 = I-25-3

Eclipse Cross Ref. CA233 = 17396 CA235 = 17652

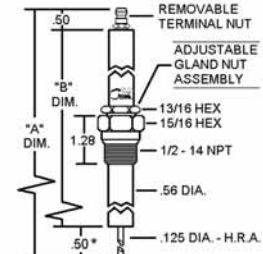

PART NUMBER	"A" DIM.	"B" DIM.
CA311	9.28	8.25
CA322	7.53	6.50

*NOTE: Other tip lengths are available

Auburn Cross Ref. IP-17-1 and IP-18-1

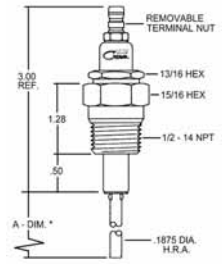

Flame Rods		
1/2 NPT MOUNTING TH'D	CATALOG NO.	A-DIM*
	CA390	6"
	CA391	12"
	CA392	18"
	CA393	24"

Auburn Cross Ref. FRS-2 Series

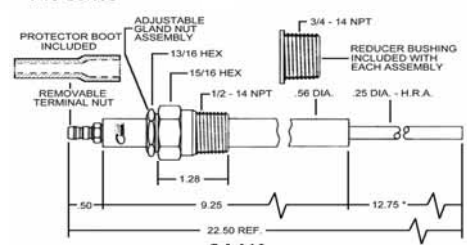

CA410

Auburn Cross Ref. FRS-3

95% Alumina Ceramic

95% Alumina Ceramic

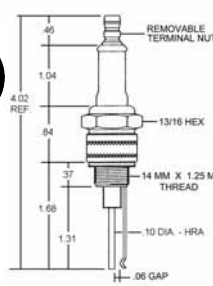

CA470 Auburn Cross Ref. I-3

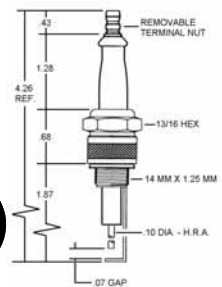

CA506 Auburn Cross Ref. I-31-1

There are many other styles to choose from that are not listed here!



ENGINEERING CORPORATION

Silicone Protector Boots and Accessories

Crown Part Number: 50740
Description: Straight silicone boot - Red
450°F Max. temperature rating

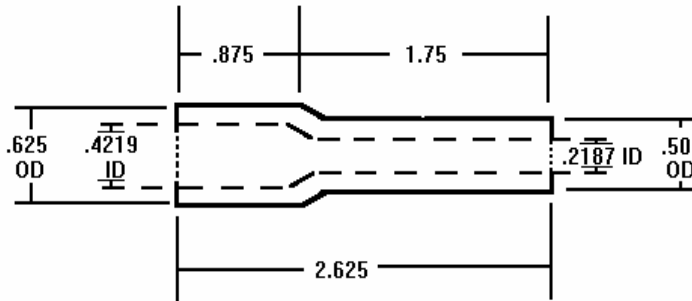

ALL DIMENSIONS ARE APPROXIMATE

Crown Part Number: 50741
Description: Right angle silicone boot - Black
450°F Max. temperature rating

ALL DIMENSIONS ARE APPROXIMATE

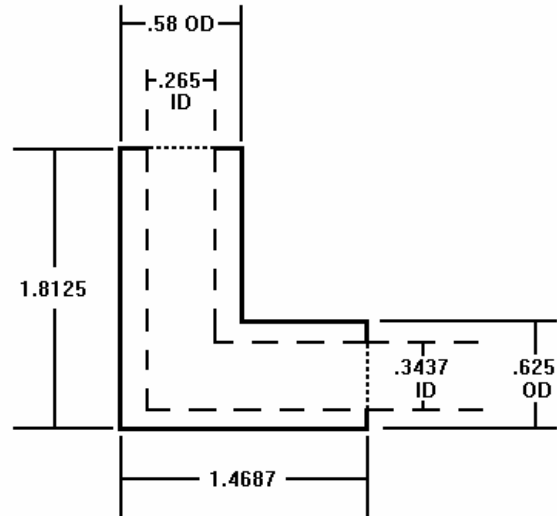

Crown Part Number: 50742
Description: Right angle silicone boot - Gray
550°F Max. temperature rating

ALL DIMENSIONS ARE APPROXIMATE

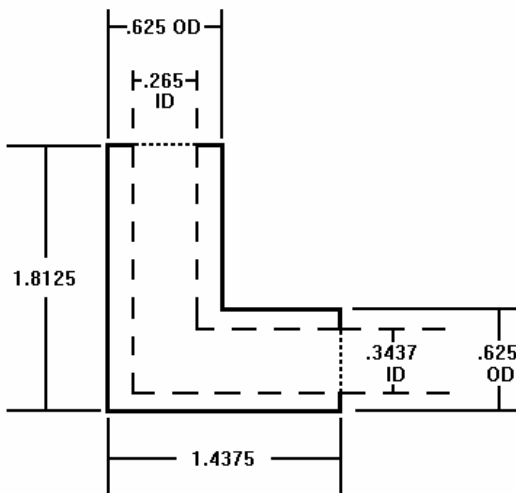

Gland Nut:

P/N: 45180, is for use with above shell bodies. Hex size is 13/16". Thread size is 13/16 - 24. Black Oxide finish.



Brass Bushing:

P/N: 45030, is used in conjunction with above gland nut (45180) and shell body below (45191) to create an adjustable mounting assembly for 9/16" Dia. insulators.

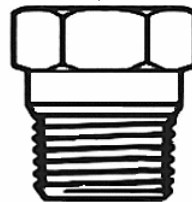

Shell Bodies:

P/N: 45190, is for use with 1/2" Dia. insulators. Hex size is 15/16". Thread size is 1/2 - 14 NPT. Black Oxide finish.

P/N: 45191, is for use with 9/16" Dia. insulators. Hex size is 15/16". Thread size is 1/2 - 14 NPT. Black Oxide finish.

P/N: 45197, is for use with 1/2" Dia. insulators. Hex size is 1". Thread size is 13/16 - 24 NEF. Black Oxide finish.

P/N: 45198, is for use with 9/16" Dia. insulators. Hex size is 1 1/8". Thread size is 3/4 - 14 NPT. Black Oxide finish.

We thank all of our customers for their faithful patronage and consumer confidence in the igniters that we manufacture for the industry. We look forward to servicing your igniter needs in this 21st century. Once again, with all sincerity...Thank You!

Manufactured and/or distributed by:

**Your
Single
Source!**



ENGINEERING CORPORATION

P.O. Box 846

Farmingdale, NJ 07727

Tel: (800) 631-2153

Fax: (732) 938-3969

www.crownengineering.com