

MARINE VALVES AND FITTINGS

Thru-Hull Connections and Components

THRU-HULL CONNECTIONS - BARBED

Recommended for use above the waterline; 85-5-5-5 bronze.

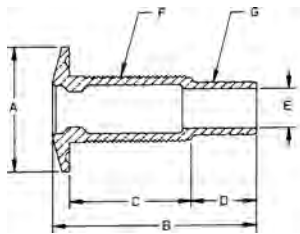

(Excludes 1/2", 3/4")



Part Number	Max. Hull	Dimensions (in.)					Pipe Size F	Hose Size G	WT/100*
		A	B	C	D	E			
65-**7-97	1.06	1.56	3.00	1.5	1.25	0.44	1/2" NPSM	0.63	28.5
65-**7-98	1.63	1.88	3.69	2.06	1.38	0.56	3/4" NPSM	0.75	40.5
65-**7-99	1.75	2.42	3.88	2.25	1.31	0.75	1" NPSM	1.00	74
65-**7-01	1.88	2.81	4.25	2.44	1.47	1.00	1 1/4" NPSM	1.25	106.5
65-**7-02	1.88	3.06	4.25	2.38	1.50	1.25	1 1/2" NPSM	1.50	123.5
65-**7-03	1.88	2.81	4.25	2.44	1.44	0.87	1 1/4" NPSM	1.13	104

** = Specify "BF" For Bronze Fitting Only. Specify "BN" For Bronze Fitting With Nut.

* = Weights are listed without nuts

Intake Strainer

ONE PIECE INTAKE STRAINER

Designed for long life, easy installation; 85-5-5-5 bronze.



Part Number	Max. Hull	Strainer Dim.	Dimensions (in.)						Pipe Size	WT/100*
			A	B	C	D	E	F		
65-**8-09	2.00	2.6 X 3.5	1.56	2.19	3.00	0.19	2.13	0.53	1/2" NPSM	68
65-**8-10	2.19	3 X 4	1.94	2.47	3.63	0.19	2.56	0.75	3/4" NPSM	93.4
65-**8-11	2.50	3 X 4	1.88	2.50	3.88	0.19	2.91	1.00	1" NPSM	104
65-**8-12	3.00	3 1/4" X 4 1/4"	1.75	2.81	4.50	0.19	3.50	1.25	1 1/4" NPSM	158

** = Specify "BF" For Bronze Fitting Only. Specify "BN" For Bronze Fitting With Nut.

* = Weights are listed without nuts

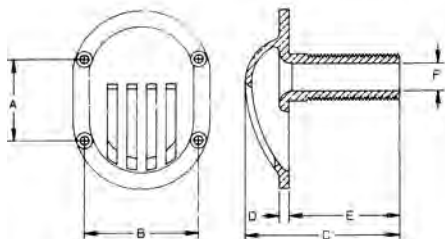

(Excludes 1/2", 3/4")