

Male Adapter

Small Diameter

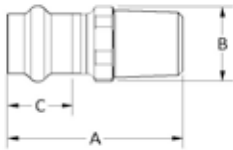

Large Diameter

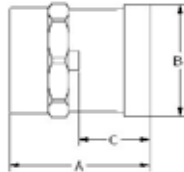

Reducing Adapter



Dimensions shown in inches

Item No.	Description	A	B	C	Height	Width	Depth
10075232	804 1/2 CxM ADAPT	2.03	0.95	0.85	0.95	2.03	0.95
10075238	804 3/4 CxM ADAPT	2.22	1.24	0.89	1.24	2.22	1.24
10075242	804 1 CxM ADAPT	2.46	1.50	0.97	1.50	2.46	1.50
10075248	804 1 1/4 CxM ADAPT	2.47	1.75	1.09	1.75	2.47	1.75
10075254	804 1 1/2 CxM ADAPT	2.86	2.13	1.31	2.13	2.86	2.13
10075256	804 2 CxM ADAPT	3.00	2.60	1.51	2.60	3.00	2.60
10061982	804 2 1/2 CxM ADAPT	4.11	3.16	1.90	3.16	4.11	3.16
10061987	804 3 CxM ADAPT	4.35	3.68	2.10	3.56	4.35	3.16
10061992	804 4 CxM ADAPT	5.43	4.70	2.50	4.70	5.43	3.16
Male Reducing Adapters							
10075230	804R 1/2x3/4 CxM ADAPT	1.89	0.95	0.85	0.95	1.89	0.95
10075234	804R 1/2x3/4 CxM ADAPT	2.08	1.03	0.85	1.03	2.08	1.03
10075236	804R 3/4x1/2 CxM ADAPT	2.28	1.24	0.89	1.24	2.28	1.24
10075237	804R 3/4x1 CxM ADAPT	2.56	1.50	0.89	1.50	2.56	1.50
10075240	804R 1x3/4 CxM ADAPT	2.32	1.50	0.97	1.50	2.32	1.50
10075244	804R 1x1 1/4 CxM ADAPT	2.49	1.71	0.97	1.71	2.49	1.71
10075246	804R 1 1/4x1 CxM ADAPT	2.61	1.75	1.09	1.75	2.61	1.75
10075250	804R 1 1/4x1 1/2 CxM ADAPT	2.70	1.90	1.09	1.90	2.70	1.90
10075252	804R 1 1/2x1 1/4 CxM ADAPT	2.77	2.12	1.31	2.12	2.77	2.12
10075253	804R 1 1/2x2 CxM ADAPT	2.77	2.59	1.31	2.59	2.77	2.59
10075257	804R 2x1 1/2 CxM ADAPT	3.04	2.58	1.51	2.58	3.04	2.58

Male Street Adapter

Small Diameter

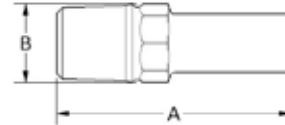

Reducing Adapter



Dimensions shown in inches

Item No.	Description	A	B	Height	Width	Depth
10075280	804-2 1/2 FTGxM ADAPT	2.38	0.84	0.84	2.38	0.84
10075286	804-2 3/4 FTGxM ADAPT	2.50	1.05	1.05	2.50	1.05
10075288	804-2 1 FTGxM ADAPT	2.89	1.31	1.31	2.89	1.31
10075290	804-2 1 1/4 FTGxM ADAPT	3.01	1.66	1.66	3.01	1.66
10075292	804-2 1 1/2 FTGxM ADAPT	3.29	1.90	1.90	3.29	1.90
10075294	804-2 2 FTGxM ADAPT	3.60	2.37	2.37	3.60	2.37
Male Reducing Street Adapters						
10075278	804-2 1/2x3/4 FTGxM ADAPT	2.14	0.68	0.68	2.14	0.68
10075282	804-2 1/2x3/4 FTGxM ADAPT	2.44	1.05	1.05	2.44	1.05
10075284	804-2 3/4x1/2 FTGxM ADAPT	2.43	0.98	0.98	2.43	0.98
10075289	804-2 1x3/4 FTGxM ADAPT	2.73	1.32	1.32	2.73	1.32

45° Elbow

Dimensions shown in inches

Item No.	Description	A	B	C	E	G	Height	Width	Depth
10075060	806 1/2 CxC 45 EL	2.28	1.57	0.85	1.18	1.09	1.57	2.28	0.95
10075062	806 3/4 CxC 45 EL	2.59	1.78	0.89	1.31	1.16	1.78	2.59	1.24
10075064	806 1 CxC 45 EL	3.01	2.13	0.97	1.50	1.38	2.13	3.01	1.50
10075090	806 1 1/4 CxC 45 EL	3.62	2.69	1.09	1.81	1.81	2.69	3.62	1.75
10075092	806 1 1/2 CxC 45 EL	4.20	3.17	1.31	2.09	2.11	3.17	4.20	2.11
10075094	806 2 CxC 45 EL	5.13	3.73	1.51	2.53	2.44	3.73	5.13	2.58
10062052	806 2 1/2 CxC 45 EL	5.85	4.65	1.90	2.81	3.13	4.65	5.85	3.16
10062057	806 3 CxC 45 EL	6.55	5.31	2.10	3.10	3.53	5.31	6.55	3.56
10062062	806 4 CxC 45 EL	7.92	6.61	2.50	3.78	4.26	6.61	7.92	4.70

Small Diameter

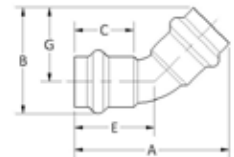

Large Diameter



For additional information, submittal sheets and manuals, visit www.apollovalves.com

